

FEATURES & BENEFITS

DIMENSIONS

Weight: 50 lbs Length: 30-1/4" Width: 28-7/16" Height: 25-3/16"

QUICK ASSEMBLY

Designed for fast setup in temporary or remote work environments.

MOBILITY

Equipped with four smooth-rolling casters—two locking—for easy relocation and stable use.

WATER CONTAINMENT

Collects water during activation or testing to simplify cleanup and reduce slip hazards.

COMPATIBILITY

Supports Haws 7500 and 7501 gravity-fed eyewash units, plus most comparable competitor models.

DURABLE CONSTRUCTION

1-1/4" diameter carbon steel frame and black powder coating for long-lasting strength.

OPTIONS

For more information, visit www.hawsc.com or call (888) 640-4297.



SPECIFICATIONS

The Haws model 9007 is a 1-1/4" diameter carbon steel tube framed cart designed to securely hold the 7500 and 7501 series portable eyewashes. The black powder coated frame can be easily moved on smooth-surface floors to locations where plumbed water is not available but demands an ANSI approved eyewash in accordance with OSHA. The eyewash is attached to the cart with the supplied stainless steel bracket. This stand can be used with most competitors portable gravity fed units. Includes wrenches for assembly, and 4 casters (two of which are locking) to keep the unit in place.

APPLICATIONS

The Haws Model 9007 portable eyewash cart is designed for deployment in environments where plumbed water is unavailable but ANSI-compliant emergency eyewash access is required. Typical applications include industrial facilities, construction sites, remote field operations, maintenance areas, and temporary work zones. Its durable carbon steel frame and mobile design allow for reliable placement and relocation in demanding settings, supporting both Haws 7500/7501 series units and compatible portable gravity fed eyewashes from other manufacturers.

NOTES:

1. HOLD ROUGH-IN DIMENSIONS $\pm 1/4"$ (6.4mm).
2. WHEN INSTALLING THIS UNIT, LOCAL, STATE, OR FEDERAL CODES SHOULD BE ADHERED TO. FOR INSTALLATION HEIGHTS OTHER THAN SHOWN, DIMENSIONS MARKED (*) MUST BE ADJUSTED ACCORDINGLY. INSTALL A TRAP IN THE WASTE LINE AND A SCREWDRIVER STOP IN THE SUPPLY LINE IF REQUIRED.
3. TO COMPLY WITH ANSI Z358.1-2014 FOR EMERGENCY EYEWASH AND SHOWER EQUIPMENT:
 - UNIT SHALL BE INSTALLED IN ACCORDANCE WITH MANUFACTURER'S INSTRUCTIONS AND ACCEPTABLE PLUMBING PRACTICES.
 - EYEWASH STREAMS SHALL BE POSITIONED SUCH THAT STREAMS ARE 15.3 CM (6 IN.) MINIMUM FROM THE WALL OR NEAREST OBSTRUCTION AND MEET ANSI GAUGE REQUIREMENTS BETWEEN 83.8 & 134.6 CM (33-53 IN) ABOVE FLOOR.

(NOTES CONTINUED ON NEXT SHEET)

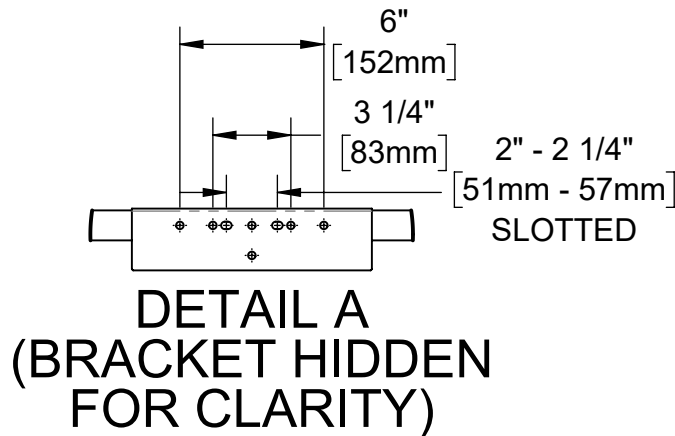

MODEL 9007
PORTABLE
EYEWASH CART
WITH TANK

TANK DRAIN
(1" BARB OR NPT)

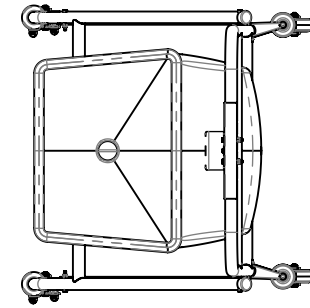
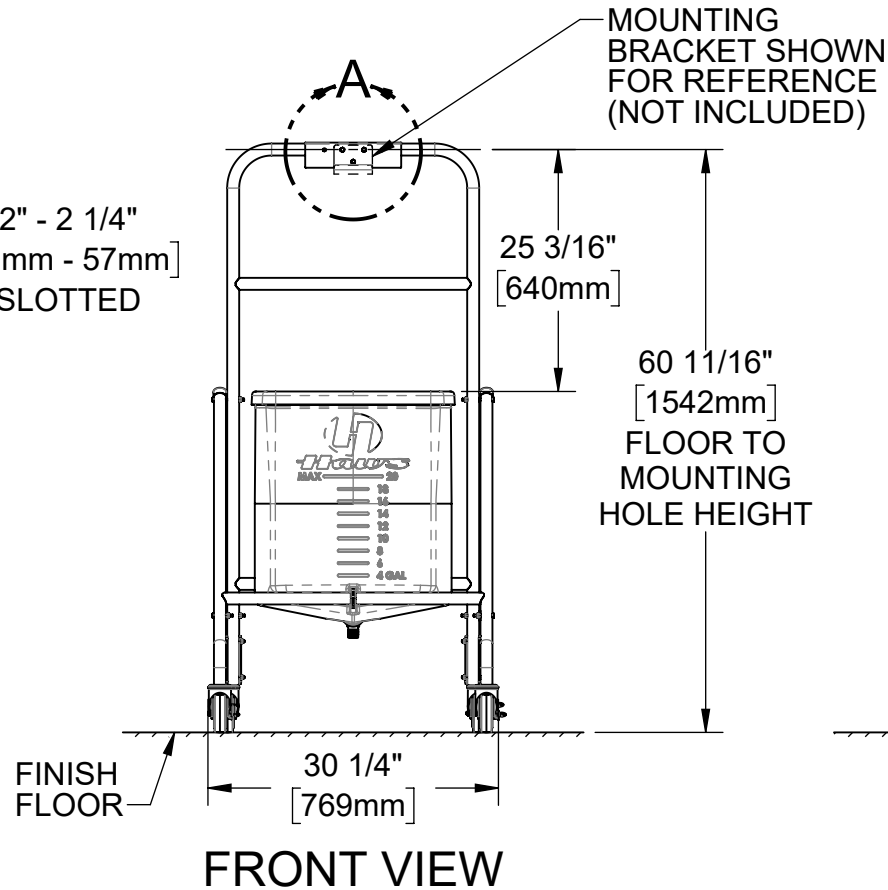

TOP VIEW

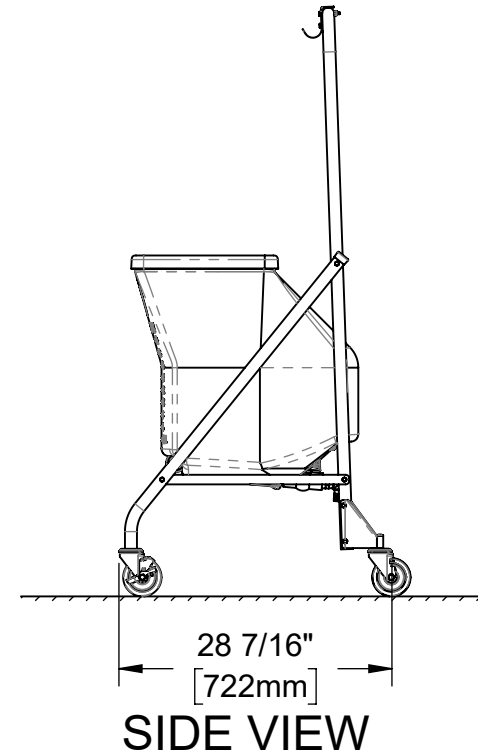

				1455 KLEPPE LANE SPARKS, NEVADA 89431 (775) 359-4712 FAX (775) 359-7424 E-MAIL: HAWS@HAWSO.COM WEBSITE: WWW.HAWSO.COM			
ECN: 6210	REV. ECN: 6210	BY: JU	MODEL(S)	9007, PORTABLE EYEWASH CART WITH TANK			PART NUMBER
DRAWN: JU	DATE: 11/21/24	CHKD: JU					0510002289.D
APPROVED: DN	DATE: 05/08/25	SCALE: 1:20	DRAWING TYPE: INSTALLATION	SIZE: A			REVISION
							1
							SHEET 1 OF 4

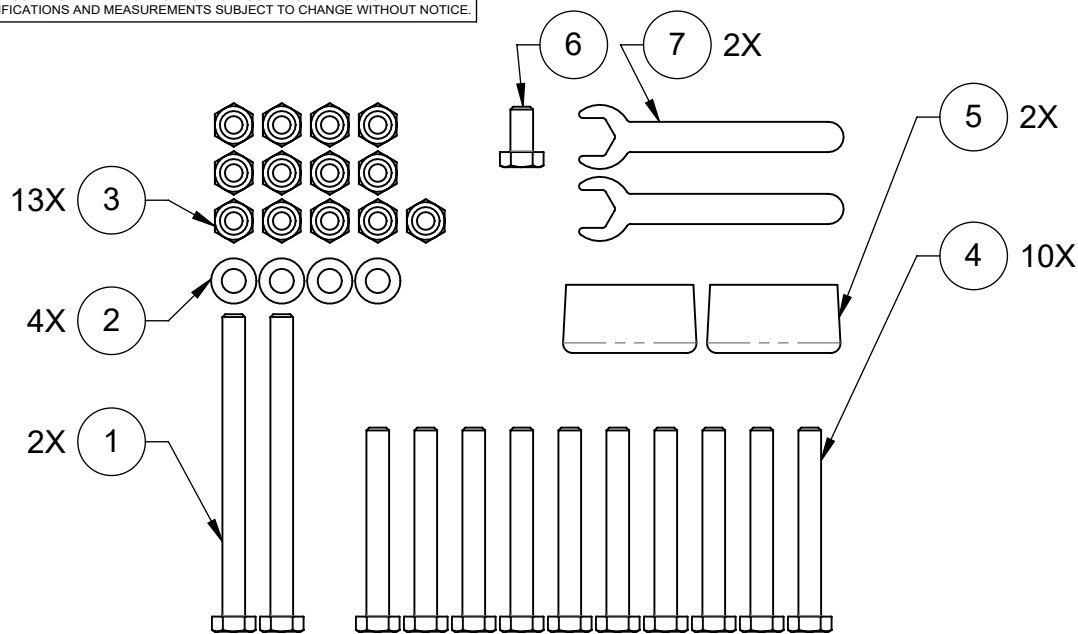

INCLUDED HARDWARE

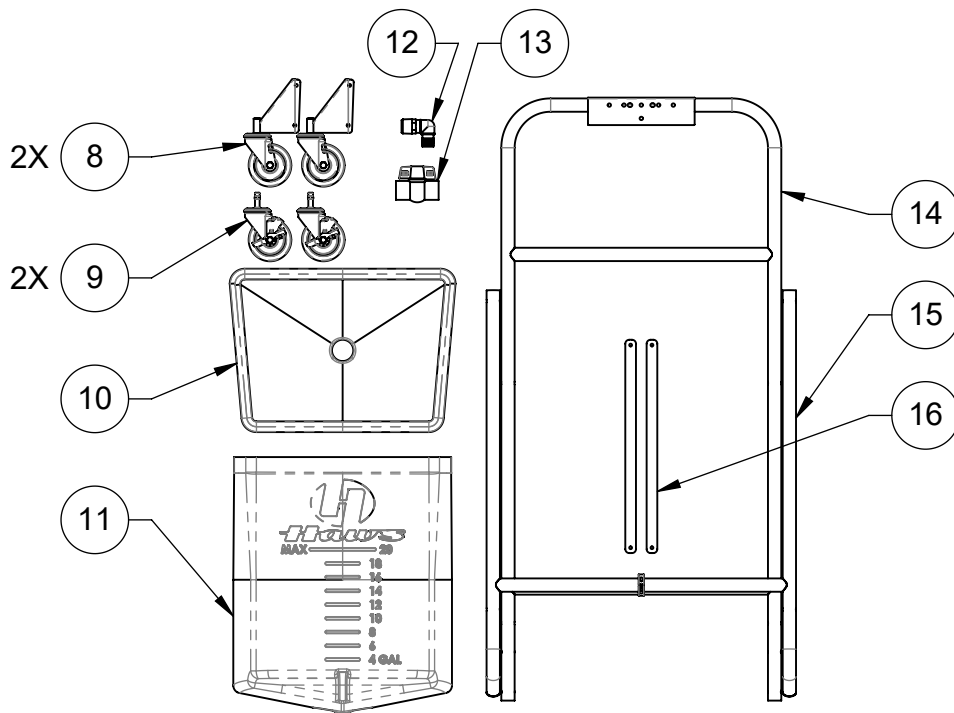

INCLUDED DRAIN AND FRAME COMPONENTS

16	BRACKET, LOWER BRACE	2
15	FRAME, TUBULAR, FRONT SUPPORT	1
14	FRAME, TUBULAR, VERTICAL	1
13	VALVE, 1" NPT	1
12	ELBOW, 1" NPT X 1" BARB	1
11	TANK, 20GAL	1
10	TANK COVER	1
9	CASTER, FRONT, WITH BRAKE	2
8	CASTER, REAR, WITH BRACKET	2
7	WRENCH, OPEN END, 10MM	2
6	SCREW, M6 X 12MM, HEX	1
5	CAP, SLIP ON, PLASTIC	2
4	SCREW, M6 X 50MM, HEX	10
3	NUT, M6, W/ NYLON INSERT	13
2	WASHER, M6	4
1	SCREW, M6 X 80MM, HEX	2
ITEM	DESCRIPTION	QTY
INCLUDED PARTS		

NOTES CONTINUED:

4. TORQUE ALL NUTS AND BOLTS TO 26.5 LB-IN [3 Nm]. OVER-TORQUEING HARDWARE MAY DAMAGE STEEL TUBING.



1455 KLEPPE LANE
SPARKS, NEVADA 89431
(775) 359-4712 FAX (775) 359-7424
E-MAIL: HAWS@HAWS.CO.COM
WEBSITE: WWW.HAWS.CO.COM

ECN: 6210	REV. ECN: 6210	BY: JU	MODEL(S) 9007, PORTABLE EYEWASH CART WITH TANK	PART NUMBER 0510002289.D
DRAWN: JU	DATE: 11/21/24	CHKD: JU		REVISION 1
APPROVED: DN	DATE: 05/08/25	SCALE: 1:18	DRAWING TYPE: INSTALLATION	SHEET 2 OF 4

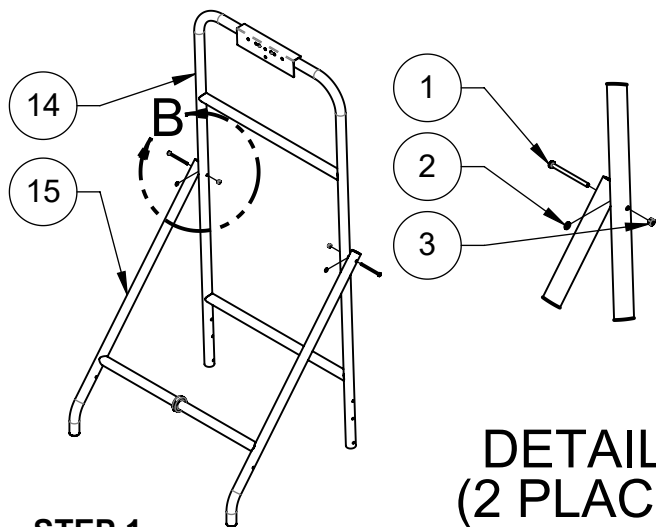

**DETAIL B
(2 PLACES)**

STEP 1

CONNECT THE TUBULAR FRAMES USING LONG SCREWS (ITEM 1), WASHERS (ITEM 2), AND LOCK NUTS (ITEM 3). WASHERS (ITEM 2) ARE INSTALLED BETWEEN THE FRAME PIECES.

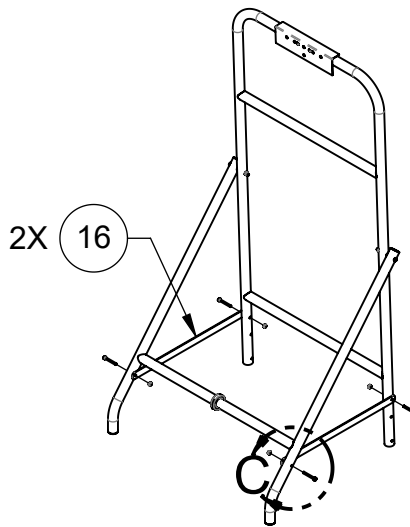

**DETAIL C
(4 PLACES)**

STEP 2

INSTALL THE TWO FLAT BRACKETS AS SHOWN, USING MEDIUM SCREWS (ITEM 4) AND LOCK NUTS (ITEM 3).

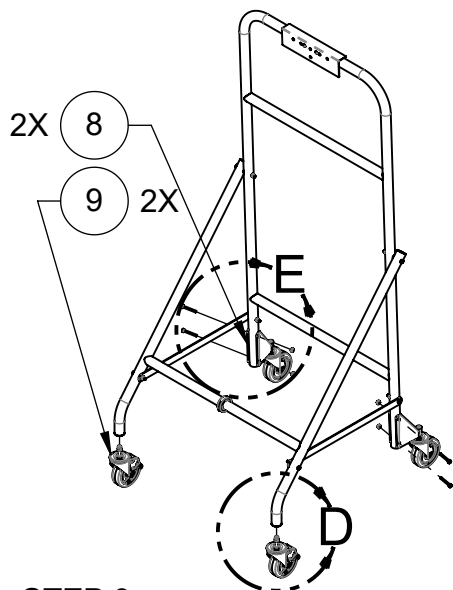

**DETAIL D
(2 PLACES)**

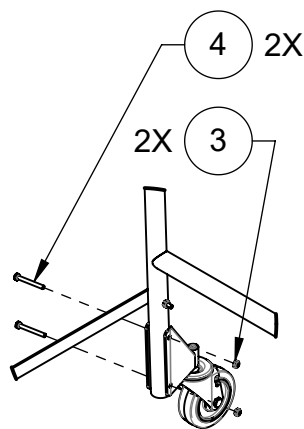

**DETAIL E
(2 PLACES)**

STEP 3

ATTACH THE FRONT CASTERS WITH BRAKES (ITEM 9) BY INSERTING THEM FULLY INTO THE BOTTOM OF THE FRONT LEGS OF THE FRAME. A RUBBER Mallet AND/OR BLOCK OF WOOD MAY BE USED TO ASSIST WITH INSTALLATION. ATTACH THE REAR CASTERS (ITEM 8) USING MEDIUM SCREWS (ITEM 4) AND LOCK NUTS (ITEM 3).

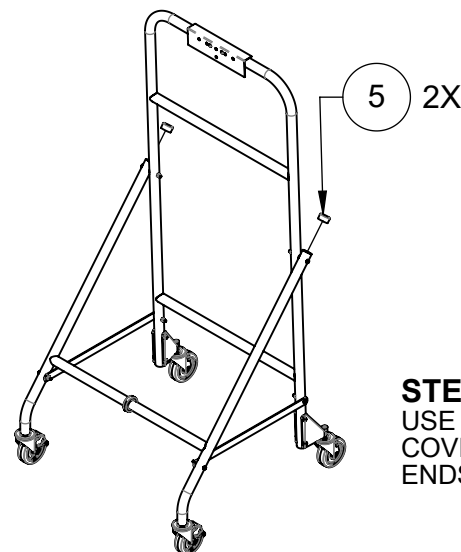

STEP 4

USE THE CAPS (ITEM 5) TO COVER THE OPEN TUBE ENDS.



1455 KLEPPE LANE
SPARKS, NEVADA 89431
(775) 359-4712 FAX (775) 359-7424
E-MAIL: HAWS@HAWS.CO.COM
WEBSITE: WWW.HAWS.CO.COM

ECN: 6210	REV. ECN: 6210	BY: JU	MODEL(S)	PART NUMBER
DRAWN: JU	DATE: 11/21/24	CHKD: JU	9007, PORTABLE EYEWASH CART WITH TANK	0510002289.D
APPROVED: DN	DATE: 05/08/25	SCALE: 1:24	DRAWING TYPE: INSTALLATION	REVISION 1
			SIZE: A	SHEET 3 OF 4

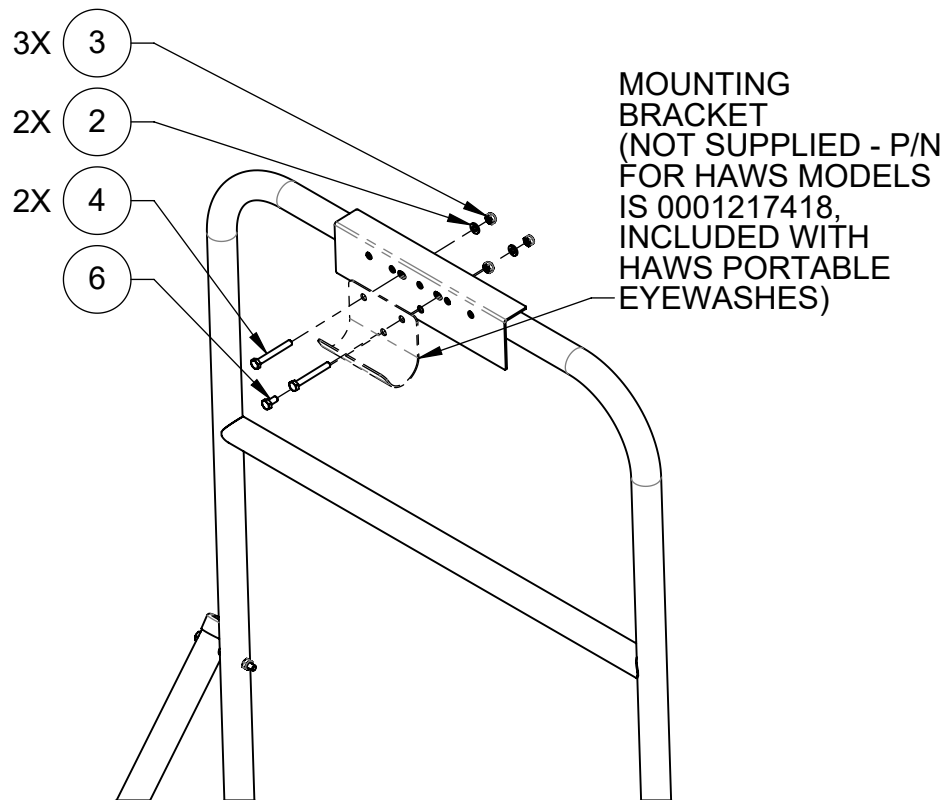

STEP 5
INSTALL THE PORTABLE EYEWASH MOUNTING BRACKET (NOT INCLUDED) USING MEDIUM SCREWS (ITEM 4), SHORT SCREW (ITEM 6), WASHERS (ITEM 2), AND NUTS (ITEM 3) AS NEEDED.

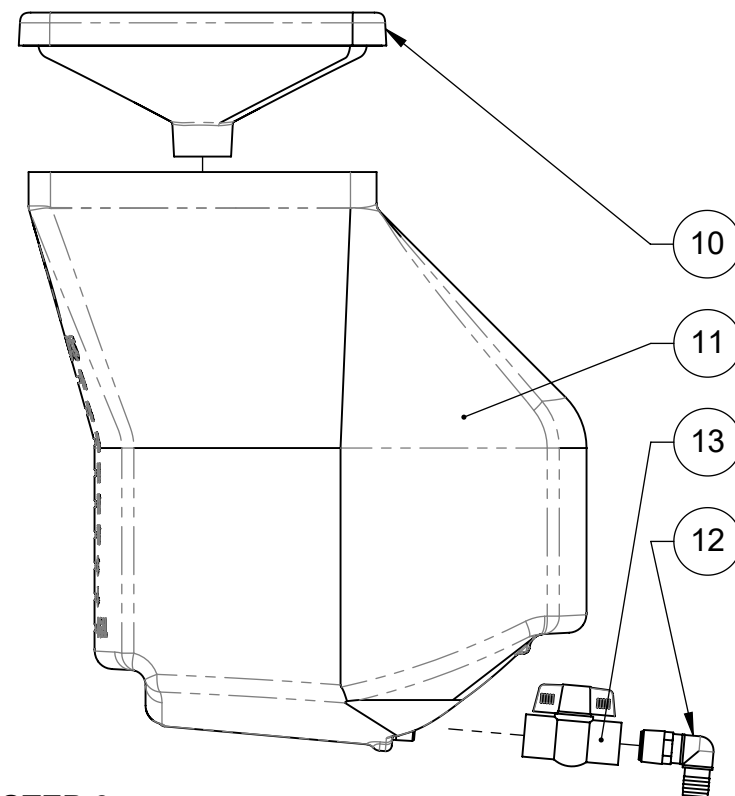

STEP 6
THREAD THE BALL VALVE (ITEM 13) ONTO THE PRE-INSTALLED NIPPLE LOCATED AT THE DRAIN OF THE TANK (ITEM 11). VERIFY THE VALVE AND NIPPLE ARE TIGHT ENOUGH TO PREVENT LEAKS.

THREAD THE BARBED ELBOW (ITEM 12) INTO THE BALL VALVE (ITEM 13) SUCH THAT IT IS TIGHT AND POINTING IN A DOWNWARD DIRECTION. PLACE THE TANK LID (ITEM 10) ON TOP OF THE TANK, AND CENTER THE TANK ASSEMBLY ONTO THE FRAME OF THE MODEL 9007 CART.



1455 KLEPPE LANE
SPARKS, NEVADA 89431
(775) 359-4712 FAX (775) 359-7424
E-MAIL: HAWS@HAWSO.COM
WEBSITE: WWW.HAWSO.COM

ECN: 6210	REV. ECN: 6210	BY: JU	MODEL(S) 9007, PORTABLE EYEWASH CART WITH TANK	PART NUMBER 0510002289.D
DRAWN: JU	DATE: 11/21/24	CHKD: JU		REVISION 1
APPROVED: DN	DATE: 05/08/25	SCALE: 1:8	DRAWING TYPE: INSTALLATION	SHEET 4 OF 4