

Features & Benefits

Compatible Models

- Haws 1210 & 1211

Construction

- 16 Gauge Satin Finished Stainless Steel

Dimensions

- 21 9/16" w x 46 3/8" h

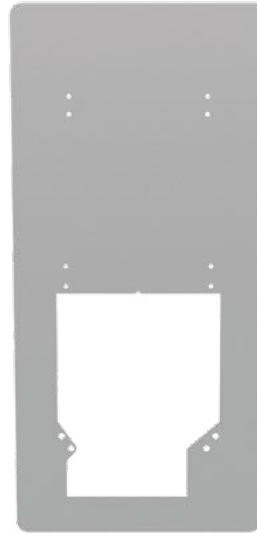

Unit Not Included

Specifications

Model BP1210-11 back panel is made of durable stainless steel for installation behind an electric water cooler. These panels have ample reveals around the installed cooler to cover previous installations, wall imperfections, and also provides splash protection for the mounting services. Designed to be used in either new or retrofit installations, the EWC Back Panels are designed to fit behind an EWC unit and provide clearances for the water, electrical and drain locations.

NOTES:

1. HOLD ROUGH-IN DIMENSIONS $\pm 1/4"$ (6.4mm).
2. WHEN INSTALLING THIS UNIT, LOCAL, STATE, OR FEDERAL CODES SHOULD BE ADHERED TO. FOR INSTALLATION HEIGHTS OTHER THAN SHOWN, DIMENSIONS MARKED (*) MUST BE ADJUSTED ACCORDINGLY. INSTALL A TRAP IN THE WASTE LINE AND A SCREWDRIVER STOP IN THE SUPPLY LINE IF REQUIRED.

(NOTES CONTINUED ON NEXT SHEET)

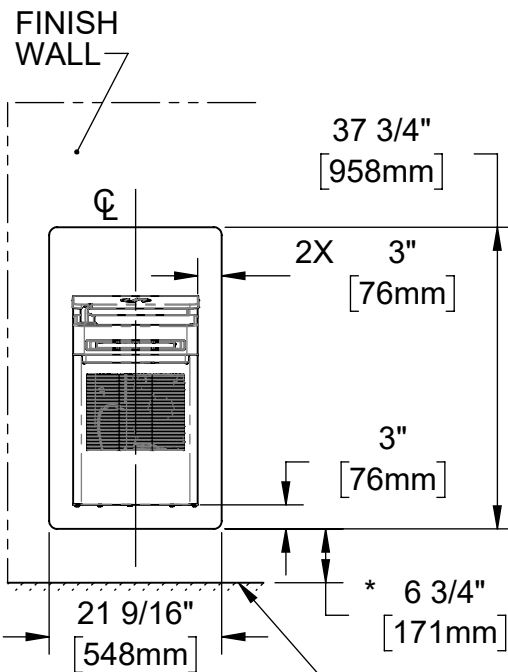

BP1201
FOR USE WITH
ALL 1201 MODELS

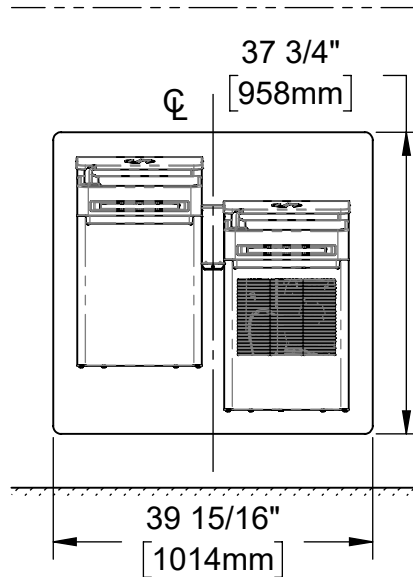

BP1202
FOR USE WITH
ALL 1202 MODELS

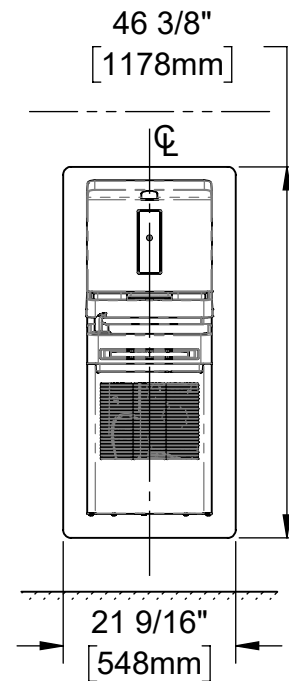

BP1210-11
(1211S SHOWN
FOR REFERENCE)
FOR USE WITH ALL 1210
AND 1211 MODELS

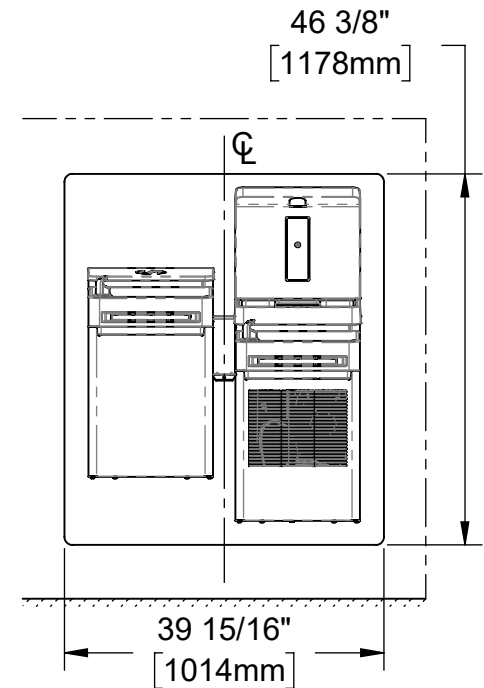

BP1212
FOR USE WITH
ALL 1212 MODELS



1455 KLEPPE LANE
SPARKS, NEVADA 89431
(775) 359-4712 FAX (775) 359-7424
E-MAIL: HAWS@HAWSO.COM
WEBSITE: WWW.HAWSO.COM

ECN: 6068	REV. ECN: 6068	BY: JU	MODEL(S) BP12XX, INSTALL	PART NUMBER 0510002301
DRAWN: JU	DATE: 03/11/25	CHKD: JU		REVISION 1
APPROVED: DHP	DATE: 04/25/25	SCALE: 1:24	DRAWING TYPE: INSTALLATION	SIZE: A
				SHEET 1 OF 2

NOTES CONTINUED:

- ADHESIVE OR STRUCTURAL SCREWS MAY BE USED TO SECURE THE CORNERS OF THE BACK PANEL FOR VANDAL RESISTANCE.

BP1212
SHOWN FOR
REFERENCE

TEMPORARY
FASTENERS TO
ASSIST WITH
INSTALLATION

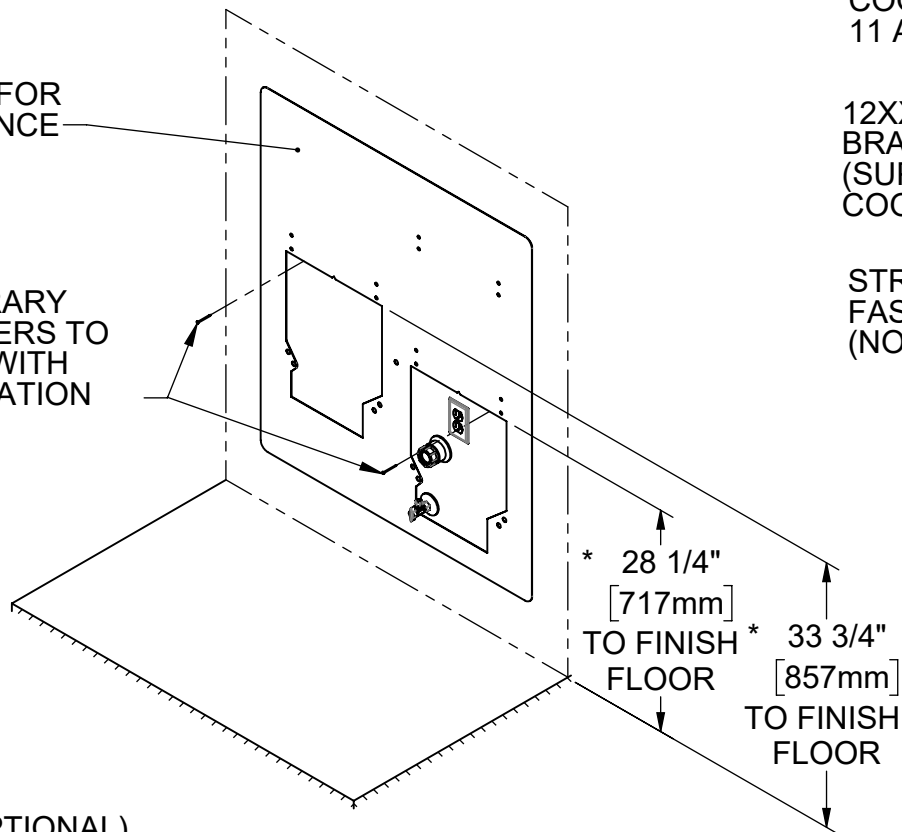

STEP 1 (OPTIONAL)

INSTALL TWO TEMPORARY FASTENERS IN THE FINISH WALL AND HANG THE BACK PANEL ON THOSE FASTENERS. MAKE ANY ADJUSTMENTS NECESSARY SO THAT THE BACK PANEL IS LEVEL AND AT THE CORRECT HEIGHT AND HORIZONTAL LOCATION ON THE WALL.

* DIMENSIONS SHOWN ARE FOR ADULT ADA, REFER TO YOUR ELECTRIC WATER COOLER INSTALLATION INSTRUCTIONS FOR ADDITIONAL INSTALLATION HEIGHTS.

BOTTLE FILLER WALL
BRACKET
(SUPPLIED WITH WATER
COOLER PRODUCT, BP1210-
11 AND BP1212 ONLY)

12XX HANGER
BRACKET(S)
(SUPPLIED WITH WATER
COOLER PRODUCT)

STRUCTURAL
FASTENERS
(NOT SUPPLIED)

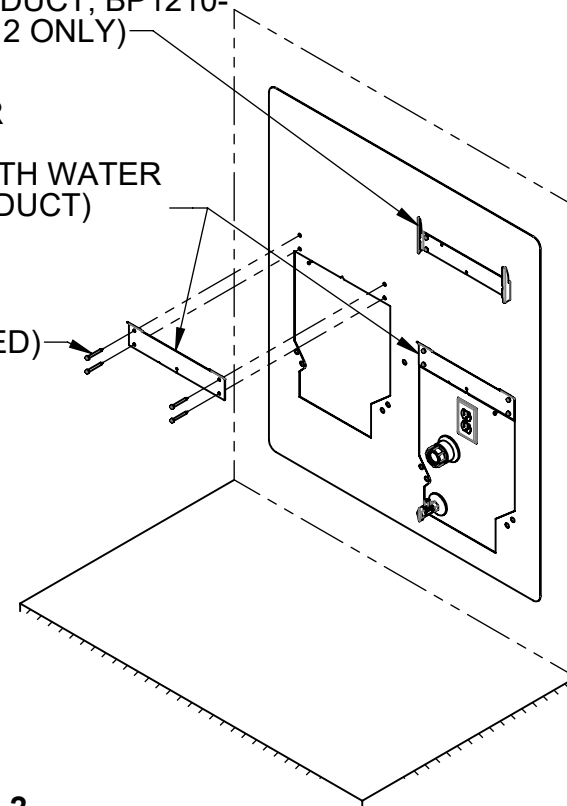

STEP 2

INSTALL THE 12XX HANGER BRACKET(S) AND BOTTLE FILLER BRACKET (BP1201-11 AND BP1212 ONLY) AS SHOWN IN THE INSTALLATION INSTRUCTIONS OF YOUR ELECTRIC WATER COOLER.

REMOVE THE TEMPORARY FASTENERS USED TO HANG THE BACK PANEL, AND FOLLOW THE INSTALLATION INSTRUCTIONS OF YOUR ELECTRIC WATER COOLER TO COMPLETE INSTALLATION.



1455 KLEPPE LANE
SPARKS, NEVADA 89431
(775) 359-4712 FAX (775) 359-7424
E-MAIL: HAWS@HAWS.CO.COM
WEBSITE: WWW.HAWS.CO.COM

ECN: 6068	REV. ECN: 6068	BY: JU	MODEL(S) BP12XX, INSTALL	PART NUMBER 0510002301
DRAWN: JU	DATE: 03/11/25	CHKD: JU		REVISION 1
APPROVED: DHP	DATE: 04/25/25	SCALE: 1:20	DRAWING TYPE: INSTALLATION	SIZE: A SHEET 2 OF 2