

NOTES:

1. HOLD ROUGH-IN DIMENSIONS $\pm 1/4"$ (6.4mm).
2. WHEN INSTALLING THIS UNIT, LOCAL, STATE, OR FEDERAL CODES SHOULD BE ADHERED TO. FOR INSTALLATION HEIGHTS OTHER THAN SHOWN, DIMENSIONS MARKED (*) MUST BE ADJUSTED ACCORDINGLY. INSTALL A TRAP IN THE WASTE LINE AND A SCREWDRIVER STOP IN THE SUPPLY LINE IF REQUIRED.
3. TO COMPLY WITH ANSI Z358.1-2014 FOR EMERGENCY EYEWASH AND SHOWER EQUIPMENT:
 - UNIT SHALL BE INSTALLED IN ACCORDANCE WITH MANUFACTURER'S INSTRUCTIONS AND ACCEPTABLE PLUMBING PRACTICES.
 - EYEWASH STREAMS SHALL BE POSITIONED SUCH THAT STREAMS ARE 15.3 CM (6 IN.) MINIMUM FROM THE WALL OR NEAREST OBSTRUCTION AND MEET ANSI GAUGE REQUIREMENTS BETWEEN 83.8 & 134.6 CM (33-53 IN) ABOVE FLOOR.

(NOTES CONTINUED ON NEXT SHEET)

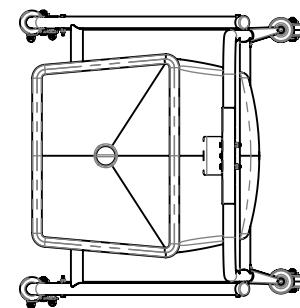

TOP VIEW

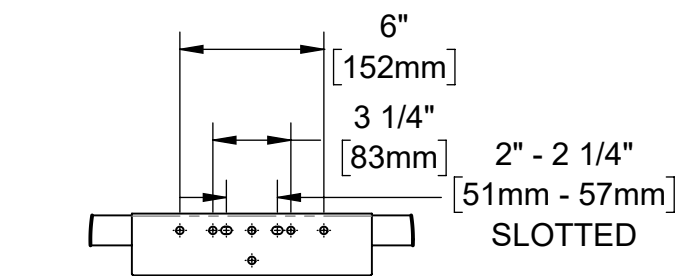

DETAIL A
(BRACKET HIDDEN FOR CLARITY)



MODEL 9007
PORTABLE
EYEWASH CART
WITH TANK

TANK DRAIN
(1" BARB OR NPT)

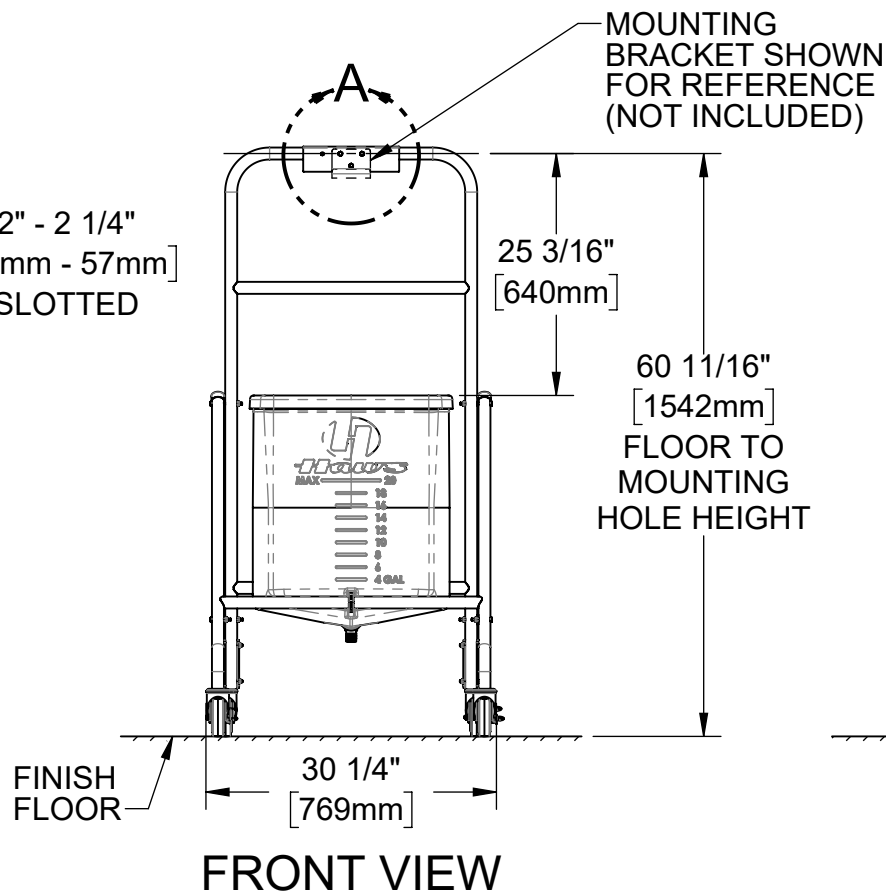

FRONT VIEW

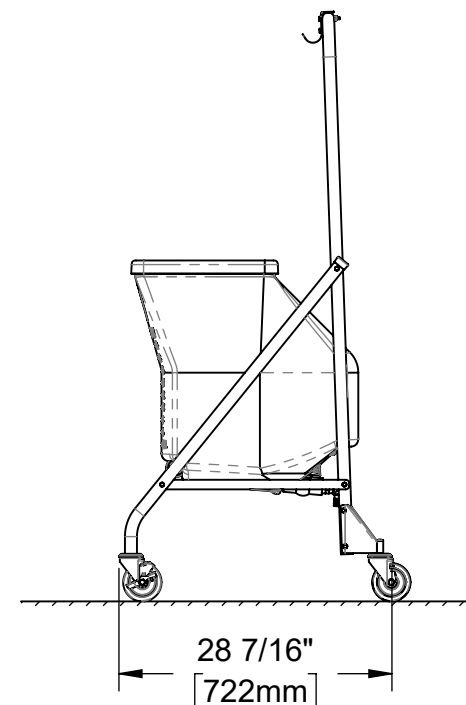

SIDE VIEW

| | | | | | | | |
|---|----------------|-------------|---|---|--------------|--|--|
|  | | | | 1455 KLEPPE LANE SPARKS, NEVADA 89431 (775) 359-4712 FAX (775) 359-7424 E-MAIL: HAWS@HAWSO.COM WEBSITE: WWW.HAWSO.COM | | | |
| ECN: 6210 | REV. ECN: 6210 | BY: JU | MODEL(S): 9007, PORTABLE EYEWASH CART WITH TANK | PART NUMBER: 0510002289.D | | | |
| DRAWN: JU | DATE: 11/21/24 | CHKD: JU | | REVISION: 1 | | | |
| APPROVED: DN | DATE: 05/08/25 | SCALE: 1:20 | DRAWING TYPE: INSTALLATION | SIZE: A | SHEET 1 OF 4 | | |

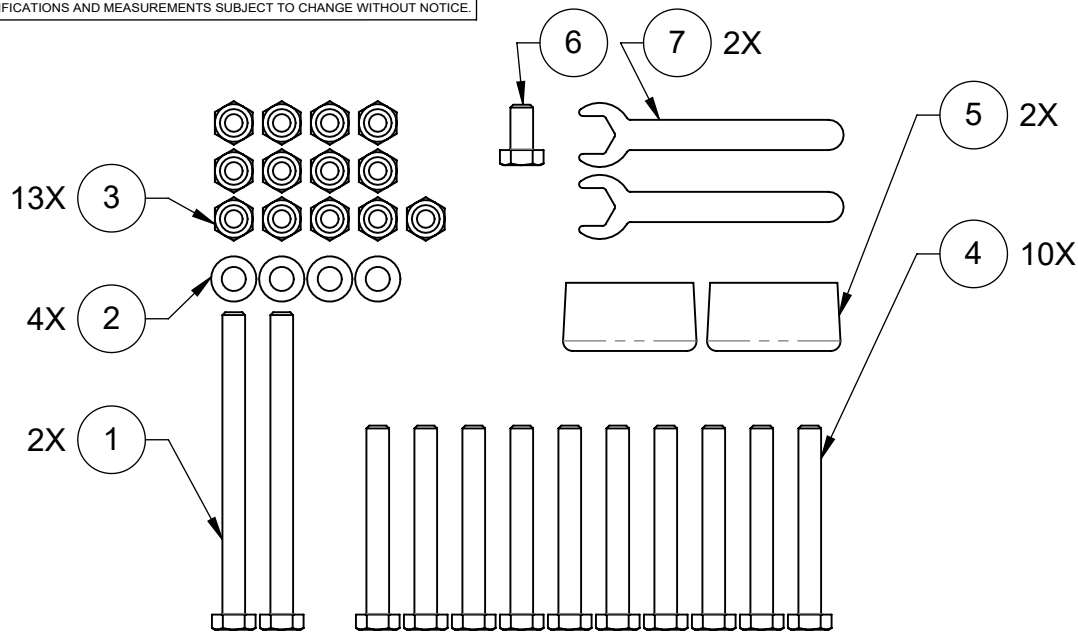

INCLUDED HARDWARE

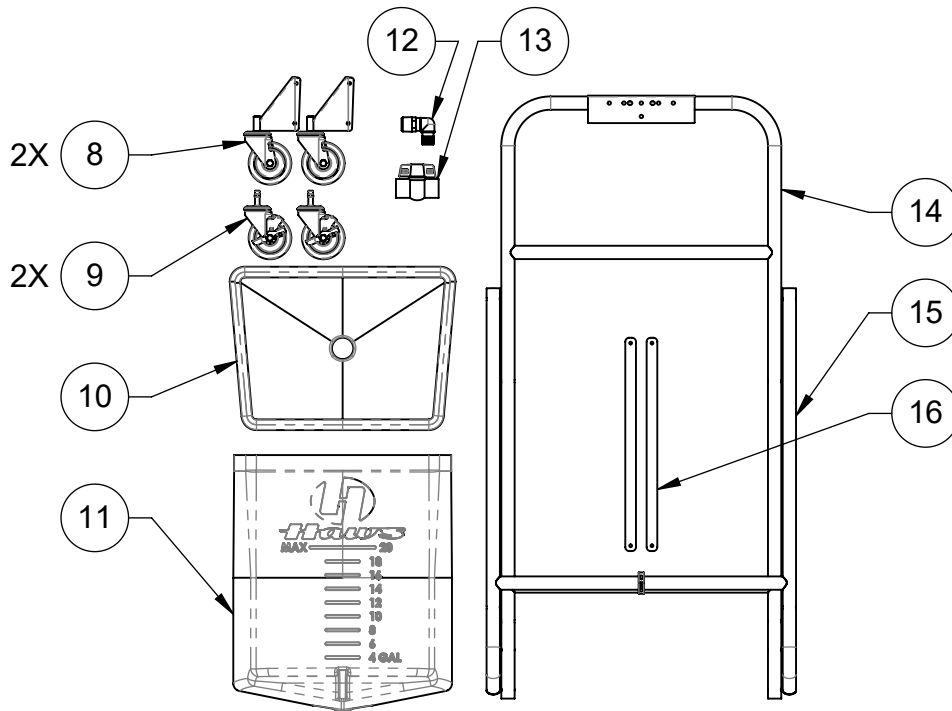

INCLUDED DRAIN AND FRAME COMPONENTS

| | | |
|----------------|-------------------------------|-----|
| 16 | BRACKET, LOWER BRACE | 2 |
| 15 | FRAME, TUBULAR, FRONT SUPPORT | 1 |
| 14 | FRAME, TUBULAR, VERTICAL | 1 |
| 13 | VALVE, 1" NPT | 1 |
| 12 | ELBOW, 1" NPT X 1" BARB | 1 |
| 11 | TANK, 20GAL | 1 |
| 10 | TANK COVER | 1 |
| 9 | CASTER, FRONT, WITH BRAKE | 2 |
| 8 | CASTER, REAR, WITH BRACKET | 2 |
| 7 | WRENCH, OPEN END, 10MM | 2 |
| 6 | SCREW, M6 X 12MM, HEX | 1 |
| 5 | CAP, SLIP ON, PLASTIC | 2 |
| 4 | SCREW, M6 X 50MM, HEX | 10 |
| 3 | NUT, M6, W/ NYLON INSERT | 13 |
| 2 | WASHER, M6 | 4 |
| 1 | SCREW, M6 X 80MM, HEX | 2 |
| ITEM | DESCRIPTION | QTY |
| INCLUDED PARTS | | |

NOTES CONTINUED:

4. TORQUE ALL NUTS AND BOLTS TO 26.5 LB-IN [3 Nm]. OVER-TORQUEING HARDWARE MAY DAMAGE STEEL TUBING.

| | | | |
|---|----------------|-------------|--|
| 1455 KLEPPE LANE SPARKS, NEVADA 89431 (775) 359-4712 FAX (775) 359-7424 E-MAIL: HAWS@HAWS.CO.COM WEBSITE: WWW.HAWS.CO.COM | | | |
| ECN: 6210 | REV. ECN: 6210 | BY: JU | MODEL(S) 9007, PORTABLE EYEWASH CART WITH TANK |
| DRAWN: JU | DATE: 11/21/24 | CHKD: JU | PART NUMBER 0510002289.D |
| APPROVED: DN | DATE: 05/08/25 | SCALE: 1:18 | REVISION 1 |
| DRAWING TYPE: INSTALLATION | | SIZE: A | SHEET 2 OF 4 |

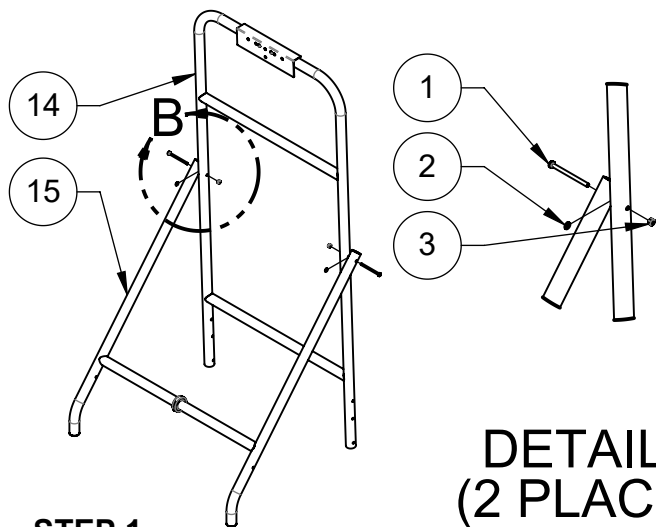

**DETAIL B
(2 PLACES)**

STEP 1

CONNECT THE TUBULAR FRAMES USING LONG SCREWS (ITEM 1), WASHERS (ITEM 2), AND LOCK NUTS (ITEM 3). WASHERS (ITEM 2) ARE INSTALLED BETWEEN THE FRAME PIECES.

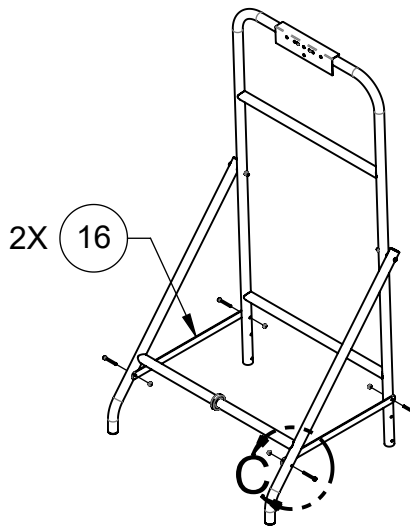

**DETAIL C
(4 PLACES)**

STEP 2

INSTALL THE TWO FLAT BRACKETS AS SHOWN, USING MEDIUM SCREWS (ITEM 4) AND LOCK NUTS (ITEM 3).

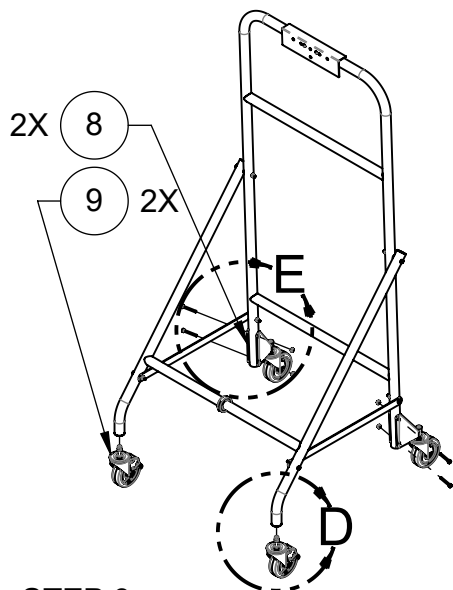

**DETAIL D
(2 PLACES)**

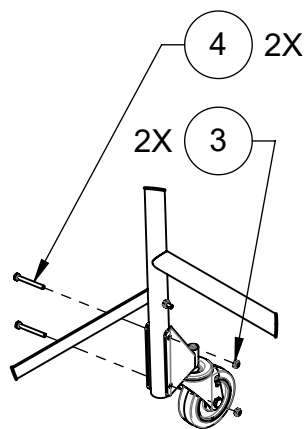

**DETAIL E
(2 PLACES)**

STEP 3

ATTACH THE FRONT CASTERS WITH BRAKES (ITEM 9) BY INSERTING THEM FULLY INTO THE BOTTOM OF THE FRONT LEGS OF THE FRAME. A RUBBER Mallet AND/OR BLOCK OF WOOD MAY BE USED TO ASSIST WITH INSTALLATION. ATTACH THE REAR CASTERS (ITEM 8) USING MEDIUM SCREWS (ITEM 4) AND LOCK NUTS (ITEM 3).

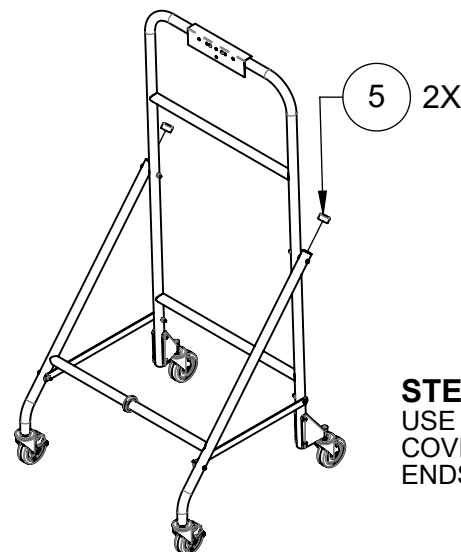

STEP 4

USE THE CAPS (ITEM 5) TO COVER THE OPEN TUBE ENDS.



1455 KLEPPE LANE
SPARKS, NEVADA 89431
(775) 359-4712 FAX (775) 359-7424
E-MAIL: HAWS@HAWS.CO.COM
WEBSITE: WWW.HAWS.CO.COM

| | | | | |
|--------------|----------------|-------------|---------------------------------------|--------------|
| ECN: 6210 | REV. ECN: 6210 | BY: JU | MODEL(S) | PART NUMBER |
| DRAWN: JU | DATE: 11/21/24 | CHKD: JU | 9007, PORTABLE EYEWASH CART WITH TANK | 0510002289.D |
| APPROVED: DN | DATE: 05/08/25 | SCALE: 1:24 | DRAWING TYPE: INSTALLATION | REVISION 1 |
| | | | SIZE: A | SHEET 3 OF 4 |

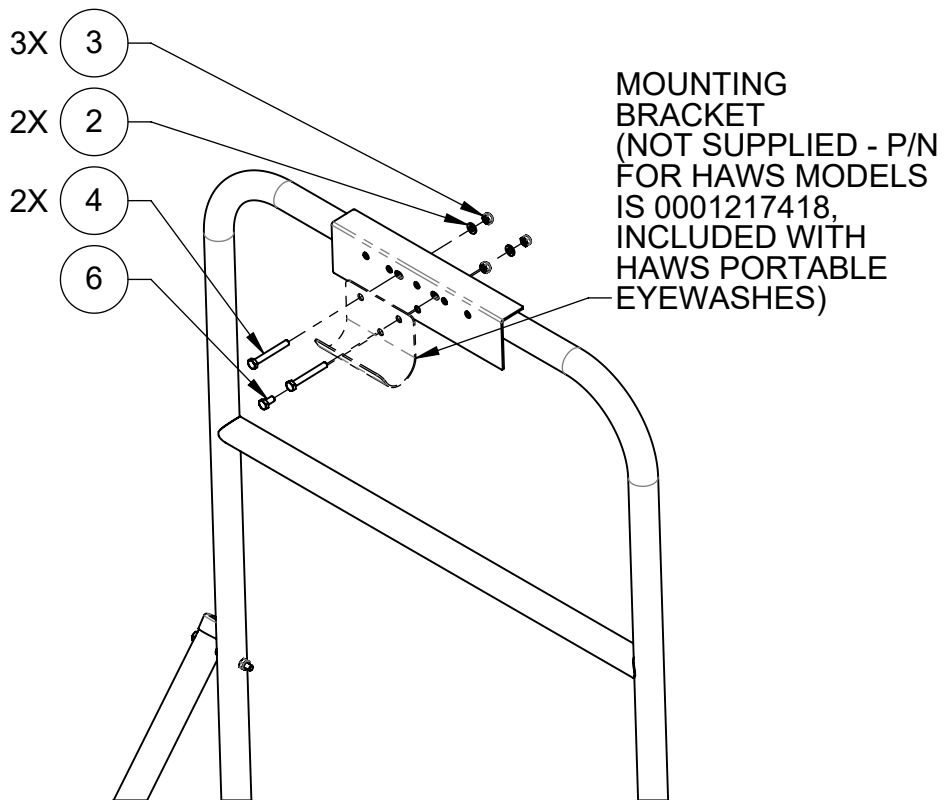

STEP 5
INSTALL THE PORTABLE EYEWASH MOUNTING BRACKET (NOT INCLUDED) USING MEDIUM SCREWS (ITEM 4), SHORT SCREW (ITEM 6), WASHERS (ITEM 2), AND NUTS (ITEM 3) AS NEEDED.

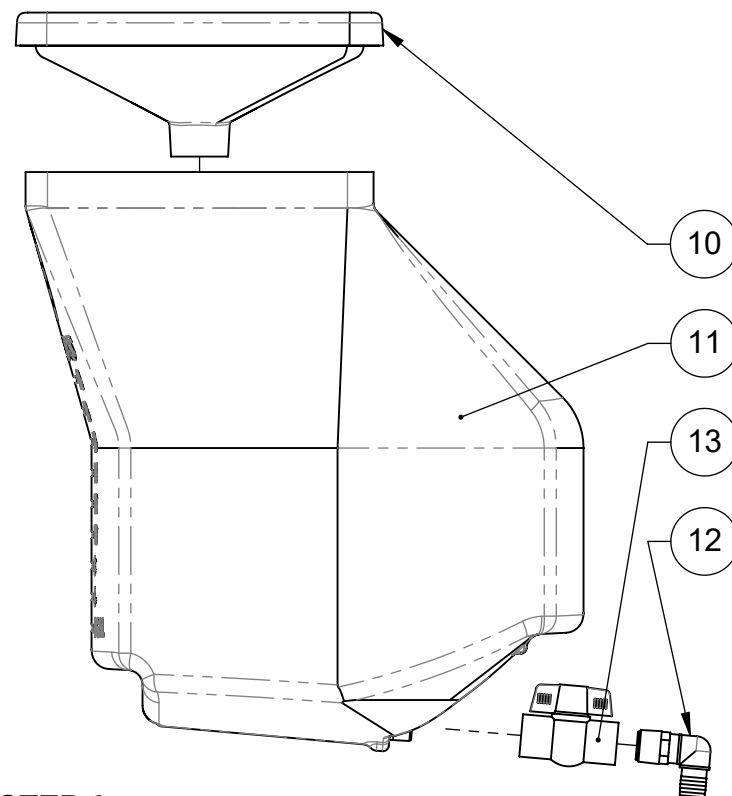

STEP 6
THREAD THE BALL VALVE (ITEM 13) ONTO THE PRE-INSTALLED NIPPLE LOCATED AT THE DRAIN OF THE TANK (ITEM 11). VERIFY THE VALVE AND NIPPLE ARE TIGHT ENOUGH TO PREVENT LEAKS.

THREAD THE BARBED ELBOW (ITEM 12) INTO THE BALL VALVE (ITEM 13) SUCH THAT IT IS TIGHT AND POINTING IN A DOWNWARD DIRECTION. PLACE THE TANK LID (ITEM 10) ON TOP OF THE TANK, AND CENTER THE TANK ASSEMBLY ONTO THE FRAME OF THE MODEL 9007 CART.



1455 KLEPPE LANE
SPARKS, NEVADA 89431
(775) 359-4712 FAX (775) 359-7424
E-MAIL: HAWS@HAWSO.COM
WEBSITE: WWW.HAWSO.COM

| | | | | |
|--------------|----------------|------------|--|--------------------------|
| ECN: 6210 | REV. ECN: 6210 | BY: JU | MODEL(S) 9007, PORTABLE EYEWASH CART WITH TANK | PART NUMBER 0510002289.D |
| DRAWN: JU | DATE: 11/21/24 | CHKD: JU | | REVISION 1 |
| APPROVED: DN | DATE: 05/08/25 | SCALE: 1/8 | DRAWING TYPE: INSTALLATION | SHEET 4 OF 4 |