



INSTALLATION, OPERATION & MAINTENANCE INSTRUCTIONS

1455 Kleppe Lane ♦ Sparks, NV 89431-6467 ♦ (775) 359-4712 ♦ Fax (775) 359-7424
E-mail: haws@hawsco.com ♦ website: www.hawsco.com

No. 0510002289 (1)

Model 9007 PORTABLE EYEWASH CART WITH TANK

NOTE TO INSTALLER: Please leave this information with the Maintenance Department.

LIMITED WARRANTY

HAWS warrants that all of its products are guaranteed against defective material or poor workmanship for a period of **one year from the date of shipment**. The foregoing notwithstanding, *HAWS* warrants certain specific products or components thereof for an adjusted period. A list of these excepted products and components and a description of their respective warranty terms may be found here: www.hawsco.com/warranty. *HAWS'* liability under this warranty shall be discharged by furnishing without charge F.O.B. *HAWS* factory any goods, or part thereof, which shall appear to the Company upon inspection to be of defective material or not of first-class workmanship, provided that a claim is made in writing to Company within a reasonable period after receipt of the product. Where claims for defects are made, the defective part or parts shall be delivered to the Company, prepaid, for inspection. *HAWS* shall not be liable for the cost of repairs, alterations or replacements, or the labor required to implement them, or for any expense connected therewith made by the owner or owner's agents, except upon written authority from *HAWS*. *HAWS* shall not be liable for any damages caused by defective materials or poor workmanship, except for replacements, as provided above. Buyer agrees that *HAWS* has made no other warranties either express or implied in addition to those above stated, except that of title with respect to any of the products or equipment sold hereunder and that *HAWS* shall not be liable for general, special, incidental, or consequential damages claimed to arise under the contract of sale.

Equipment manufactured by *HAWS* is warranted to function if installation and maintenance instructions provided are adhered to. The units also must be used for the purpose for which they were intended. Any *HAWS* emergency equipment is intended to supplement first-aid treatment. Due to widely varying conditions, *HAWS* cannot guarantee that the use of this emergency equipment will prevent serious injury or the aggravation of existing or prior injuries.

EXCEPT AS EXPRESSLY STATED HEREIN, HAWS HEREBY DISCLAIMS ALL WARRANTIES, WHETHER EXPRESS OR IMPLIED, ARISING BY LAW OR OTHERWISE, INCLUDING WITHOUT LIMITATION, ANY IMPLIED WARRANTIES OF MERCHANTABILITY AND FITNESS FOR A PARTICULAR PURPOSE. THIS WARRANTY MAY NOT BE MODIFIED OR EXTENDED WITHOUT THE WRITTEN CONSENT OF HAWS. REMEDIES AND REPLACEMENTS STATED HEREIN ARE EXCLUSIVE. IN NO EVENT SHALL HAWS BE LIABLE FOR ANY SPECIAL, PUNITIVE, CONSEQUENTIAL OR INCIDENTAL DAMAGES TO ANY PERSON INCLUDING BUT NOT LIMITED TO DAMAGES FOR LOSS OF USE OR PROFITS, SUBSTITUTE PRODUCTS OR COSTS, PROPERTY DAMAGE, OR OTHER MONETARY LOSS.

SHOULD YOU EXPERIENCE DIFFICULTY WITH THE INSTALLATION OF THIS MODEL PLEASE CALL:

TECHNICAL SUPPORT: 1-800-766-5612
FOR CUSTOMER SERVICE: 1-888-640-4297

LOCATION OF UNIT: The Model 9007 is intended for use indoors on smooth, level ground. Refer to your eyewash installation instructions for additional considerations when locating the unit.

COMPATIBLE EYEWASH PRODUCTS: The Model 9007 is designed to support a maximum hanging weight of 175lb and is compatible with a wide range of portable eyewash models. Verify your eyewash mounting requirements and refer to the dimensions provided in the Model 9007 installation instructions to determine compatibility.

INSTALLATION PROCEDURE

GENERAL NOTES:

1. REFER TO INSTALLATION INSTRUCTIONS ON THE FOLLOWING PAGES.
2. AFTER INSTALLATION, CHECK EYEWASH FUNCTION TO ENSURE THAT THE UNIT IS STILL IN COMPLIANCE WITH THE REQUIREMENTS OF PERTINENT CODES AND STANDARDS (E.G., DIMENSIONS, ACTIVATION, FLOW CHARACTERISTICS, ETC.).

OPERATION:

- The Model 9007 should be pushed rather than pulled and should never be towed or pushed by equipment. When moving the Model 9007, unlock the caster wheels and avoid obstacles and uneven or rough terrain.
- Make sure the valve on the drain tank is closed (i.e., valve handle is perpendicular to the valve body) unless the tank is being drained.

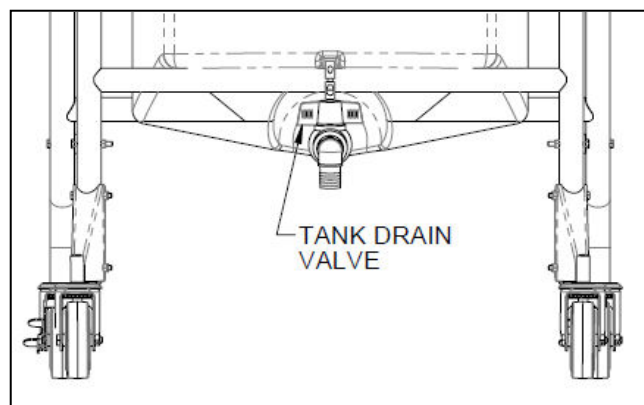

Figure 1: Closed Drain Valve

- Always lock the caster wheels after relocating the Model 9007.
- The drain tank holds a maximum of 20 gallons of water, do not overfill the tank.

MAINTENANCE:

- To clean the inside of the drain tank, first remove the drain tank lid by lifting it upwards. Use a soft cloth or sponge with a mild detergent (non-abrasive) and warm water to remove any dirt or debris from the tank.

TROUBLESHOOTING:

TROUBLESHOOTING	
PROBLEM	REPAIR CHECKLIST
1. TANK DRAIN FITTING IS LEAKING	1a. CHECK THAT FITTINGS ARE SUFFICIENTLY TIGHTENED. b. REPLACE THREAD SEALING TAPE IF DAMAGED OR MISSING. c. REPLACE FITTINGS IF THREADS ARE DAMAGED.

EMERGENCY SHOWER COMPLIANCE TESTING:

- The Model 9007 may be used in conjunction with the Model 9010 or 9011 shower test kits to verify compliance with ANSI/ISEA Z358.1 or EN15154 flow rates. Follow the steps below to test compliance:
 - Remove the lid of the 9007 tank.
 - Verify the drain valve on the 9007 tank is closed and the tank is empty.
 - Use the 9010 / 9011 shower funnel to fill the tank for the duration indicated in the table below.
 - If a minimum of 4 gallons of water is in the tank, the shower meets the required flow rate.
 - NOTE:** Water volume markings are accurate at the top edge of the marking (Figure 2).

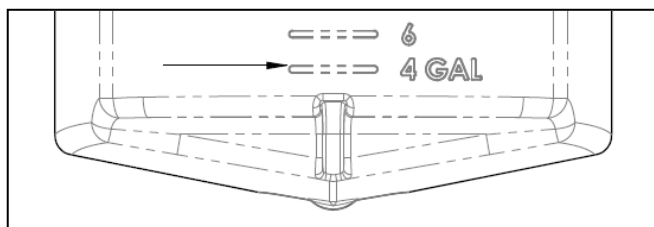

Figure 2: Top edge of water volume marking.

Standard	Required Flow Rate	Duration to Fill Minimum 4 Gallons
ANSI/ISEA Z358.1	20 gal/min	12 sec
EN15154: Class I	30 to 60 L/min	30 sec
EN15154: Class II	>60 to 100 L/min	15 sec
EN15154: Class III	>100 L/min	9 sec

Table 1: Shower test flow durations.

*For more information about Haws products, see our website: www.hawesco.com

© 2025 Haws® Corporation – All Rights Reserved
HAWS® and other trademarks used in these materials are the exclusive property of Haws Corporation.

NOTES:

1. HOLD ROUGH-IN DIMENSIONS $\pm 1/4"$ (6.4mm).
2. WHEN INSTALLING THIS UNIT, LOCAL, STATE, OR FEDERAL CODES SHOULD BE ADHERED TO. FOR INSTALLATION HEIGHTS OTHER THAN SHOWN, DIMENSIONS MARKED (*) MUST BE ADJUSTED ACCORDINGLY. INSTALL A TRAP IN THE WASTE LINE AND A SCREWDRIVER STOP IN THE SUPPLY LINE IF REQUIRED.
3. TO COMPLY WITH ANSI Z358.1-2014 FOR EMERGENCY EYEWASH AND SHOWER EQUIPMENT:
 - UNIT SHALL BE INSTALLED IN ACCORDANCE WITH MANUFACTURER'S INSTRUCTIONS AND ACCEPTABLE PLUMBING PRACTICES.
 - EYEWASH STREAMS SHALL BE POSITIONED SUCH THAT STREAMS ARE 15.3 CM (6 IN.) MINIMUM FROM THE WALL OR NEAREST OBSTRUCTION AND MEET ANSI GAUGE REQUIREMENTS BETWEEN 83.8 & 134.6 CM (33-53 IN) ABOVE FLOOR.

(NOTES CONTINUED ON NEXT SHEET)

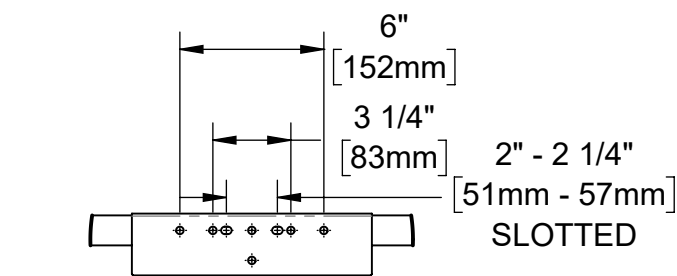

**DETAIL A
(BRACKET HIDDEN
FOR CLARITY)**



**MODEL 9007
PORTABLE
EYEWASH CART
WITH TANK**

**TANK DRAIN
(1" BARB OR NPT)**

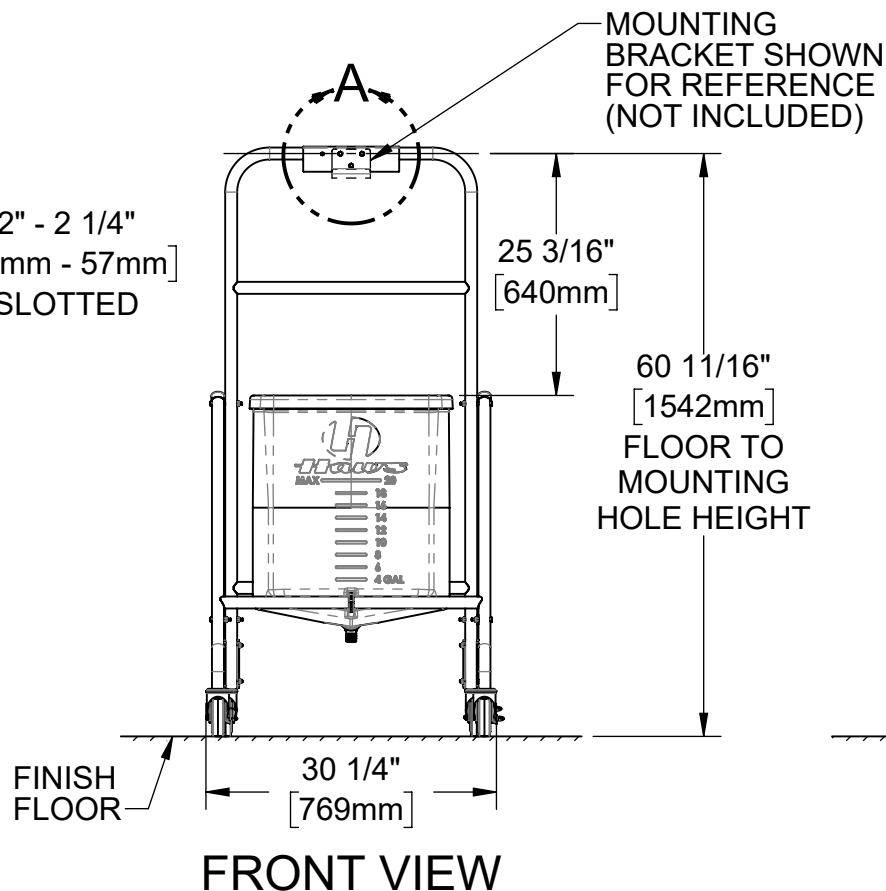

FRONT VIEW

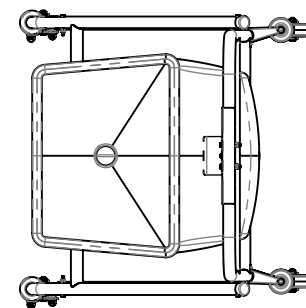

TOP VIEW

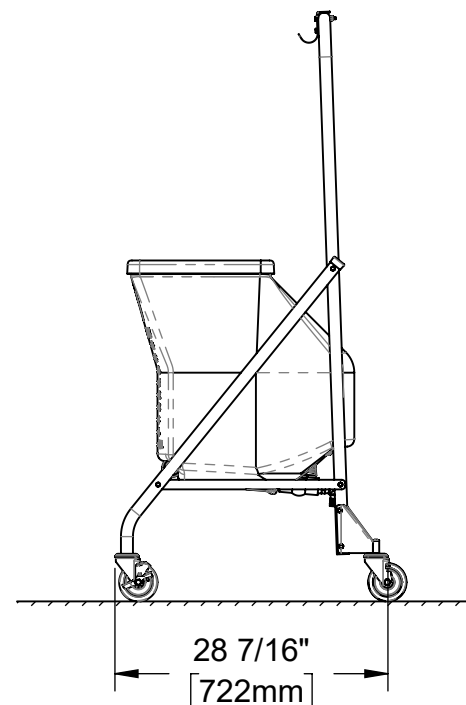

SIDE VIEW



1455 KLEPPE LANE
SPARKS, NEVADA 89431
(775) 359-4712 FAX (775) 359-7424
E-MAIL: HAWS@HAWSO.COM
WEBSITE: WWW.HAWSO.COM

ECN: 6210	REV. ECN: 6210	BY: JU	MODEL(S) 9007, PORTABLE EYEWASH CART WITH TANK	PART NUMBER 0510002289.D
DRAWN: JU	DATE: 11/21/24	CHKD: JU		REVISION 1
APPROVED: DN	DATE: 05/08/25	SCALE: 1:20	DRAWING TYPE: INSTALLATION	SIZE: A

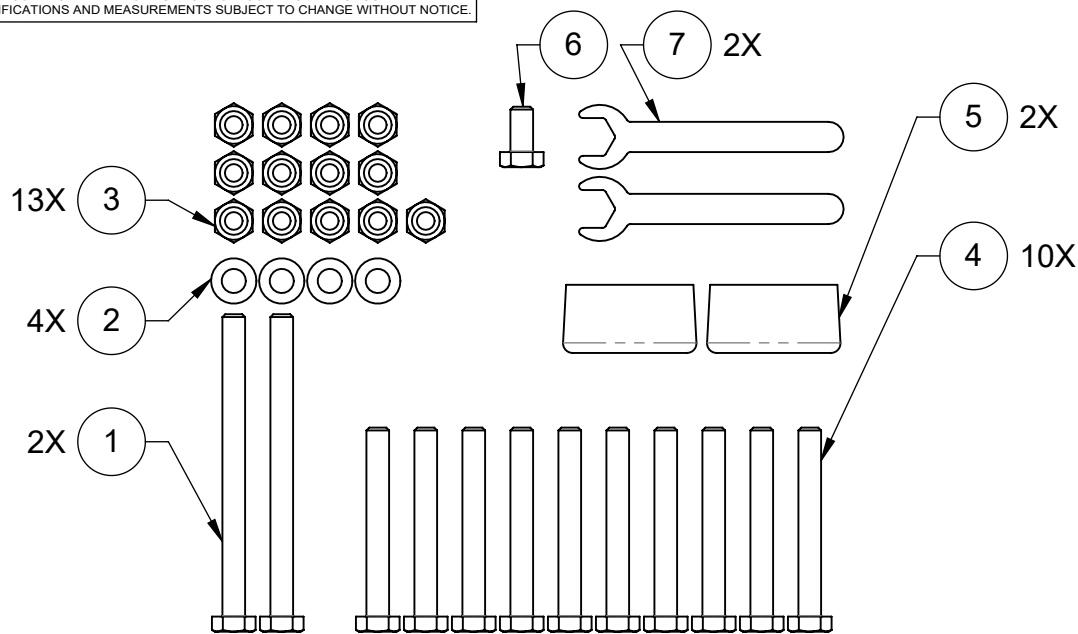

INCLUDED HARDWARE

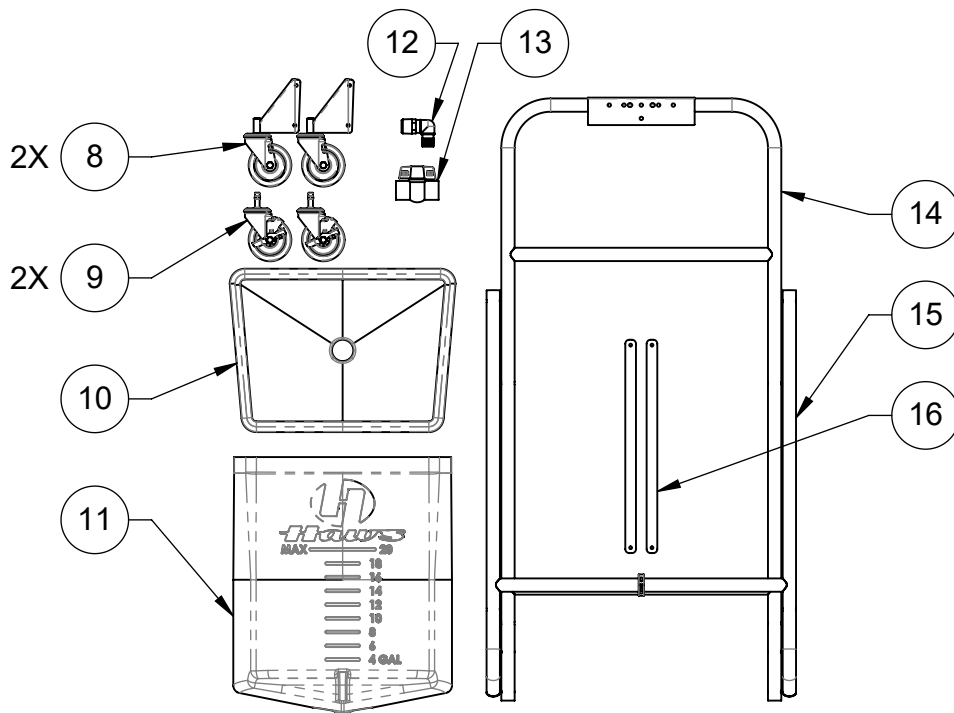

INCLUDED DRAIN AND FRAME COMPONENTS

16	BRACKET, LOWER BRACE	2
15	FRAME, TUBULAR, FRONT SUPPORT	1
14	FRAME, TUBULAR, VERTICAL	1
13	VALVE, 1" NPT	1
12	ELBOW, 1" NPT X 1" BARB	1
11	TANK, 20GAL	1
10	TANK COVER	1
9	CASTER, FRONT, WITH BRAKE	2
8	CASTER, REAR, WITH BRACKET	2
7	WRENCH, OPEN END, 10MM	2
6	SCREW, M6 X 12MM, HEX	1
5	CAP, SLIP ON, PLASTIC	2
4	SCREW, M6 X 50MM, HEX	10
3	NUT, M6, W/ NYLON INSERT	13
2	WASHER, M6	4
1	SCREW, M6 X 80MM, HEX	2
ITEM	DESCRIPTION	QTY
INCLUDED PARTS		

NOTES CONTINUED:

- TORQUE ALL NUTS AND BOLTS TO 26.5 LB-IN [3 Nm]. OVER-TORQUEING HARDWARE MAY DAMAGE STEEL TUBING.

 <div>1455 KLEPPE LANE SPARKS, NEVADA 89431 (775) 359-4712 FAX (775) 359-7424 E-MAIL: HAWS@HAWS.CO.COM WEBSITE: WWW.HAWS.CO.COM</div>				PART NUMBER 0510002289.D	
ECN: 6210	REV. ECN: 6210	BY: JU	MODEL(S) 9007, PORTABLE EYEWASH CART WITH TANK	REVISION 1	
DRAWN: JU	DATE: 11/21/24	CHKD: JU	APPROVED: DN	DATE: 05/08/25	SCALE: 1:18
DRAWING TYPE: INSTALLATION			SIZE: A SHEET 2 OF 4		

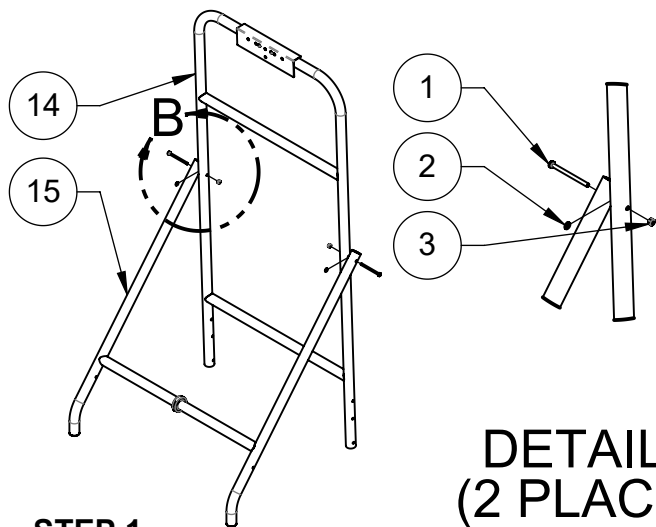

**DETAIL B
(2 PLACES)**

STEP 1

CONNECT THE TUBULAR FRAMES USING LONG SCREWS (ITEM 1), WASHERS (ITEM 2), AND LOCK NUTS (ITEM 3). WASHERS (ITEM 2) ARE INSTALLED BETWEEN THE FRAME PIECES.

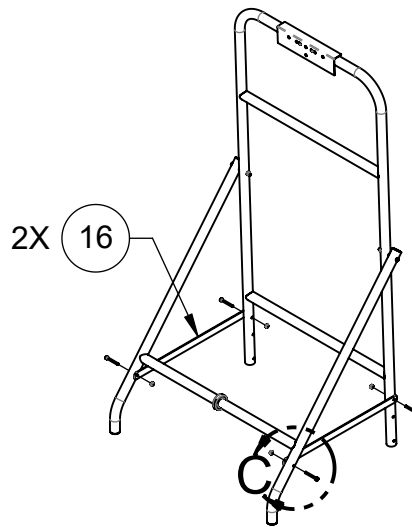

**DETAIL C
(4 PLACES)**

STEP 2

INSTALL THE TWO FLAT BRACKETS AS SHOWN, USING MEDIUM SCREWS (ITEM 4) AND LOCK NUTS (ITEM 3).

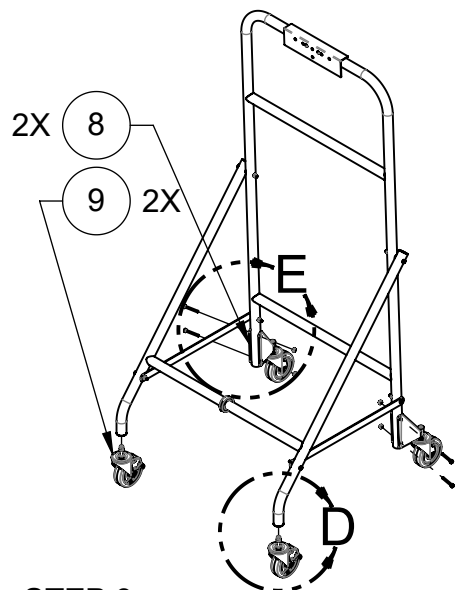

**DETAIL D
(2 PLACES)**

STEP 3

ATTACH THE FRONT CASTERS WITH BRAKES (ITEM 9) BY INSERTING THEM FULLY INTO THE BOTTOM OF THE FRONT LEGS OF THE FRAME. A RUBBER Mallet AND/OR BLOCK OF WOOD MAY BE USED TO ASSIST WITH INSTALLATION. ATTACH THE REAR CASTERS (ITEM 8) USING MEDIUM SCREWS (ITEM 4) AND LOCK NUTS (ITEM 3).

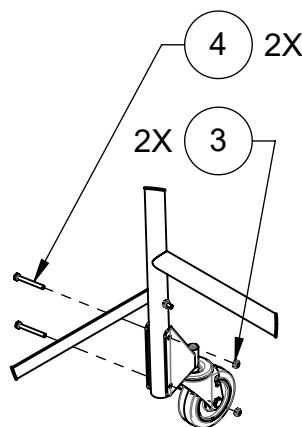
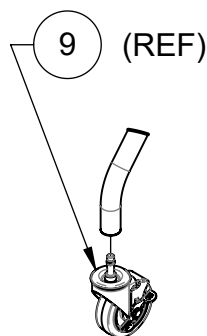

**DETAIL E
(2 PLACES)**

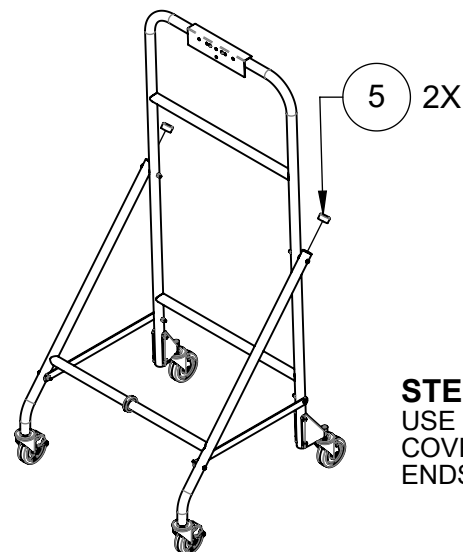

STEP 4

USE THE CAPS (ITEM 5) TO COVER THE OPEN TUBE ENDS.



1455 KLEPPE LANE
SPARKS, NEVADA 89431
(775) 359-4712 FAX (775) 359-7424
E-MAIL: HAWS@HAWS.CO.COM
WEBSITE: WWW.HAWS.CO.COM

ECN: 6210	REV. ECN: 6210	BY: JU	MODEL(S)	PART NUMBER
DRAWN: JU	DATE: 11/21/24	CHKD: JU	9007, PORTABLE EYEWASH CART WITH TANK	0510002289.D
APPROVED: DN	DATE: 05/08/25	SCALE: 1:24	DRAWING TYPE: INSTALLATION	REVISION 1
			SIZE: A	SHEET 3 OF 4

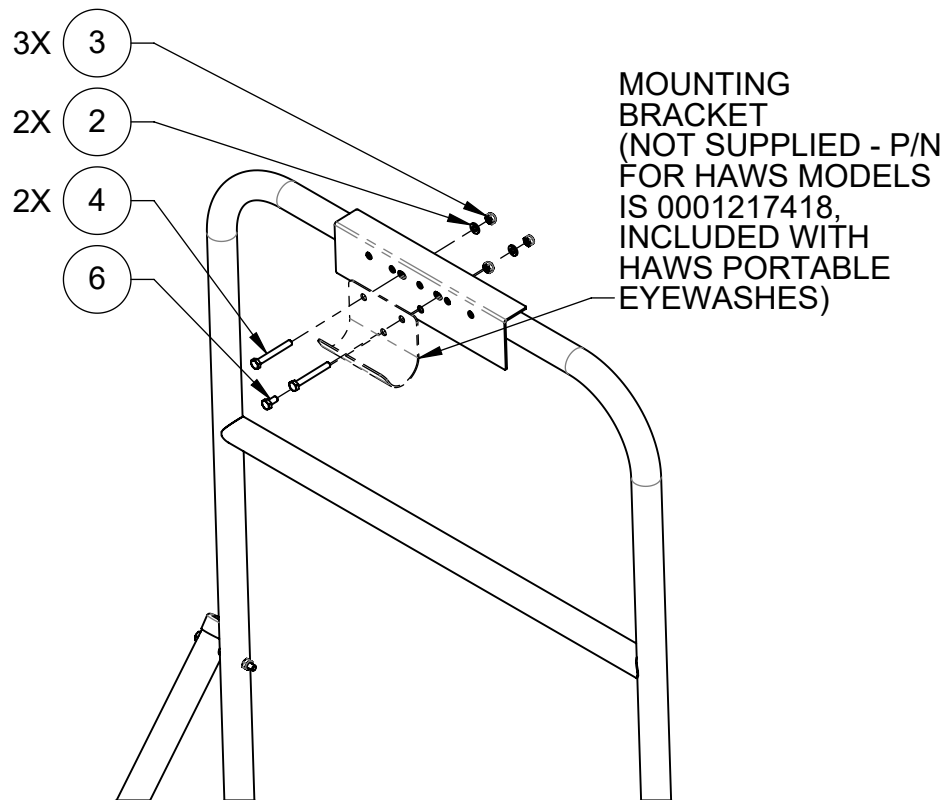

STEP 5
INSTALL THE PORTABLE EYEWASH MOUNTING BRACKET (NOT INCLUDED) USING MEDIUM SCREWS (ITEM 4), SHORT SCREW (ITEM 6), WASHERS (ITEM 2), AND NUTS (ITEM 3) AS NEEDED.

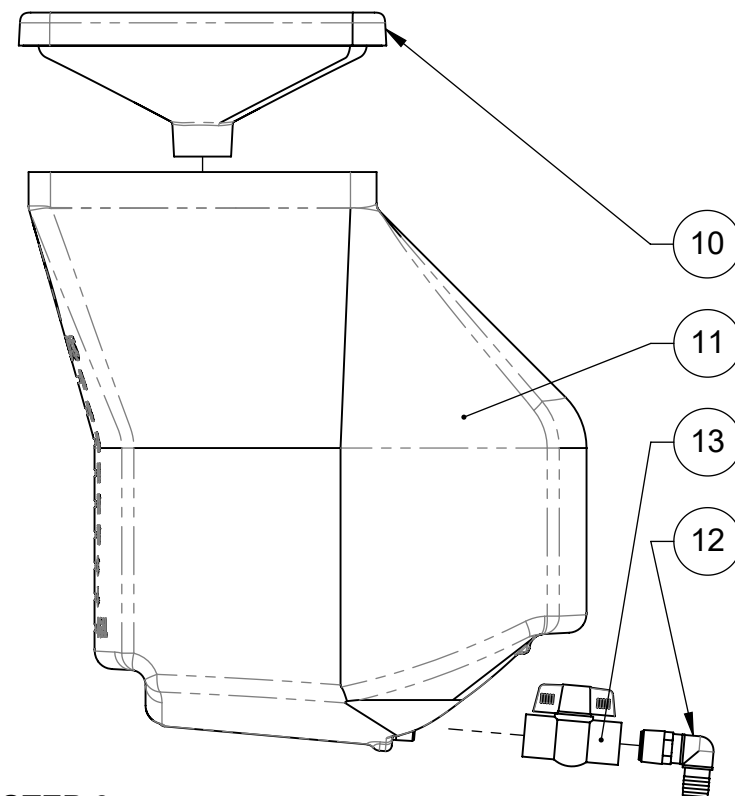

STEP 6
THREAD THE BALL VALVE (ITEM 13) ONTO THE PRE-INSTALLED NIPPLE LOCATED AT THE DRAIN OF THE TANK (ITEM 11). VERIFY THE VALVE AND NIPPLE ARE TIGHT ENOUGH TO PREVENT LEAKS.

THREAD THE BARBED ELBOW (ITEM 12) INTO THE BALL VALVE (ITEM 13) SUCH THAT IT IS TIGHT AND POINTING IN A DOWNWARD DIRECTION. PLACE THE TANK LID (ITEM 10) ON TOP OF THE TANK, AND CENTER THE TANK ASSEMBLY ONTO THE FRAME OF THE MODEL 9007 CART.



1455 KLEPPE LANE
SPARKS, NEVADA 89431
(775) 359-4712 FAX (775) 359-7424
E-MAIL: HAWS@HAWSO.COM
WEBSITE: WWW.HAWSO.COM

ECN: 6210	REV. ECN: 6210	BY: JU	MODEL(S) 9007, PORTABLE EYEWASH CART WITH TANK	PART NUMBER 0510002289.D
DRAWN: JU	DATE: 11/21/24	CHKD: JU		REVISION 1
APPROVED: DN	DATE: 05/08/25	SCALE: 1:8	DRAWING TYPE: INSTALLATION	SHEET 4 OF 4