

## FEATURES & BENEFITS

### CONSTRUCTION

Heavy-duty cast iron bowl with a glossy white enamel finish is designed for the toughest of applications, and at the same time is gentle to all users with its soft rounded corners. Unit also ships with vandal-resistant bottom plates to provide added peace of mind.

### VANDAL RESISTANT

The bubbler heads, drain strainer and bottom plate are locked in place, discouraging unwanted vandal tampering.

### BUBBLER HEADS

Polished chrome-plated brass bubbler heads with integral 11/16" dia. basin shank and stainless anti-rotation roll pin for vandal resistance strength. Shielded, angled stream opening provides a steady, sanitary source of drinking water at .45 gpm.

### FOUNTAIN VALVES

Fountain incorporates touchless sensor operated stainless steel solenoid valves controlled by a transformer for handsfree operation. A pressure regulator is used to adjust the bubbler flow according to incoming water pressures.

### HIGH CAPACITY BASIN

Combined low profile design and the use of three bubblers supply the needs of many, which is perfect for schools and other high traffic areas.

### INTEGRATED TRAP

All cast brass 1-1/4" NPT adjustable traps completely concealed inside bottom plates for easy installation and lack of unwanted access.

## OPTIONS

- Water Filter: Model 6426, 10" x 2" (25.4 x 5.1 cm), in-line lead removal element that reduces lead from incoming water supply.
- Remote Drinking Fountain Water chiller: Model HCR8, 8 gph (30.3 L) remote water chiller provides instantaneous cooling to meet a continuous demand for chilled water.

For more information, visit [www.hawsc.com](http://www.hawsc.com) or call (888) 640-4297.



## SPECIFICATIONS

Model 1435HO vandal-resistant wall mounted drinking fountain shall include a white enameled-iron basin mounted with twin galvanized cast-iron wall brackets, touchless sensor operated stainless steel solenoid valves with 30-second obstruction time-out controlled by a transformer, 100% lead-free waterways, polished chrome-plated brass vandal resistant bubbler heads, polished chrome-plated brass vandal-resistant waste strainer, vandal-resistant bottom plate, and chrome-plated 1-1/2" NPT trap.

### FOR INDOOR USE ONLY

## APPLICATIONS

Perfect for either public or private settings, our gleaming white enameled-iron series is one of the sturdiest wall mounted fountains Haws produces. This unit is the perfect fit for high traffic areas where there is a greater need for multiple drinking stations. Elegant gloss finish and color consistency throughout the enameled-iron maintain the fountains overall appeal so it always remains looking as new as it did when it was installed. Specifically, this type of wall mounted drinking fountain may be placed in settings such as: parks, schools, and other indoor/outdoor environments where the temperature remains above freezing. Haws manufactures drinking fountains, faucets and electric water coolers to be lead-free by all known definitions including NSF/ANSI/CAN 61- Section 9, NSF/ANSI/CAN 372, California Proposition 65, and the Federal Safe Drinking Water Act. Product is compliant to California Health and Safety Code 116875 (AB 1953-2006), and 116876 (AB 100) "NSF/ANSI/CAN 61: Q ≤ 1".



**NOTES:**

1. ROUGH-IN DIMENSIONS MAY VARY ±1/4" (6.4mm)
2. WHEN INSTALLING THIS UNIT LOCAL, STATE OR FEDERAL CODES SHOULD BE ADHERED TO. FOR INSTALLATION HEIGHTS OTHER THAN SHOWN, DIMENSIONS MARKED (\*) MUST BE ADJUSTED ACCORDINGLY.
- 3 REFER TO 5874 SERIES OPERATION AND MAINTENANCE MANUAL FOR PUSH BUTTON AND VALVE INSTALLATION/MAINTENANCE INSTRUCTIONS.

(NOTES CONTINUED ON SHEET 2 OF 2)

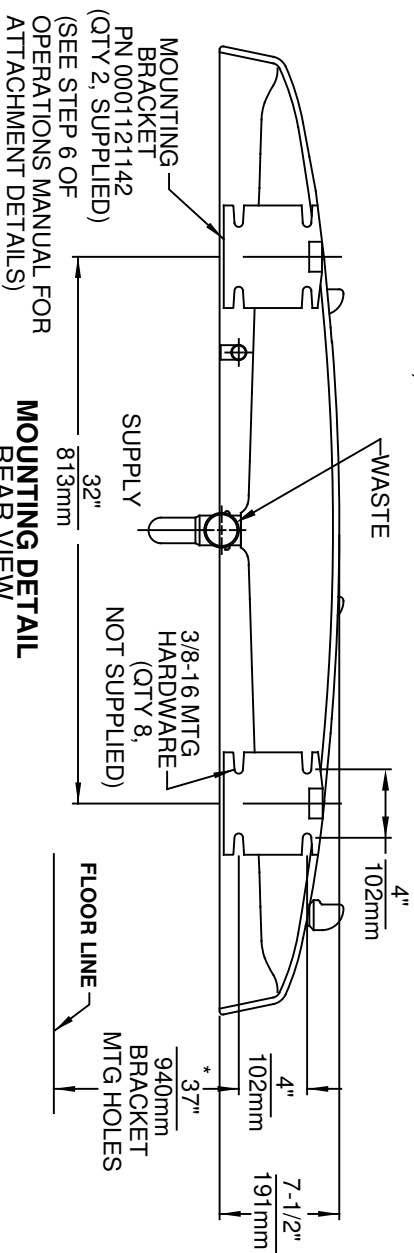

**MOUNTING DETAIL REAR VIEW**

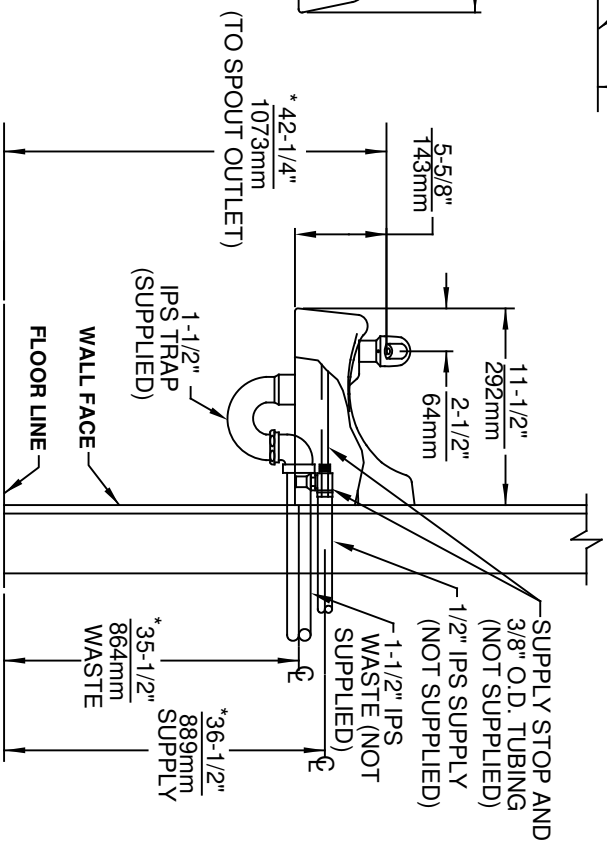

|   |              |   |              |
|---|--------------|---|--------------|
|   |              | <b>THAWWS</b>                                     |              |
| 1459 KLEPPE LANE<br>SPARKS, NEVADA, 89431<br>(775) 359-4712 FAX (775) 359-7424<br>E-MAIL: HAWWS@HAWSCO.COM<br>WEBSITE: WWW.HAWSCO.COM |              | MODEL(S)<br><b>1435</b><br>THREE BUBBLER FOUNTAIN |              |
| ECN NO. REVISED PER BY:   | ECN: S188    | CHKD:   | JP           |
| DATE:   | 01-01-91     | VWC   |              |
| APPROVED:   | FV           | DATE:   | 07/06/17     |
| SCALE:  | 1:1          | DRAWING TYPE:                                     | INSTALLATION |
| PART NUMBER   | 0002076860.D | REVISION:   | 17           |
| SIZE:   | A            | SHEET:  | 1 OF 2       |

**NOTES: (CONTINUED)**

4. CONNECT WHITE "POLYPROPYLENE" TUBING ON PRESSURE SIDE (INLET) OF VALVE.
5. CONNECT CLEAR "POLYETHYLENE" TUBING ON FREE FLOW SIDE (VALVE TO BUBBLER HEAD) ONLY.

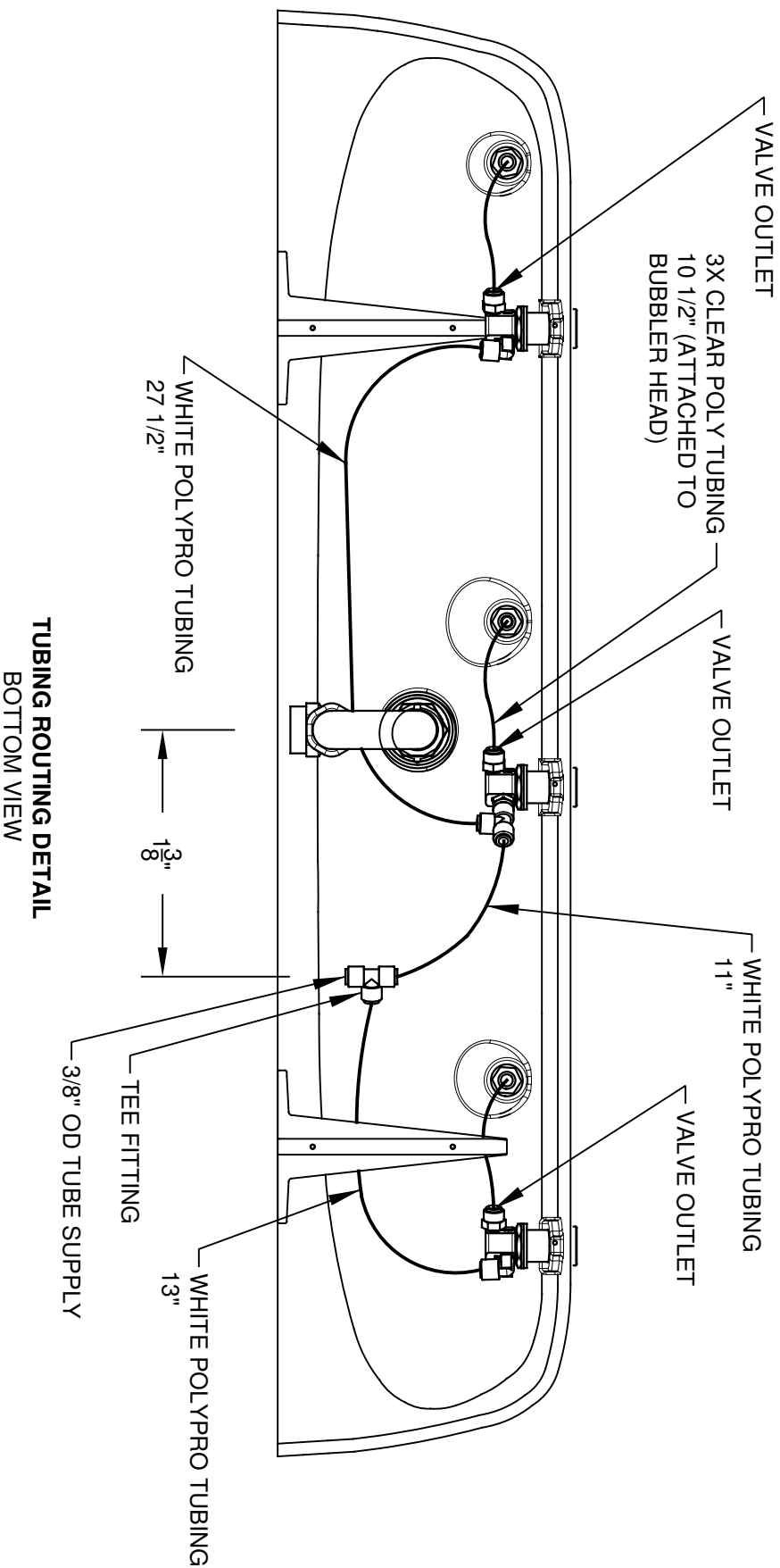

**TUBING ROUTING DETAIL  
BOTTOM VIEW**

|  |                        |                            |              |
|--|------------------------|----------------------------|--------------|
|  |                        | <b>Haws</b>                |              |
| 1459 KLEPPE LANE<br>SPARKS, NEVADA, 89431<br>(775) 359-4712 FAX (775) 359-7424<br>E-MAIL: HAWS@HAWSCO.COM<br>WEBSITE: WWW.HAWSCO.COM |                        |                            |              |
| ECN NO. REVISED PER BY:  | MODEL(S)               | 1435                       | PART NUMBER  |
| 5188   | THREE BUBBLER FOUNTAIN |                            | 0002076860.D |
| DATE: 11-01-91   | CHK'D: VWC             |                            | REVISION: 17 |
| APPROVED: FV   | SCALE: 1:11            | DRAWING TYPE: INSTALLATION | SHEET 2 OF 2 |

**NOTES:**

- 3RKHO.P AND 3RKHO.H RETROFIT KITS ALLOW INDOOR FOUNTAINS TO BE CONVERTED FROM A HAWS 587.4 PUSH BUTTON VALVE TO HANDS-OFF (TOUCHLESS) OPERATION. FOUNTAINS (NOT SUPPLIED) MAY BE MOUNTED ON THE EXTERNAL WALL OF A BUILDING PROVIDED THE TRANSFORMER SHALL BE MOUNTED INSIDE THE WALL AND PROTECTED FROM WATER AS SHOWN IN THIS INSTALLATION PER NEC/CEC AND LOCAL CODE. AVOID DIRECT CONTACT WITH SUNLIGHT ON THE SENSOR LENS.
- RETROFIT KIT MODEL:  
3RKHO.P: TRIPLE INDOOR HO RETRO-FIT KIT (INCLUDES 3X HO SENSOR WITH MOUNTING HARDWARE, 3X SOLENOID VALVE, 3X REGULATOR, WIRE SPLITTER, AND 100-240V PLUG-IN TRANSFORMER - SEE SHEET 2).  
3RKHO.H: TRIPLE INDOOR HO RETRO-FIT KIT (INCLUDES 3X HO SENSOR WITH MOUNTING HARDWARE, 3X SOLENOID VALVE, 3X REGULATOR, WIRE SPLITTER, AND 100-277V HARDWIRE TRANSFORMER - SEE SHEET 3).
- 3RKHO.P REQUIRES 100-240VAC POWER CONNECTION. 3RKHO.H REQUIRES 100-277V POWER CONNECTION.
- TRANSFORMERS MUST BE MOUNTED SUCH THAT THEY ARE PROTECTED FROM WATER.
- 3RKHO.P TRANSFORMER IS COMPATIBLE WITH TYPE A AND TYPE B NORTH AMERICAN ELECTRICAL OUTLETS. FOR OTHER RECEPTACLE TYPES, AN ADAPTER (NOT SUPPLIED) MUST BE PROVIDED BY OTHERS.

(NOTES CONTINUED ON SHEET 4)

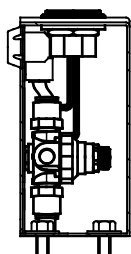

**EXAMPLE 1920 BOTTLE FILLER INSTALLATION**

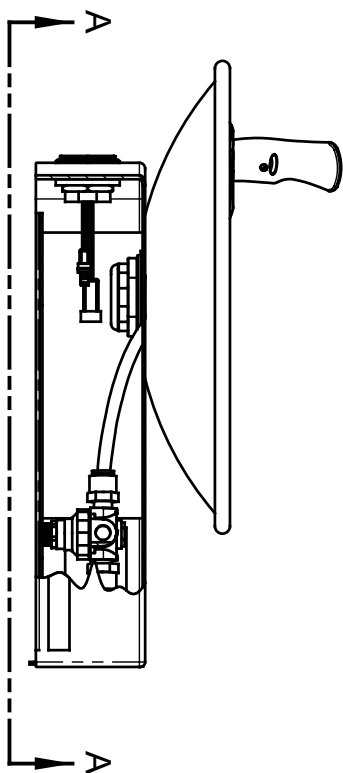

**EXAMPLE 1011 + 1920 FOUNTAIN INSTALLATION**

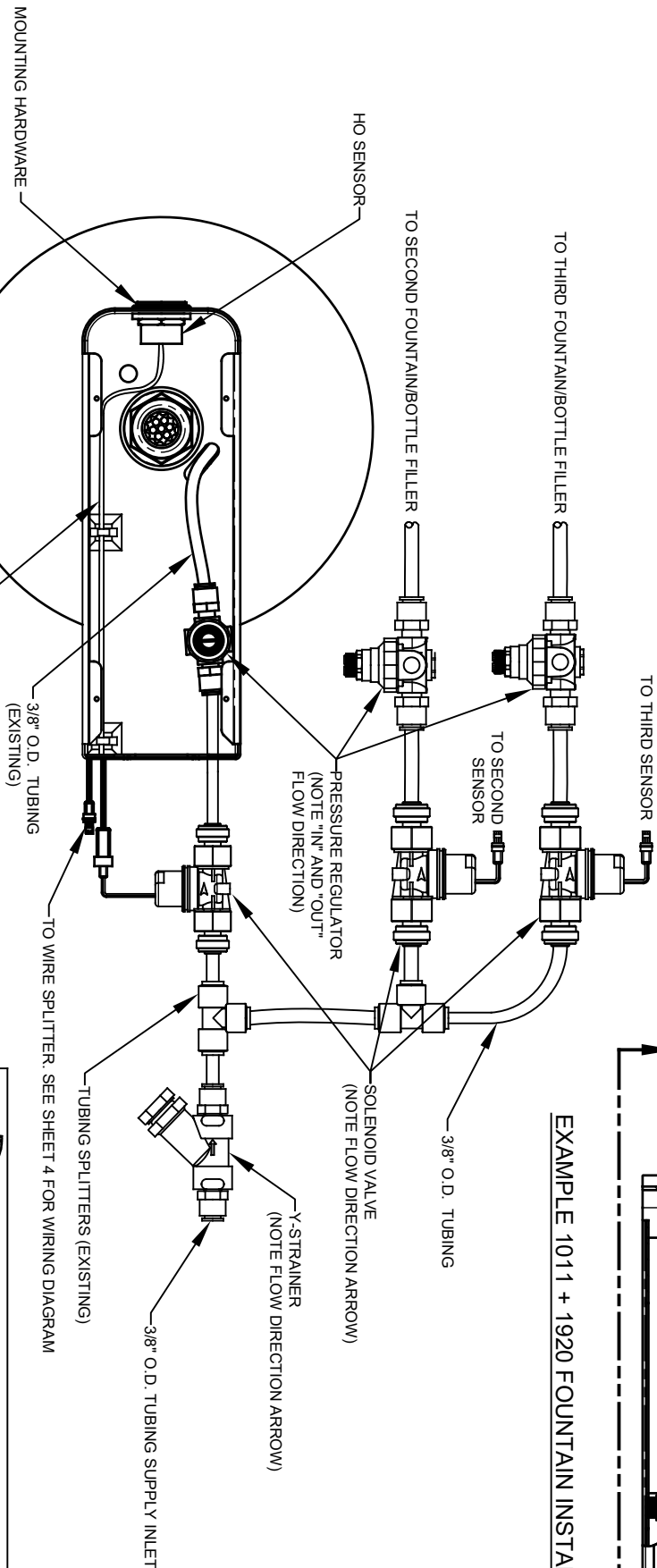

**VIEW A - A**  
(BOTTOM PLATE OMITTED FOR CLARITY)

POWER CONNECTION HARNESS  
(SEE ELECTRICAL SCHEMATIC - SUPPLIED WITH TRANSFORMER KIT - SHOWN FOR REFERENCE)



|               |  |                      |  |            |  |                                |  |
|---------------|--|----------------------|--|------------|--|--------------------------------|--|
| ECN NO. 5849  |  | REVISION PERBY: 5849 |  | MODEL(S)   |  | 3RKHO.P / 3RKHO.H              |  |
| DRAWN: BLM    |  | DATE: 02/10/21       |  | CHK'D: EV  |  | TRIPLE HANDS-OFF RETRO-FIT KIT |  |
| APPROVED: BLM |  | DATE: 10/20/21       |  | SCALE: N/A |  | DRAWING TYPE: INSTALLATION     |  |
| PART NUMBER   |  | 0580001157.D         |  | REVISION   |  | 4                              |  |

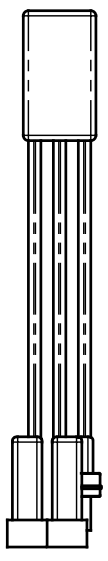

TRIPLE POWER SPLITTER

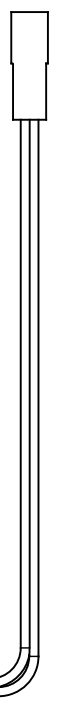

HARDWARE TRANSFORMER  
VRKH08

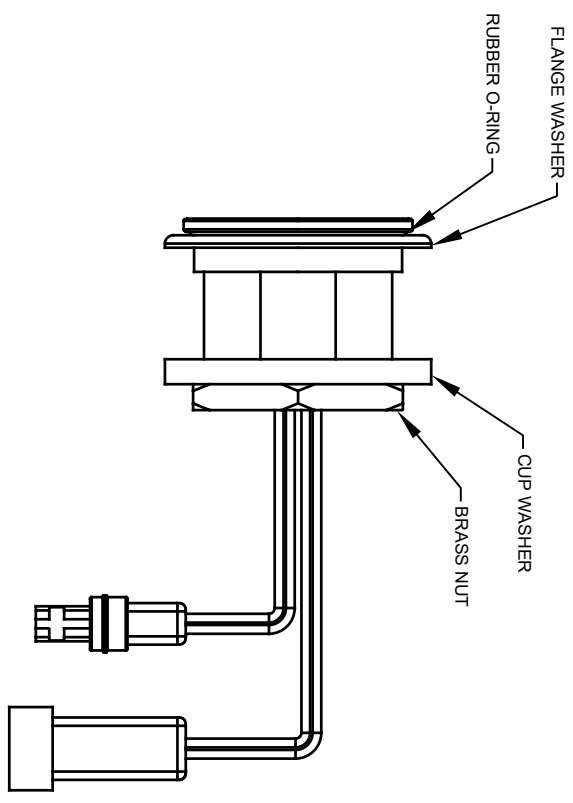

HO SENSOR ASSEMBLY (3X)  
VRKH06

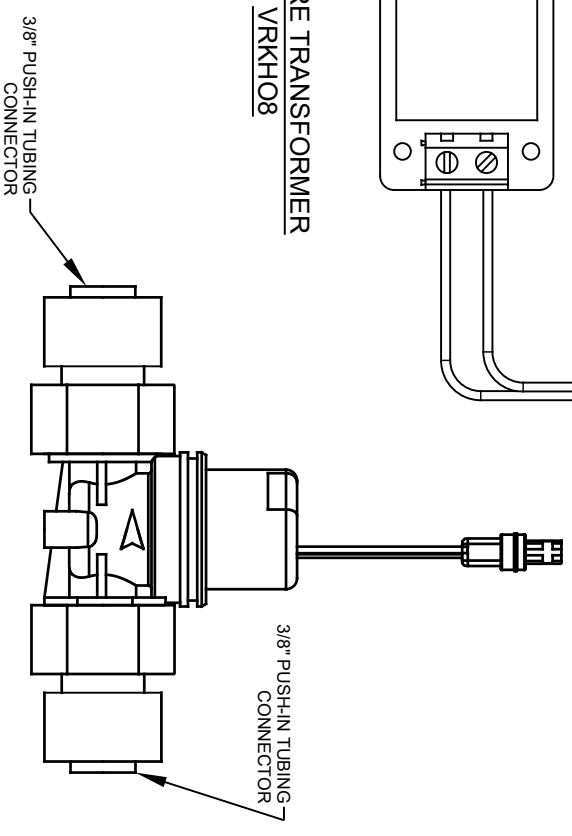

SOLENOID VALVE ASSEMBLY (3X)  
VRKH05

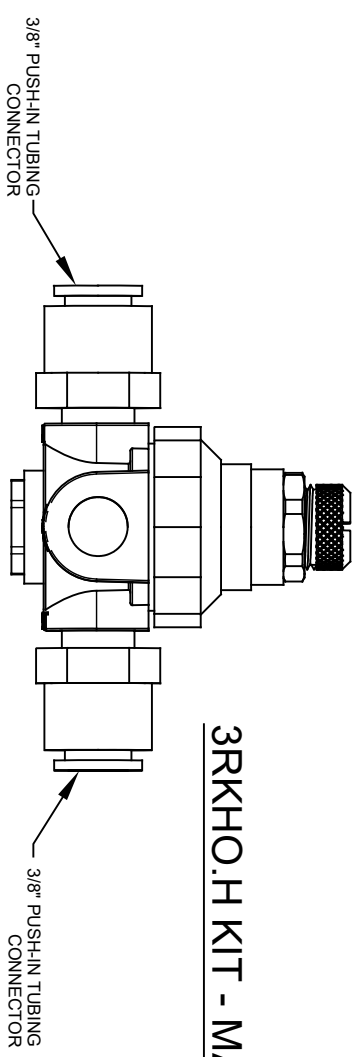

VALVE REGULATOR (3X)  
5867

3RKHO.H KIT - MAIN PARTS

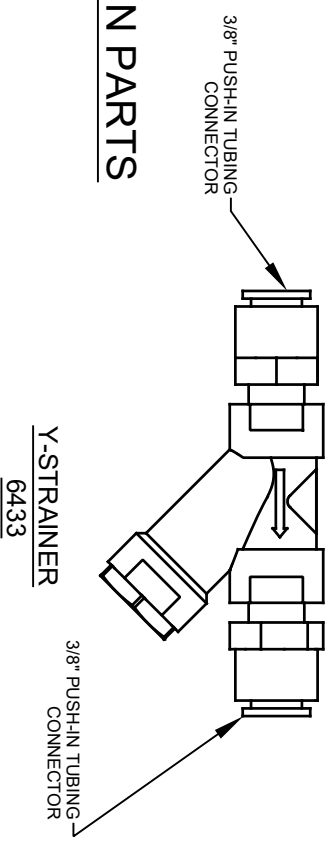

Y-STRAINER  
6433

|   |                |                             |                |
|---|----------------|-----------------------------|----------------|
|   |                | <b>Haws</b>                 |                |
| 1459 KLEPPE LANE<br>SPARKS, NEVADA 89431<br>(775) 359-4712 FAX (775) 359-7424<br>E-MAIL: HAWS@HAWSCO.COM<br>WEBSITE: WWW.HAWSCO.COM |                |                             |                |
| ECN NO. REVISED PER BY: 5849 BLM  | DATE: 02/10/21 | CHK'D: EV                   | DATE: 10/20/21 |
| APPROVED: BLM   | SCALE: N/A     | DRAWING TYPE: INSTALLATION  | SIZE: A        |
| MODEL(S)<br>3RKHO.P / 3RKHO.H   |                | PART NUMBER<br>0580001157.D |                |
| TRIPLE HANDS-OFF RETRO-FIT KIT  |                | REVISION: 4                 |                |
| SHEET 3 OF 4  |                |                             |                |