

# OUTDOOR HYDRATION STATIONS™

## Bottle Fillers & Drinking Fountains



Model 3612

# Smallest Installation Footprint on the Market

Forward facing activation buttons meet ADA guidelines while saving space!

## INSTALLATION WITHIN 8IN OF A WALL OR FENCE (TOP VIEW)

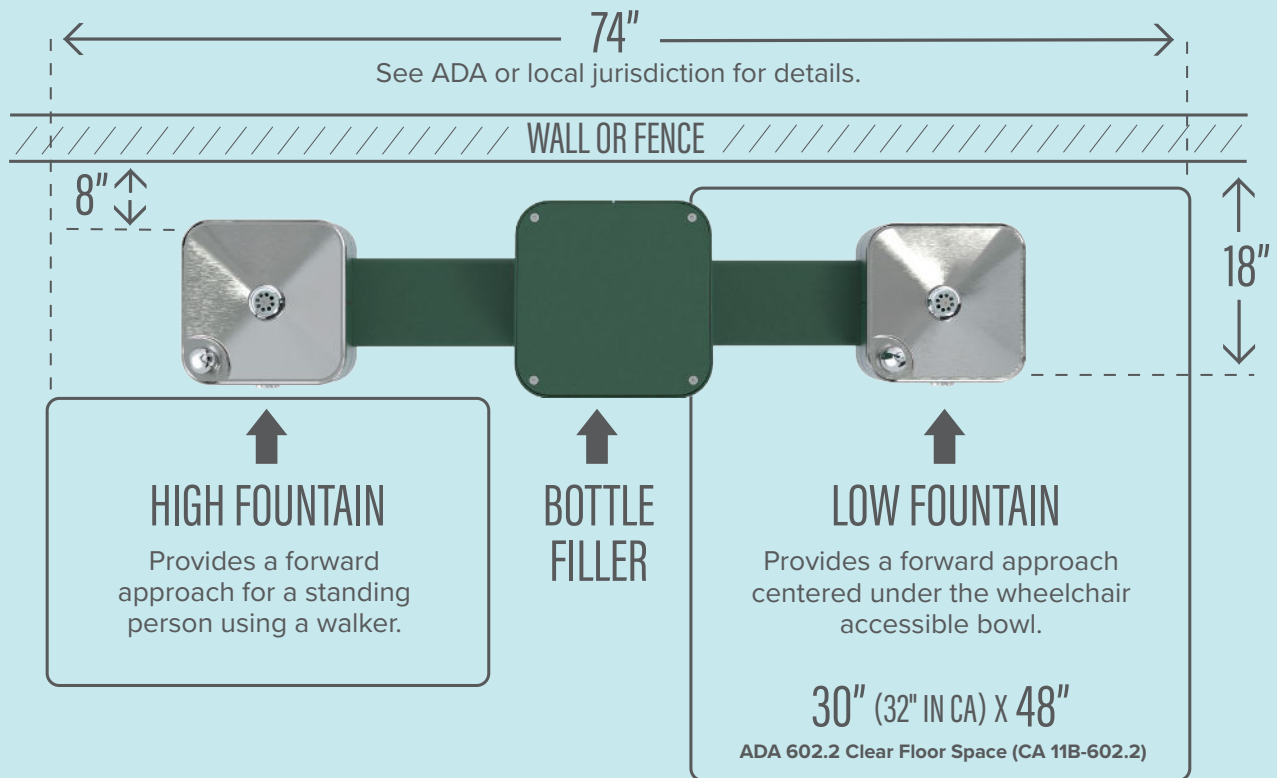

## STANDARD COLOR OPTIONS

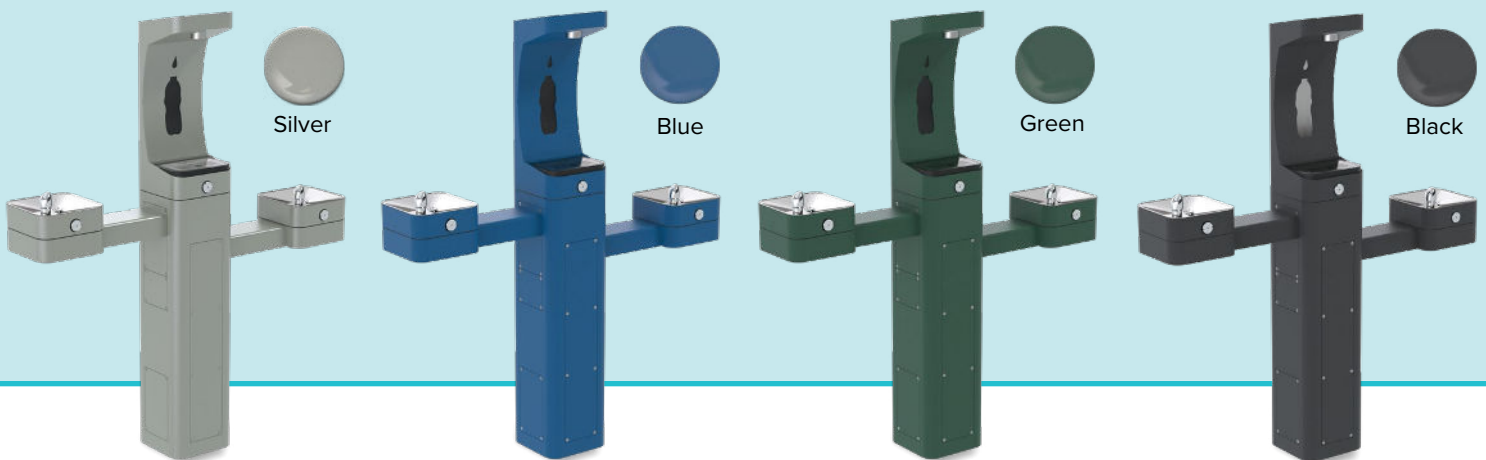

## Custom Color Options

For custom colors, contact customer service:  
[customerservice@hawsco.com](mailto:customerservice@hawsco.com), or call **888.640.4297**.



## ACCESSIBILITY FEATURES

- Standard models designed to meet ADA requirements
- Space-saving installation options
- Front access panels for simple maintenance and filter replacements
- Front-facing push buttons and front approach



## ENVIRONMENT AND HEALTH CONSCIOUS

- 100% lead free waterways
- Filtered options available
- Bottle filler attachment to reduce plastic consumption



Model 3612 with 3670  
dog bowl accessory

Full install drawings available  
at [hawsco.com](http://hawsco.com).



## VANDAL-RESISTANT CONSTRUCTION

- Heavy-duty stainless steel with powder coated exterior
- Freeze-resistant options available

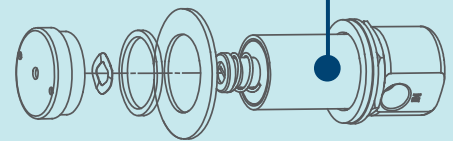

## INNOVATIVE VALVE DESIGN

**The ONLY Drinking Fountain Valve With:**

- An all-stainless steel valve body machined out of solid stainless steel bar stock
- Front access to the stainless water supply strainer
- Machined brass cartridge retainer rings



Contact your *Haws* distributor or sales representative for availability and ordering.  
Visit [hawsco.com/outdoor-hydration](http://hawsco.com/outdoor-hydration) for more information.



## ADDITIONAL ACCESSORIES

Interchangeable accessory options with the capability to reconfigure over time.



### 6477 RETROFIT FILTER KIT FOR 3600 SERIES OUTDOOR FOUNTAINS

Retrofit filter kit for the *Haws* 3600 series outdoor pedestal fountains includes a 6428 filter, filter bracket and supply line parts.



### 3661 HOSE BIB FAUCET, ODBF

Compression hose bib faucet mounted on a matte silver powder-coated panel for the *Haws* 3600 series outdoor pedestals.



### 5874PBF FOUNTAIN VALVE

Flush-mount, lead-free, stainless steel, push-activated, chrome-plated brass, push button valve. Includes PBA6 flush-mount, push button assembly.



### 3660 LOCKABLE HOSE BIB FAUCET

Compression lead-free hose bib faucet housed in a lockable matte silver powder-coated compartment for the *Haws* 3600 series outdoor pedestals.



### 6611 SAND TRAP

Sand trap for installing adjacent to outdoor pedestal drinking fountains to help prevent debris and contaminants from clogging waste line. Use model 6635 for models 3500 and 3511.



### PBA7C ANTIMICROBIAL COPPER VALVE BUTTON

Push button assembly with antimicrobial copper button for the 5874PB valve.

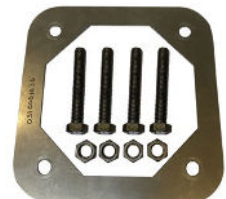

### MTG.3600 INSTALLATION AID FOR 3600 SERIES PEDESTAL FOUNTAINS

Installation assistance mounting plate for the *Haws* 3600 series pedestal fountains provides location aid for setting mounting bolts.



# ADA-COMPLIANT CONFIGURATIONS

ADA-Compliant standard models ideal for outdoor installations, including schools, parks and recreational facilities.



## **3602** **HI-LO DRINKING** **FOUNTAIN**

Meets ADA standing and wheelchair requirements.



## **3603** **HI-LO DRINKING** **FOUNTAIN**

Meets ADA child height requirements.



## **3612** **HI-LO DRINKING** **FOUNTAIN WITH** **BOTTLE FILLER**

Meets ADA standing and wheelchair requirements.



Learn more about ADA-Compliant models ideal for outdoor installations.



## ADDITIONAL CONFIGURATIONS

Modular design provides flexibility for attaining a perfect fit in any setting.



## **3610** **BOTTLE FILLER**

Heavy-duty vandal-resistant outdoor pedestal bottle filler, configurable in multiple variations.



## **3611** **BOTTLE FILLER AND** **DRINKING FOUNTAIN**

Heavy-duty vandal-resistant outdoor pedestal bottle filler and drinking fountain, configurable in multiple variations.



## **3690 Config WM** **WALL MOUNTED** **BOTTLE FILLER**

Barrier-free heavy-duty vandal-resistant outdoor wall mounted bottle filler.



**US/Canada**

Haws HQ • [www.hawsco.com](http://www.hawsco.com) • +1888.640.4297

**Latin America**

Haws LATAM • [www.hawsco.com.br](http://www.hawsco.com.br) • +55.11.4813.9977

**Asia Pacific**

Haws APAC • [www.haws.sg](http://www.haws.sg) • +65.6367.0359

**Europe/Middle East/Africa**

Haws EMEA • [www.haws.ch](http://www.haws.ch) • +41 (0) 34.420.6000



1455 KLEPPE LANE :: SPARKS, NV 89431

[www.hawsco.com](http://www.hawsco.com) :: 1.888.640.4297 :: +1.775.359.4712 :: fax: 1.775.359.7424 :: email: [info@hawsco.com](mailto:info@hawsco.com)

©2024 Haws :: All Rights Reserved :: REV 03/24