

FEATURES & BENEFITS

OPTIONS

For more information, visit www.hawesco.com or call (888) 640-4297.

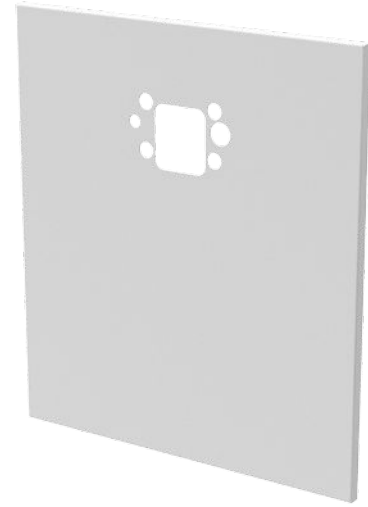

SPECIFICATIONS

Model BP15W is a versatile and decorative back panel for model 1920W that increases location visibility of the bottle filler, and also helps protect wall from inadvertent splash. This back panel is 15" x 17" (38 x 43 cm) stainless steel with a powder-coated white finish.

APPLICATIONS

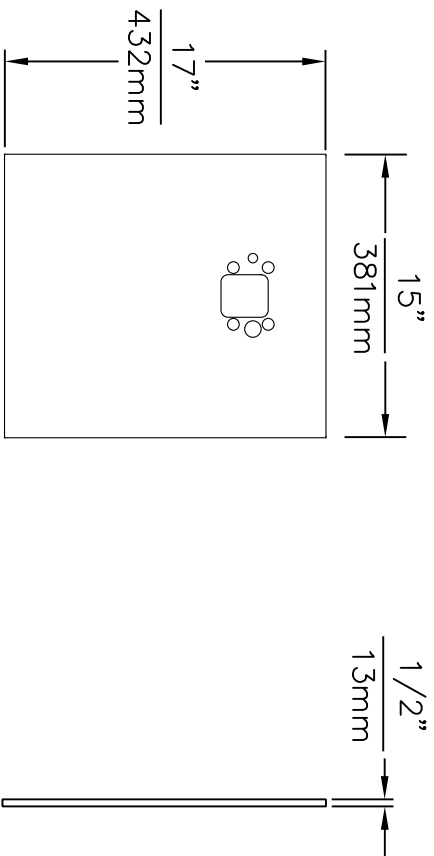

MODEL BP15 / BP15HPS / BP15W

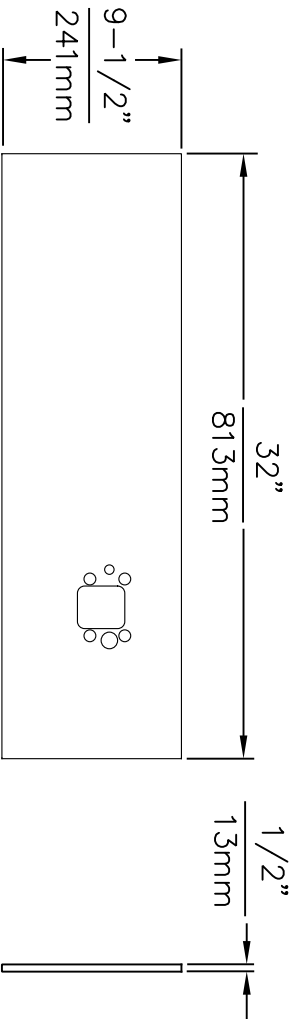

MODEL BP32 / BP32HPS / BP32W

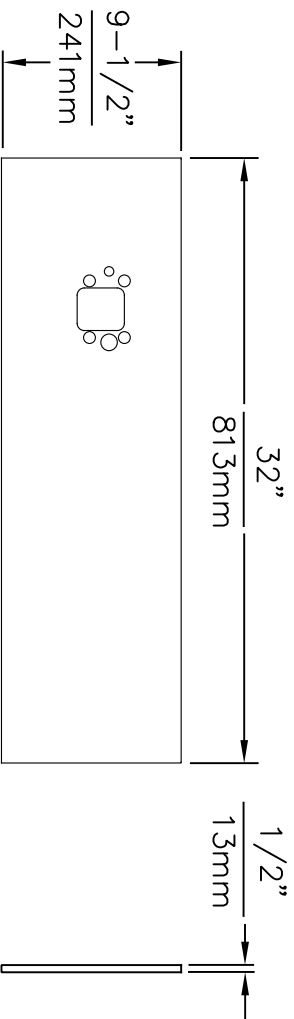

MODEL BP32R / BP32RW

NOTES:

1. WHEN INSTALLING THIS UNIT, LOCAL, STATE OR FEDERAL CODES SHOULD BE ADHERED TO.

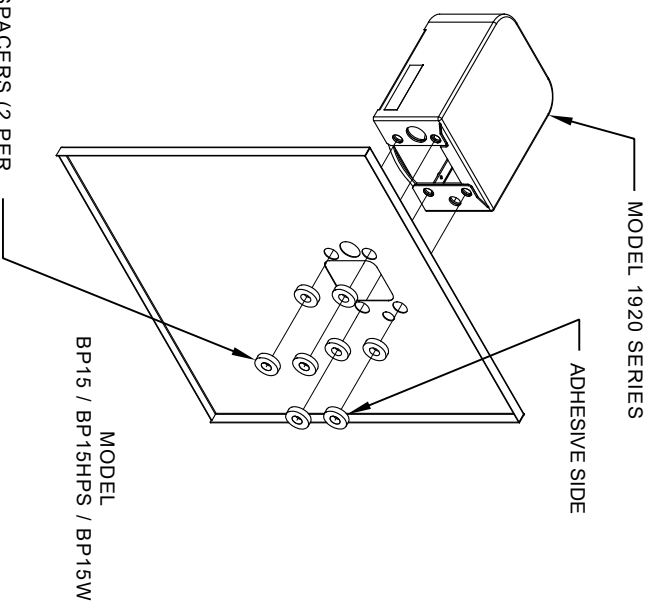

8 SPACERS (2 PER MOUNTING BOLT IF THE MOUNTING PLATE IS INSTALLED BEHIND THE FINISHED WALL. USE 1 SPACER PER BOLT FOR RETROFITS WHERE THE MOUNTING PLATE IS INSTALLED IN FRONT OF THE FINISHED WALL)

INSTALLATION OVER SINGLE FOUNTAIN
SHOWN FROM REAR

		MODEL(S)	
DRAWING: BACK PANEL, SPACER		DRAWING TYPE: INSTALLATION	
INSTALLATION, BOTTLE FILLER		SCALE: 1:1	
PART NUMBER: 0510000493		REVISION: 3	
1456 KLEPPE LANE SPARKS, NEVADA, 89431 (775) 359-4712 FAX (775) 359-7424 E-MAIL: HAWS@HAWSCO.COM WEBSITE: WWW.HAWSCO.COM		SIZE: A SHEET: 1 OF 2	

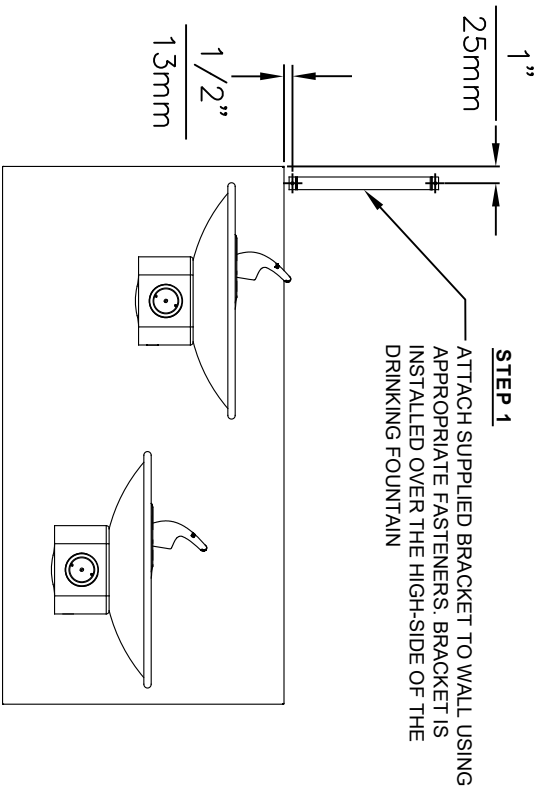

STEP 2
PLACE THE BACKPLATE AGAINST THE WALL AND SLIDE SIDEWAYS SO THE TABS CATCH UNDER THE BRACKET

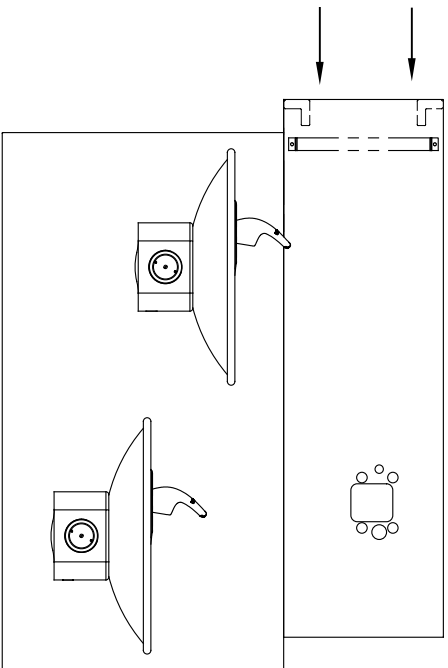

STEP 3
INSTALL THE BOTTLE FILLER PER THE INSTRUCTIONS SUPPLIED WITH THE UNIT

NOTES:
1. WHEN INSTALLING THIS UNIT, LOCAL, STATE OR FEDERAL CODES SHOULD BE ADHERED TO.

©2021 Haws Corporation - All Rights Reserved. HAWS® and other trademarks used in these materials are the exclusive property of Haws Corporation.

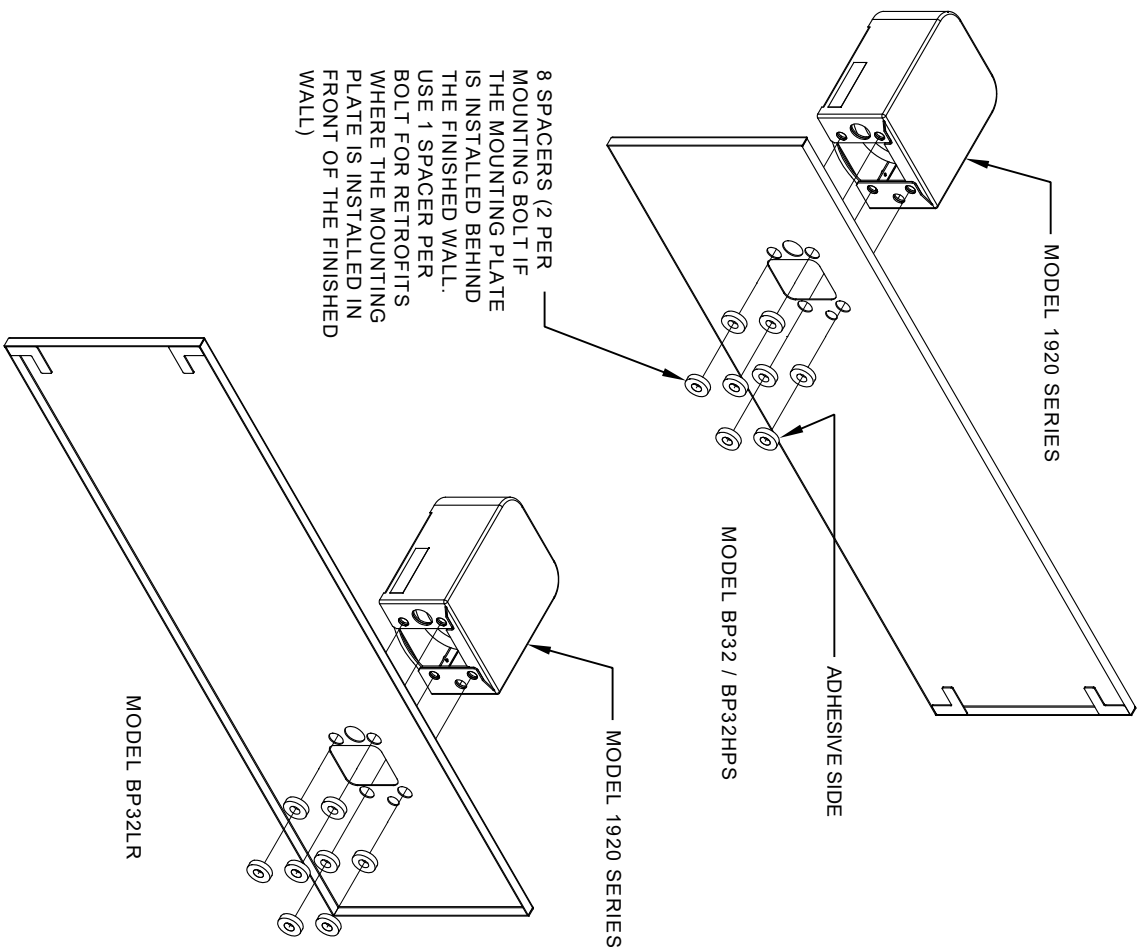

INSTALLATION OVER DOUBLE FOUNTAIN SHOWN FROM REAR

		MODEL(S)	
DRAWING, BACK PANEL, SPACER INSTALLATION, BOTTLE FILLER		SCALE: 1:1 DRAWING TYPE: INSTALLATION	
ECN NO. REVISED PER BY:	ECN. 5665 FV	DATE:	02/27/17
5081		CHKD:	JL
APPROVED:	FV	DATE:	03/04/21
1456 KLEPPE LANE SPARKS, NEVADA 89431 (775) 359-4712 FAX (775) 359-7424 E-MAIL: HAWS@HAWS.CO.COM WEBSITE: WWW.HAWS.CO.COM		PART NUMBER	0510000493
		REVISION	3
		SHEET	2 OF 2