

REPLACEMENT PARTS DRINKING FOUNTAIN

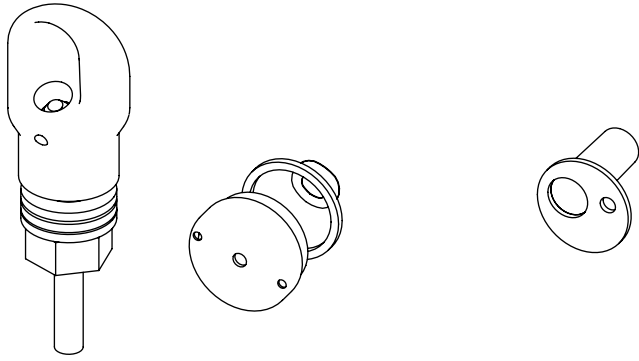

**MODEL 5703M
BUBBLER HEAD**

**MODEL 5874PB
PUSHBUTTON**

**MODEL VRK5874
VALVE REPAIR KIT**

REPLACEMENT PARTS BOTTLE FILLER

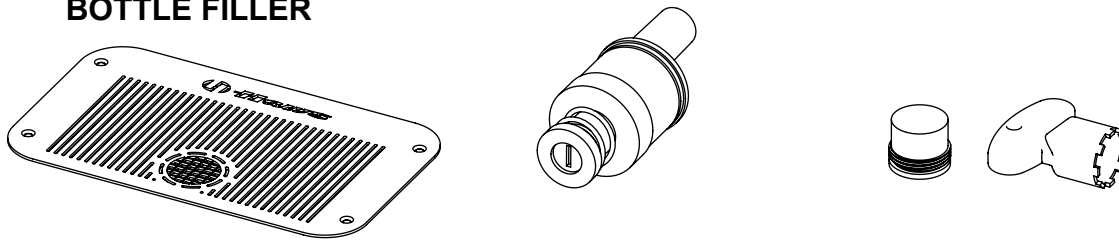

**0410000564
BOTTLE FILLER DRAIN
COVER PLATE**

**MODEL VRK5874HF
VALVE REPAIR KIT,
HIGH FLOW**

**MODEL VRKNOZ1
QTY 10 AERATORS
AND INSTALL TOOL**

REPLACEMENT PARTS FOUNTAIN & BOTTLE FILLER

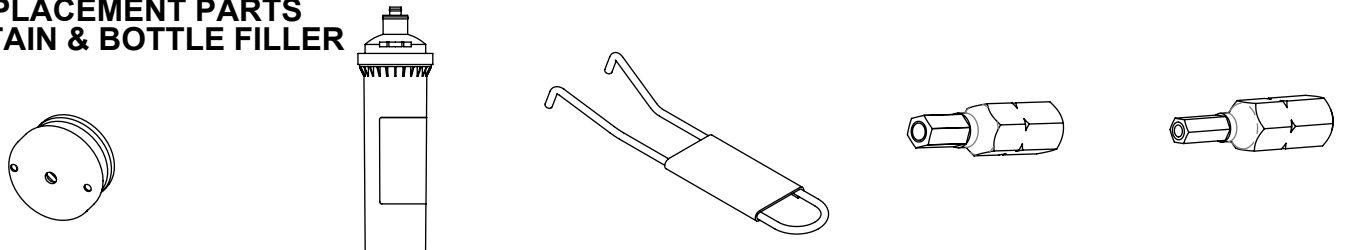

**MODEL PBA7
BUTTON ASSEMBLY**

**MODEL 6428
FILTER CARTRIDGE
(FOR 36XXF SERIES
MODELS)**

**0006983506
SPANNER WRENCH**

**0510001030
HEX BIT,
PINNED, 5/32"**

**0510001029
HEX BIT,
PINNED, 1/8"**

OPTIONAL ACCESSORIES

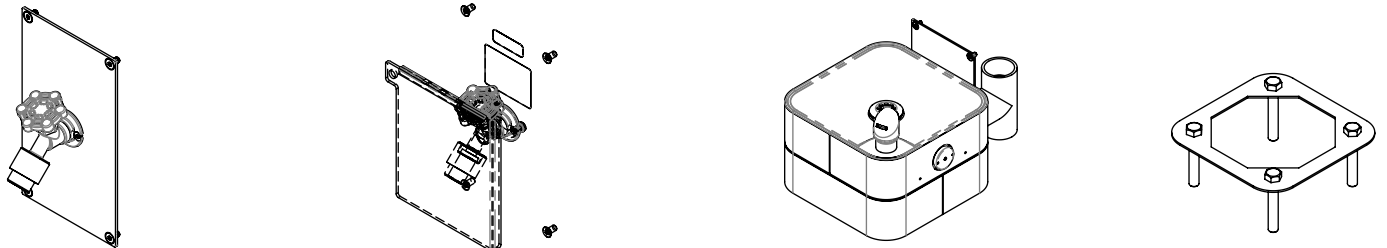

**MODEL 3661 HOSE BIB
(NOT FREEZE RESISTANT)**

**MODEL 3660 LOCKABLE HOSE BIB
(NOT FREEZE RESISTANT)**

**MODEL 3670 DOG BOWL
(NOT FREEZE RESISTANT)**

**MODEL MTG.3600
INSTALLATION AID**

3612BFA & 3612FBFA MODULAR OUTDOOR FOUNTAIN SYSTEM PARTS BREAKDOWN

		1455 KLEPPE LANE SPARKS, NEVADA 89431 (775) 359-4712 FAX (775) 359-7424 E-MAIL: HAWS@HAWS.CO.COM WEBSITE: WWW.HAWS.CO.COM	
ECN: 5804	REV. ECN: 5804	BY: JU	MODEL(S)
DRAWN: DHP	DATE: 6/11/20	CHKD: JU	3612BFA & 3612FBFA
APPROVED: DHP	DATE: 06/06/22	SCALE: 1:2	DRAWING TYPE: PARTS BREAKDOWN
WHEN ORDERING PARTS, PLEASE SPECIFY PART NUMBER			PART NUMBER 0510002056 REVISION 1
© 2022 Haws Corporation - All Rights Reserved. HAWS® and other trademarks used in these materials are the exclusive property of Haws Corporation.			SIZE: A SHEET 1 OF 2

AVAILABLE SUB COMPONENT MODELS

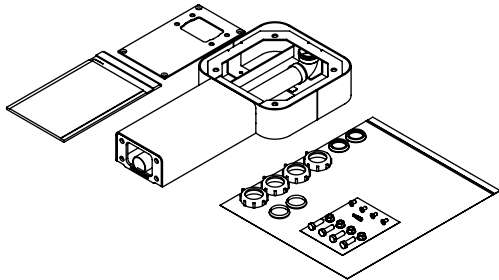

MODEL 3671 PEDESTAL ARM ASSEMBLY

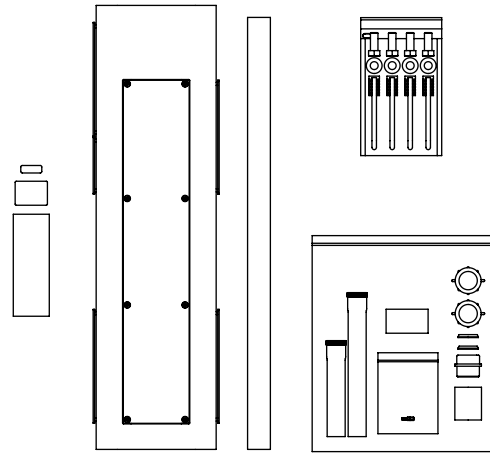

MODEL 3674 PEDESTAL ASSEMBLY

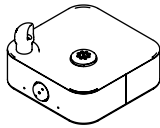

MODEL 3680 FOUNTAIN ASSEMBLY

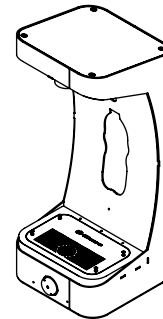

MODEL 3690 BOTTLE FILLER ASSEMBLY

3612BFA & 3612FBFA MODULAR OUTDOOR FOUNTAIN SYSTEM

PARTS BREAKDOWN

WHEN ORDERING PARTS, PLEASE
SPECIFY PART NUMBER

			1455 KLEPPE LANE SPARKS, NEVADA 89431 (775) 359-4712 FAX (775) 359-7424 E-MAIL: HAWS@HAWSO.COM WEBSITE: WWW.HAWSO.COM	
			PART NUMBER 0510002056	REVISION 1
ECN: 5804	REV. ECN: 5804	BY: JU	MODEL(S) 3612BFA & 3612FBFA	
DRAWN: DHP	DATE: 6/11/20	CHKD: JU		
APPROVED: DHP	DATE: 06/06/22		SCALE: 1:16	DRAWING TYPE: PARTS BREAKDOWN
			SIZE: A	SHEET 2 OF 2