

REPLACEMENT PARTS

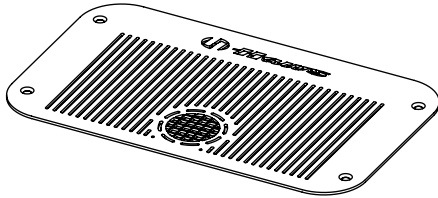

041000564
BOTTLE FILLER DRAIN
COVER PLATE

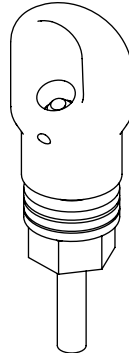

MODEL 5703M
BUBBLER HEAD



0110000641
AERATOR, FR
(FR MODELS ONLY)

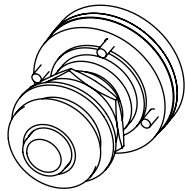

MODEL 5881PBA
BUTTON ASSEMBLY
(FR MODELS)

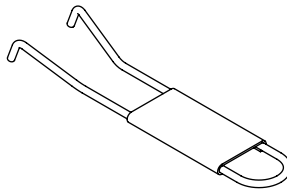

0006983506
SPANNER WRENCH
(NON FR MODELS)

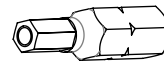

0510001030
HEX BIT,
PINNED, 5/32"

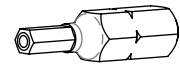

0510001029
HEX BIT,
PINNED, 1/8"

OPTIONAL ACCESSORIES

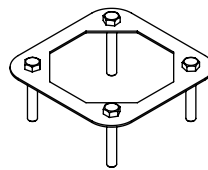

MODEL MTG.3600
INSTALLATION AID

3612FR
MODULAR OUTDOOR FOUNTAIN SYSTEM

PARTS BREAKDOWN

			1455 KLEPPE LANE SPARKS, NEVADA 89431 (775) 359-4712 FAX (775) 359-7424 E-MAIL: HAWS@HAWSO.COM WEBSITE: WWW.HAWSO.COM	
ECN: 5652	REV. ECN: 5945	BY: JU	MODEL(S)	PART NUMBER
DRAWN: DHP	DATE: 6/11/20	CHKD: JC	3612FR	0580001172
APPROVED: FV	DATE: 09/27/23			REVISION 4
SCALE: 1:2			DRAWING TYPE: PARTS BREAKDOWN	SIZE: A SHEET 1 OF 2

WHEN ORDERING PARTS, PLEASE
SPECIFY PART NUMBER

AVAILABLE SUB-COMPONENT MODELS

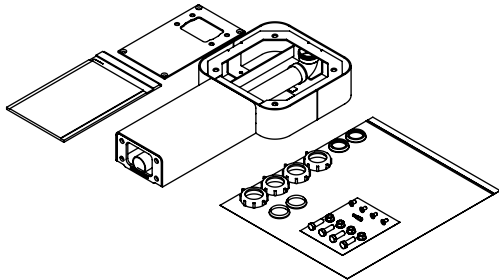

MODEL 3671 PEDESTAL ARM ASSEMBLY

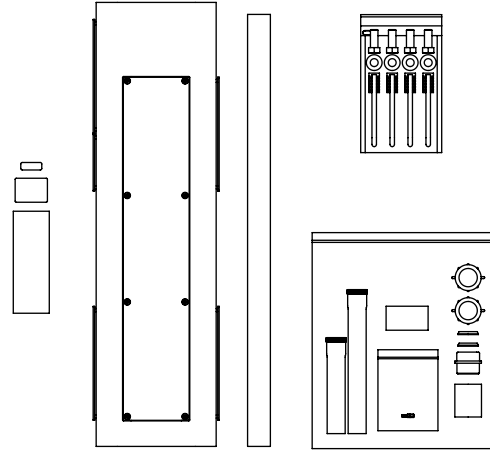

MODEL 3674 PEDESTAL ASSEMBLY

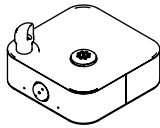

MODEL 3680FR* FOUNTAIN ASSEMBLY

(PUSH BUTTON SHOWN IS FOR REF. ONLY, ACTUAL PUSH BUTTON IS DIFFERENT STYLE)

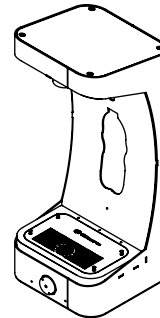

MODEL 3690FR* BOTTLE FILLER ASSEMBLY

(PUSH BUTTON SHOWN IS FOR REF. ONLY, ACTUAL PUSH BUTTON IS DIFFERENT STYLE)

**3612FR
MODULAR OUTDOOR
FOUNTAIN SYSTEM**

*FR (FREEZE RESISTANT) MODELS REQUIRE THE USE OF SEPARATE FREEZE RESISTANT VALVES (NOT SUPPLIED). SEE INSTALLATION DRAWINGS ON THE FOLLOWING PAGES FOR DETAILS.

PARTS BREAKDOWN

WHEN ORDERING PARTS, PLEASE SPECIFY PART NUMBER

		1455 KLEPPE LANE SPARKS, NEVADA 89431 (775) 359-4712 FAX (775) 359-7424 E-MAIL: HAWS@HAWS.CO.COM WEBSITE: WWW.HAWS.CO.COM							
		ECN: 5652	REV. ECN: 5945	BY: JU	MODEL(S) 3612FR	PART NUMBER 0580001172			
DRAWN: DHP	DATE: 6/11/20	CHKD: JC	APPROVED: FV	DATE: 09/27/23	SCALE: 1:16	DRAWING TYPE: PARTS BREAKDOWN	SIZE: A	REVISION 4	SHEET 2 OF 2