

REPLACEMENT PARTS BOTTLE FILLER

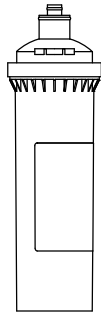

**MODEL 6428
FILTER CARTRIDGE
(FOR 36XXF SERIES
MODELS)**

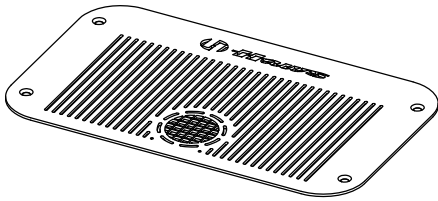

**0410000564
BOTTLE FILLER DRAIN
COVER PLATE**

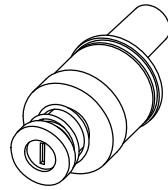

**MODEL VRK5874HF
VALVE REPAIR KIT,
HIGH FLOW**



**MODEL VRKNOZ1
QTY 10 AERATORS
AND INSTALL TOOL**

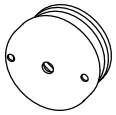

**MODEL PBA7
BUTTON ASSEMBLY**

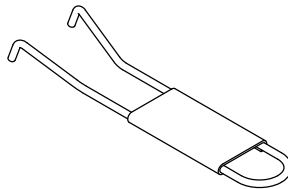

**0006983506
SPANNER WRENCH**

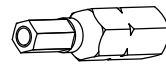

**0510001030
HEX BIT,
PINNED, 5/32"**

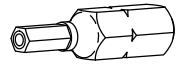

**0510001029
HEX BIT,
PINNED, 1/8"**

OPTIONAL ACCESSORIES

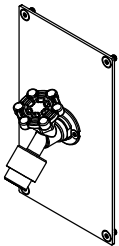

**MODEL 3661 HOSE BIB
(NOT FREEZE RESISTANT)**

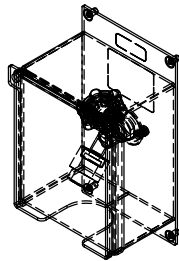

**MODEL 3660 LOCKABLE HOSE BIB
(NOT FREEZE RESISTANT)**

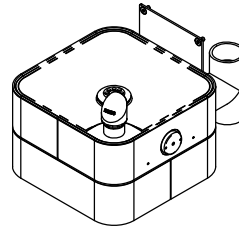

**MODEL 3670 DOG BOWL
(NOT FREEZE RESISTANT)**

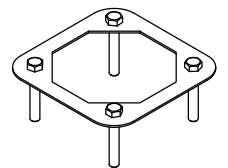

**MODEL MTG.3600
INSTALLATION AID**

3610 & 3610F MODULAR OUTDOOR FOUNTAIN SYSTEM PARTS BREAKDOWN

WHEN ORDERING PARTS, PLEASE
SPECIFY PART NUMBER

		1455 KLEPPE LANE SPARKS, NEVADA 89431 (775) 359-4712 FAX (775) 359-7424 E-MAIL: HAWS@HAWSO.COM WEBSITE: WWW.HAWSO.COM	
ECN: 5666	REV. ECN: 5719	BY: DP	MODEL(S) 3610 & 3610F
DRAWN: DHP	DATE: 6/11/20	CHKD: BJM	PART NUMBER 0510001188
APPROVED: FV	DATE: 09/16/21	SCALE: 1:2	REVISION 2
DRAWING TYPE: PARTS BREAKDOWN		SIZE: A	SHEET 1 OF 2

AVAILABLE SUB COMPONENT MODELS

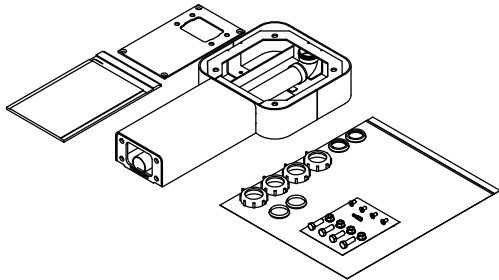

MODEL 3671 PEDESTAL ARM ASSEMBLY

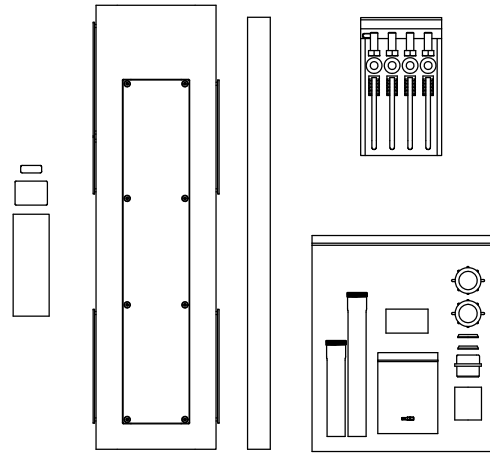

MODEL 3674 PEDESTAL ASSEMBLY

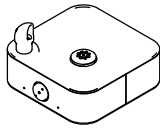

MODEL 3680 FOUNTAIN ASSEMBLY

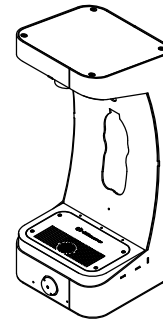

MODEL 3690 BOTTLE FILLER ASSEMBLY

3610 & 3610F MODULAR OUTDOOR FOUNTAIN SYSTEM

PARTS BREAKDOWN

WHEN ORDERING PARTS, PLEASE
SPECIFY PART NUMBER

			1455 KLEPPE LANE SPARKS, NEVADA 89431 (775) 359-4712 FAX (775) 359-7424 E-MAIL: HAWS@HAWSO.COM WEBSITE: WWW.HAWSO.COM	
ECN: 5666	REV. ECN: 5719	BY: DP	MODEL(S)	PART NUMBER
DRAWN: DHP	DATE: 6/11/20	CHKD: BJM	3610 & 3610F	0510001188
APPROVED: FV	DATE: 09/16/21		SCALE: 1:16	REVISION 2
			DRAWING TYPE: PARTS BREAKDOWN	SIZE: A
			SHEET 2 OF 2	