

REPLACEMENT PARTS DRINKING FOUNTAIN

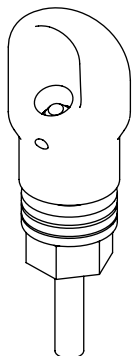

**MODEL 5703M
BUBBLER HEAD**

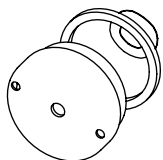

**MODEL 5874PB
PUSHBUTTON**



**MODEL VRK5874
VALVE REPAIR KIT**

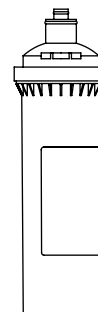

**MODEL 6428
FILTER CARTRIDGE
(FOR 36XXF SERIES
MODELS)**

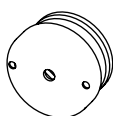

**MODEL PBA7
BUTTON ASSEMBLY**

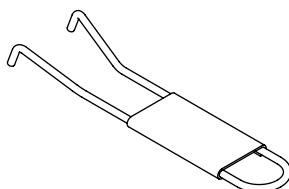

**0006983506
SPANNER WRENCH**

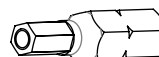

**0510001030
HEX BIT,
PINNED, 5/32"**

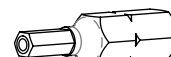

**0510001029
HEX BIT,
PINNED, 1/8"**

OPTIONAL ACCESSORIES

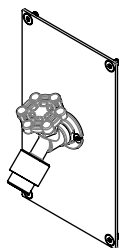

**MODEL 3661 HOSE BIB
(NOT FREEZE RESISTANT)**

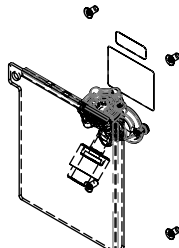

**MODEL 3660 LOCKABLE HOSE BIB
(NOT FREEZE RESISTANT)**

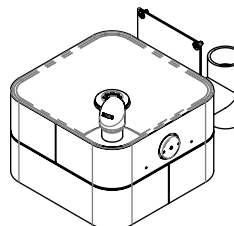

**MODEL 3670 DOG BOWL
(NOT FREEZE RESISTANT)**

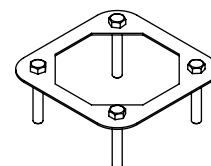

**MODEL MTG.3600
INSTALLATION AID**

3602 & 3602F MODULAR OUTDOOR FOUNTAIN SYSTEM PARTS BREAKDOWN

WHEN ORDERING PARTS, PLEASE
SPECIFY PART NUMBER

		1455 KLEPPE LANE SPARKS, NEVADA 89431 (775) 359-4712 FAX (775) 359-7424 E-MAIL: HAWS@HAWSO.COM WEBSITE: WWW.HAWSO.COM	
ECN: 5666	REV. ECN: 5822	BY: JU	MODEL(S)
DRAWN: DHP	DATE: 6/11/20	CHKD: BJM	3602 & 3602F
APPROVED: FV	DATE: 07/12/22	SCALE: 1:2	DRAWING TYPE: PARTS BREAKDOWN
			PART NUMBER: 0510001187
			REVISION: 3
			SHEET 1 OF 2

AVAILABLE SUB COMPONENT MODELS

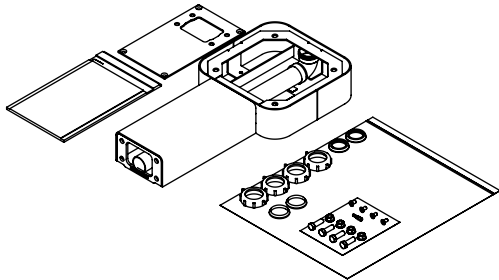

MODEL 3671 PEDESTAL ARM ASSEMBLY

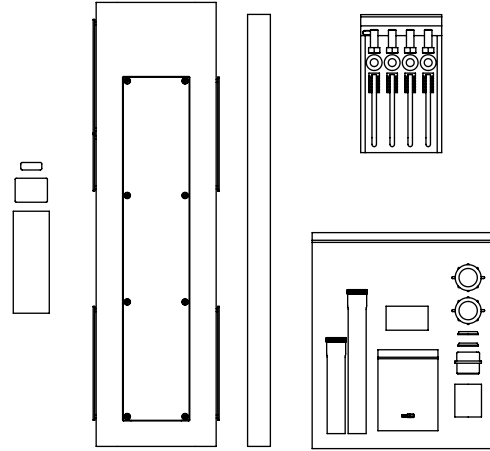

MODEL 3674 PEDESTAL ASSEMBLY

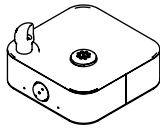

MODEL 3680 FOUNTAIN ASSEMBLY

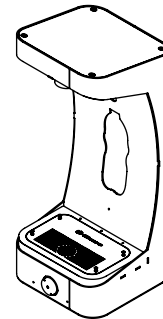

MODEL 3690 BOTTLE FILLER ASSEMBLY

**3602 & 3602F
MODULAR OUTDOOR
FOUNTAIN SYSTEM**

PARTS BREAKDOWN

WHEN ORDERING PARTS, PLEASE
SPECIFY PART NUMBER

		1455 KLEPPE LANE SPARKS, NEVADA 89431 (775) 359-4712 FAX (775) 359-7424 E-MAIL: HAWS@HAWSO.COM WEBSITE: WWW.HAWSO.COM						
		ECN: 5666	REV. ECN: 5822	BY: JU	MODEL(S) 3602 & 3602F	PART NUMBER 0510001187		
DRAWN: DHP	DATE: 6/11/20	CHKD: BJM	APPROVED: FV	DATE: 07/12/22	SCALE: 1:16	DRAWING TYPE: PARTS BREAKDOWN	SIZE: A	SHEET 2 OF 2
						REVISION 3		