

NOTES:

1 ENSURE TUBE IS DISCONNECTED FROM PUSH BUTTON VALVE BODY PRIOR TO REMOVAL. APPLY ONE DROP OF LOCTITE 222MS TO NOZZLE THREADS PRIOR TO FASTENING BACK ONTO BUBBLER HEAD. RE-ATTACH TUBE TO VALVE.

2 ITEMS 13 THRU 17 ARE OPTIONAL AND CAN BE CONFIGURED TO ADD EITHER A HANDS-OFF (1920HO) OR PUSH BUTTON (1920) BOTTLE FILLER, MOUNTED ON R.H. SIDE OF BACK PANEL (BP32) OR L.H. SIDE (REVERSED) OF BACK PANEL (BP32R) ON DUAL FOUNTAIN MODEL 1117.

ITEM	DESCRIPTION	PART NO.
1	VALVE REPAIR KIT	VRK5874
2	PUSH BUTTON ASSY	PBA6
3	BUBBLER HEAD ASSY, PCP	5703M
4	STRAINER, WASTE ASSY	6462
5	TRAP	0005982900
**	6 MOUNTING FRAME	MTGFR.LG
7	PLATE BOTTOM	PBM1107
8	BACK PANEL 1117	0410000218
9	GRILLE 1117 P/N	0002626651
**	10 CHILLER, REMOTE	HCR8
11	SPANNER WRENCH	0006983506
12	KEY HEX F/PINNED HEX	0002981127
13	PLATE MOUNTING	6700
14	BOTTLE FILLER, HANDS-OFF	1920HO
15	BOTTLE FILLER	1920
16	BACK PANEL FOR 1920 OVER DUAL FOUNTAIN	BP32
17	BACK PANEL BF 32 REVERSED	BP32R

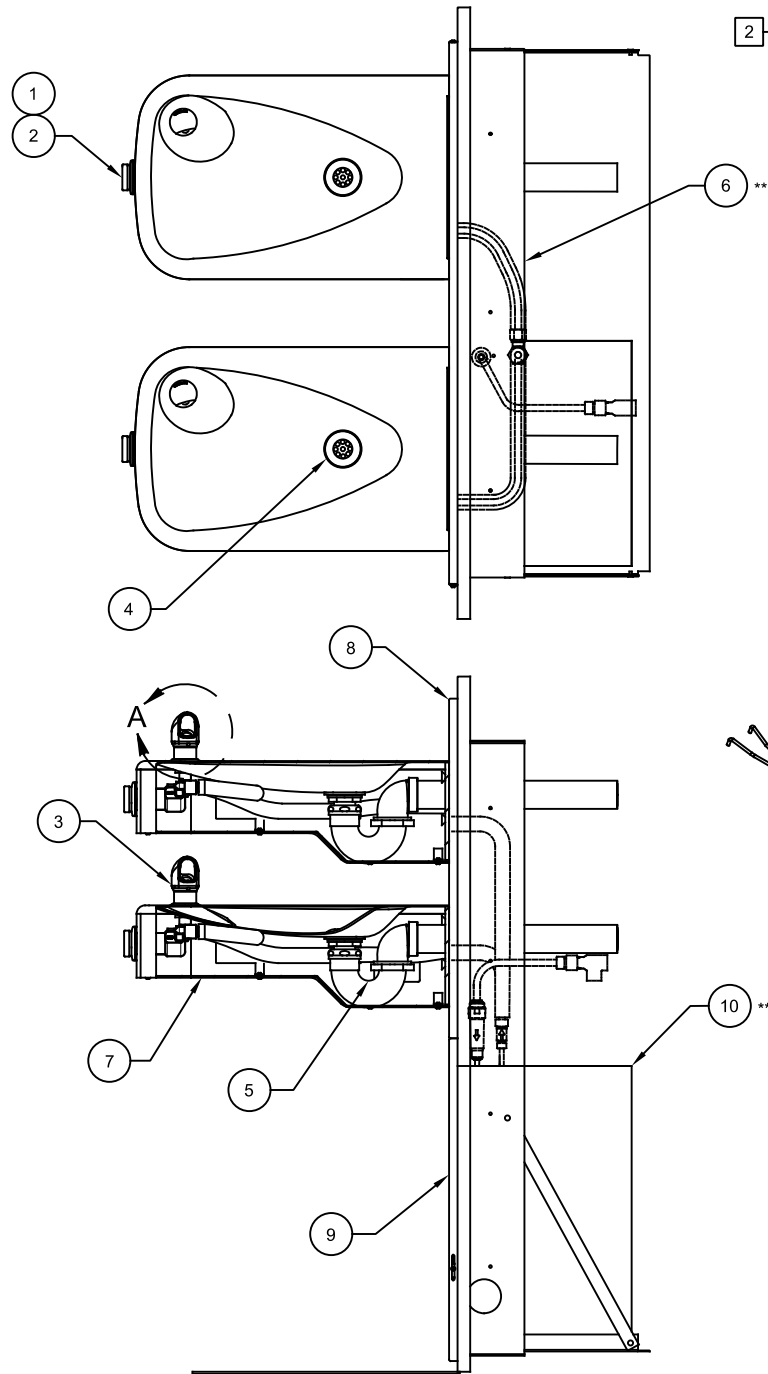

\*\* REQUIRED - SOLD SEPARATELY

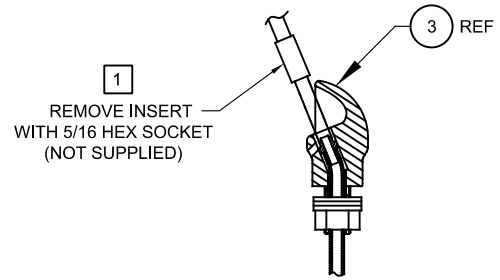

DETAIL A  
ROTATED 90° INTO VIEW

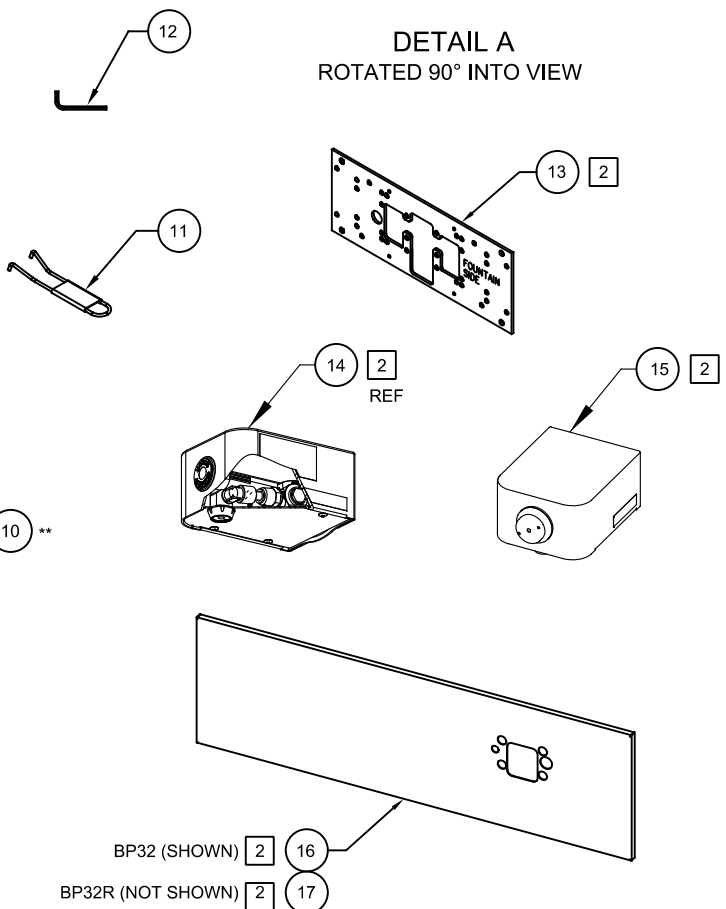

# PARTS BREAKDOWN

WHEN ORDERING PARTS PLEASE SPECIFY MODEL NUMBER.

		1455 KLEPPE LANE SPARKS, NEVADA 89431 (775) 359-4712 FAX (775) 359-7424 E-MAIL: HAWS@HAWS.CO.COM WEBSITE: WWW.HAWS.CO.COM	
ECN NO. 5671	REVISED PER ECN: 6148	BY JG	MODEL(S) 1117.8
DRAWN DP	DATE 03/23/21	CHKD JG	PART NUMBER 0510001192
APPROVED FV	DATE 02/11/25	SCALE: N/A	REVISION 5
DRAWING TYPE: PARTS BREAKDOWN		SIZE: A	SHEET 1 OF 1