

FEATURES & BENEFITS

CONSTRUCTION

Unit is made of 18 gauge Type 304 stainless steel with a satin finish that resists stains and corrosion, and has soft, rounded corners. Unit features stainless steel satin finish back panel, vandal-resistant bottom plate, and 1-1/4" integral trap.

VANDAL RESISTANT

The bubbler heads, push button, drain strainers and bottom plates are locked in place, discouraging unwanted vandal tampering.

TAMPER RESISTANT

30-second obstruction time-out to reduce tampering of sensor.

BUBBLER HEADS

Polished chrome-plated brass bubbler heads with integral 11/16" dia. basin shank and stainless anti-rotation roll pin for vandal resistance strength. Shielded, angled stream opening provides a steady, sanitary source of drinking water at .45 gpm.

DRINKING FOUNTAIN VALVES

Fountain incorporates a touchless sensor operated stainless steel solenoid valve controlled by a transformer on one side and a push-button activated valve which offers the only all stainless steel valve body that is machined out of solid bar stock and is fully serviceable through the front of the push button assembly offering access to the water control cartridge and integral water supply strainer on the other.

MOUNTING

Heavy-duty 16-gauge galvanized steel mounting frame with welded-in heavy-duty 10 gauge mounting plate with pre-punched mounting holes. Further convenience is given to the chiller with the integral fold-out shelf.

OPTIONS

- Bottle Filler: Model 1920HO, bottle filler can be a stand-alone station, or mounted above Haws 1117LN series drinking fountain models.
- Bottle Filler Stand: Model BTL1107, add-on stainless steel stand to place bottle on when 1920HO bottle filler is used.
- Back Panel: Model BP32, satin finish stainless steel 32" back panel for model 1920 bottle filler.
- Cane Detection, Floor Mounted: Model SK6, floor mounted cane detection for the Haws Hi-Lo drinking fountains.

For more information, visit www.hawscos.com or call (888) 640-4297.



REQUIRED MODELS

Model H1119.8HO electric vandal-resistant ADA wall mounted combination motion activated/push button drinking fountain shall include dual 18 gauge Type 304 Stainless Steel satin finish basins, touchless sensor operated solenoid valve with 30-second obstruction time-out on one side, and push-button operated stainless steel valve with front-accessible cartridge and flow adjustment on the other, 100% lead-free waterways, polished chrome-plated brass vandal-resistant bubbler heads, polished chrome-plated brass vandal-resistant waste strainers, vandal-resistant bottom plates, stainless steel satin finish back panel and louvered intrusion-proof grill, high and low fountain mounting levels, and 1-1/4" NPT traps. The R-134a refrigeration system is hermetically sealed and delivers a minimum of 8 gph (30.3 L) of water at 50° F (10° C) cooled from 80° F (26.7° C) inlet water at 90° F (32.2° C) ambient. 115 Volts, 60Hz, rated watts: 370, full load amps: 5

REQUIRES MODEL HCR8 and MTGFR.LG PRICED SEPARATELY.

FOR INDOOR USE ONLY

SPECIFICATIONS

Perfect for either public or private settings, our stainless steel electric drinking fountains are a great fit in indoor environments. Specifically, this type fountain may be placed in settings such as: schools, office buildings, shopping malls, and other indoor environments. Electric water coolers are not recommended or designed for outdoor applications or enclosed pool areas (chlorine). These conditions may void warranty. Model meets all current Federal Regulations for the disabled including those in the Americans with Disabilities Act. Haws manufactures drinking fountains, faucets and electric water coolers to be lead-free by all known definitions including NSF/ANSI/CAN 61- Section 9, NSF/ANSI/CAN 372, California Proposition 65, and the Federal Safe Drinking Water Act. Product is compliant to California Health and Safety Code 116875 (AB 1953-2006), and 116876 (AB 100) "NSF/ANSI/CAN 61: Q ≤ 1". Haws electric water coolers comply with ARI Standard 1010 and ANSI A117.1, and are listed by Underwriter Laboratories to U.S. and Canadian standards.



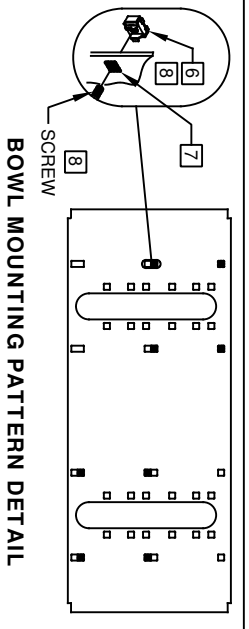

IMPORTANT: MOUNTING FRAME MUST BE INSTALLED SO THAT LIP OF FRAME BUTTS AGAINST FINISHED WALL FACE.

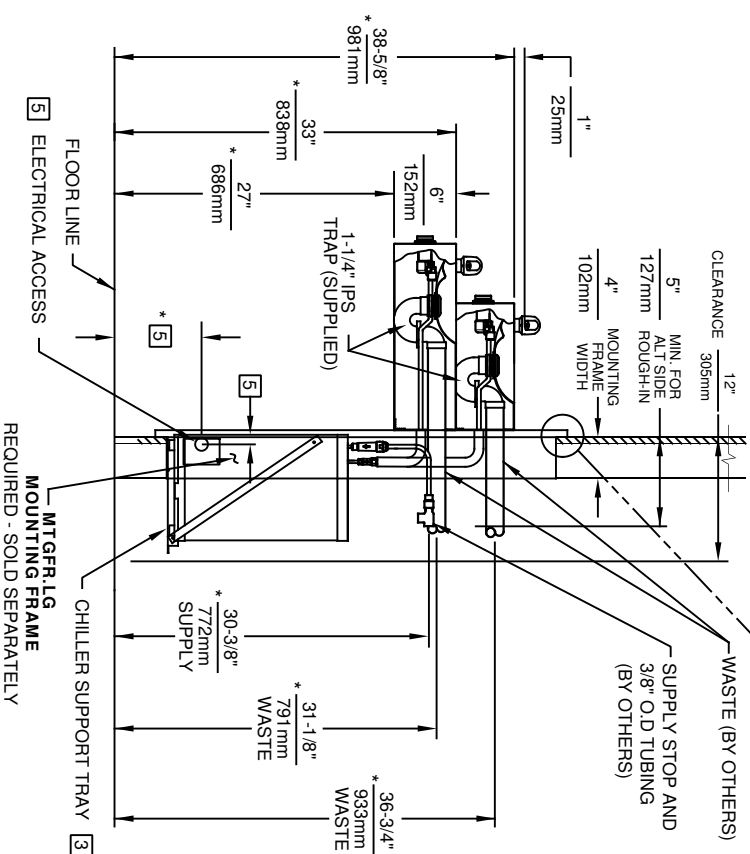

EON NO. REVISED PERMITS:		MODEL(S)	
DRAWN: F. VASQUEZ	DATE: 09-01-98	ECN: 5527	FLY
APPROVED: FV	DATE: 04/02/20	REVISION	PART NUMBER
SCALE: 1:19	DRAWING TYPE	INSTALLATION	SIZE: A SHEET 1 OF 1
H1119.8		22	

NOTES:

1. 2RKHO.P AND 2RKHO.H RETROFIT KITS ALLOW INDOOR FOUNTAINS TO BE CONVERTED FROM A HAWS 5874 PUSH BUTTON VALVE TO HANDS-OFF (TOUCHLESS) OPERATION.
FOUNTAINS (NOT SUPPLIED) MAY BE MOUNTED ON THE EXTERNAL WALL OF A BUILDING PROVIDED THE TRANSFORMER SHALL BE MOUNTED INSIDE THE WALL AND PROTECTED FROM WATER AS SHOWN IN THIS INSTALLATION PER NEC/CEC AND LOCAL CODE. AVOID DIRECT CONTACT WITH SUNLIGHT ON THE SENSOR LENS.
2. RETROFIT KIT MODEL:
2RKHO.P: INDOOR HO RETRO-FIT KIT (INCLUDES 2X HO SENSOR WITH MOUNTING HARDWARE, 2X SOLENOID VALVE, 2X REGULATOR, WIRE SPLITTER, AND 100-240V PLUG-IN TRANSFORMER - SEE SHEET 2).
2RKHO.H: INDOOR HO RETRO-FIT KIT (INCLUDES 2X HO SENSOR WITH MOUNTING HARDWARE, 2X SOLENOID VALVE, 2X REGULATOR, WIRE SPLITTER, AND 100-277V HARDWIRE TRANSFORMER - SEE SHEET 3).
3. 2RKHO.P REQUIRES 100-240VAC POWER CONNECTION. 2RKHO.H REQUIRES 100-277V POWER CONNECTION.
4. TRANSFORMERS MUST BE MOUNTED SUCH THAT THEY ARE PROTECTED FROM WATER.
5. 2RKHO.P TRANSFORMER IS COMPATIBLE WITH TYPE A AND TYPE B NORTH AMERICAN ELECTRICAL OUTLETS. FOR OTHER RECEPTACLE TYPES, AN ADAPTER (NOT SUPPLIED) MUST BE PROVIDED BY OTHERS.

(NOTES CONTINUED ON SHEET 4)

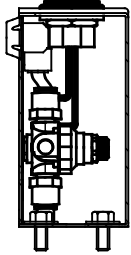

EXAMPLE 1920 BOTTLE FILLER INSTALLATION

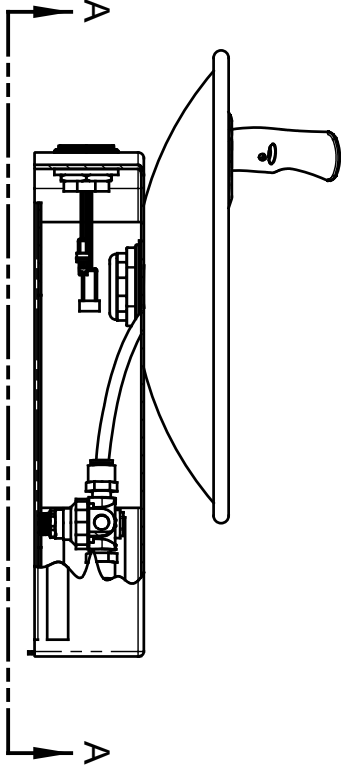

EXAMPLE 1011 FOUNTAIN INSTALLATION

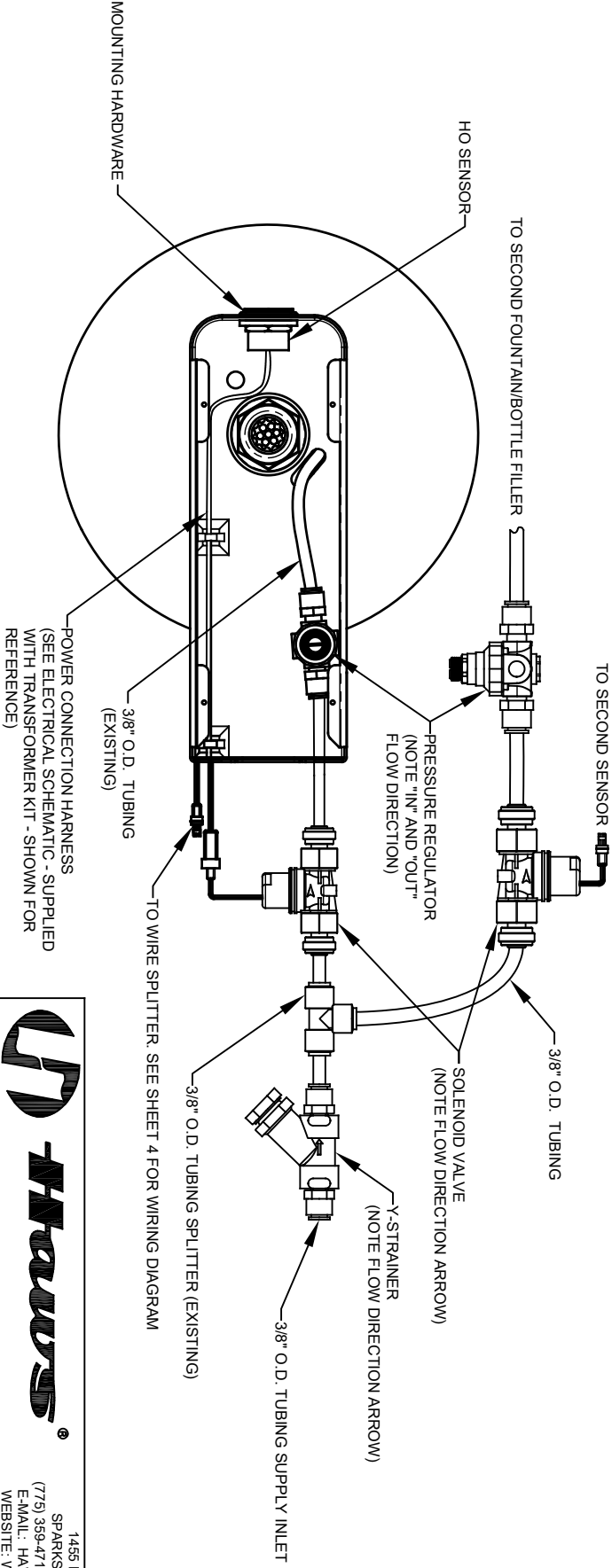

VIEW A - A

(BOTTOM PLATE OMITTED FOR CLARITY)

		MODEL(S)		1456 KLEPPE LANE	
2RKHO.P / 2RKHO.H		DUAL HANDS-OFF RETRO-FIT KIT		SPARKS, NEVADA 89431	
102021		SCALE: N/A		(775) 359-4712 FAX (775) 359-7424	
DATE: 02/10/21		INSTALLATION		E-MAIL: HAWS@HAWS.CO.COM	
DATE: 02/10/21		SIZE: A		WEBSITE: WWW.HAWS.CO.COM	
DATE: 02/10/21		SHEET 1 OF 4		PART NUMBER	
DATE: 02/10/21		REVISION		0580001156.D	
DATE: 02/10/21		4		REVISION	
DATE: 02/10/21		4		REVISION	

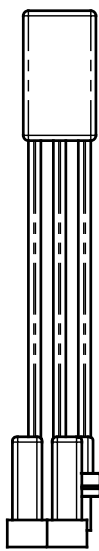

DUAL POWER SPLITTER

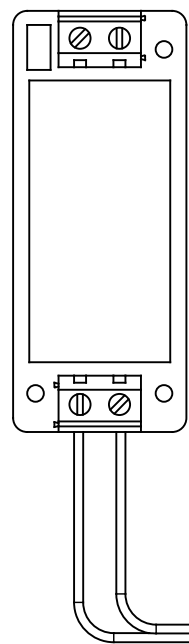

HARDWARE TRANSFORMER
VRKH08

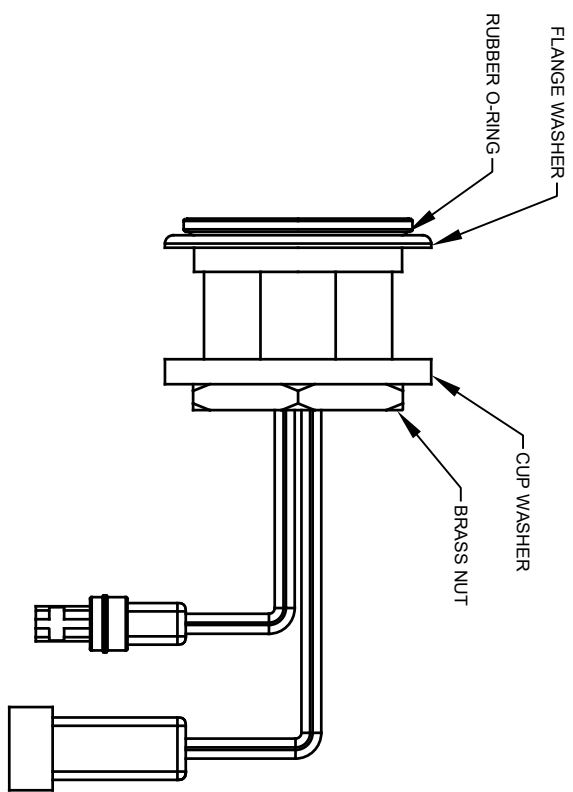

HO SENSOR ASSEMBLY (2X)
VRKH06

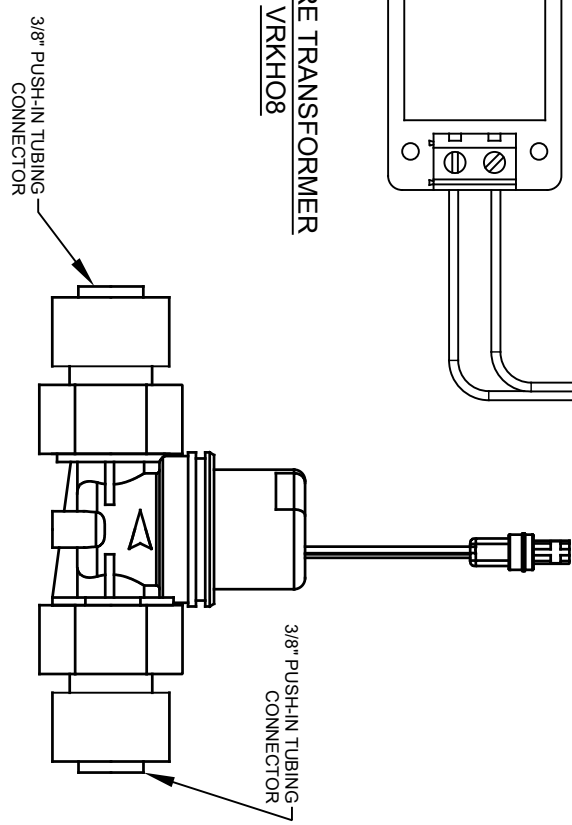

SOLENOID VALVE ASSEMBLY (2X)
VRKH05

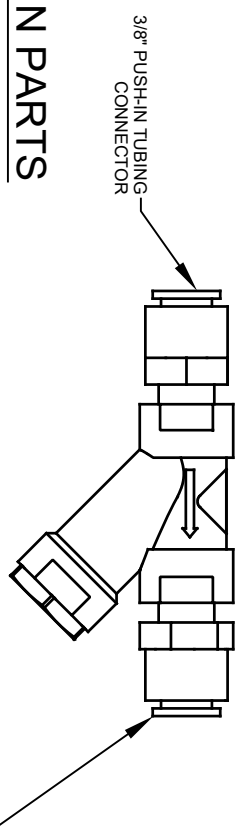

Y-STRAINER
6433

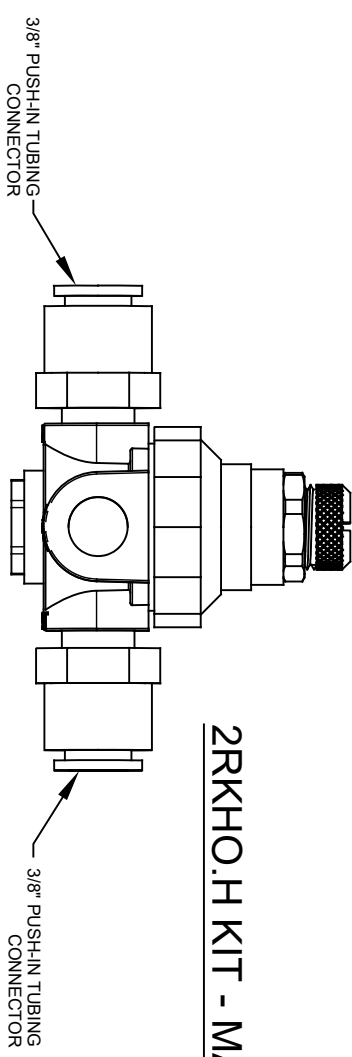

VALVE REGULATOR (2X)
5867

2RKHO.H KIT - MAIN PARTS

**Haws**[®]

1456 KLEPPE LANE
SPARKS, NEVADA 89431
(775) 359-4712 FAX (775) 359-7424
E-MAIL: HAWS@HAWS.CO.COM
WEBSITE: WWW.HAWS.CO.COM

ECN NO. REVISED PER BY:		MODEL(S)	
5849	ECN: 5749	2RKHO.P / 2RKHO.H	
DATE:	DATE:	DATE:	
02/10/21	02/10/21	02/10/21	
DATE:	DATE:	DATE:	
02/10/21	02/10/21	02/10/21	
APPROVED:		SCALE:	
BIM		N/A	
DRAWING TYPE:		INSTALLATION:	
DUAL HANDS-OFF RETRO-FIT KIT		SIZE: A	
PART NUMBER		SHEET 3 OF 4	
0580001156.D		REVISION: 4	