

ITEM	DESCRIPTION	PART NO.
1	BOLT U 5/16-18 (QTY. 2)	---
2	CLAMP 9037 (QTY. 2)	---
3	BLOCK W/SLOT 9037 (QTY. 2)	---
4	NUT 5/16-18 HEX (QTY. 4)	---
5	WASHERS 5/16" (QTY. 4)	---
6	LOOP CURTAIN HALF 9037 (QTY. 2)	---
7	SCREW 3/8-24 X 5/8" (QTY. 2)	---
8	NUT 3/8-24 (QTY. 2)	---
9	CURTAIN 9037 (QTY. 1)	---
10	CLIPS 9037 (QTY. 16)	---
11	MODESTY GOWN (QTY. 1)	---
12	INSTALLATION INSTRUCTIONS (QTY.1)	---

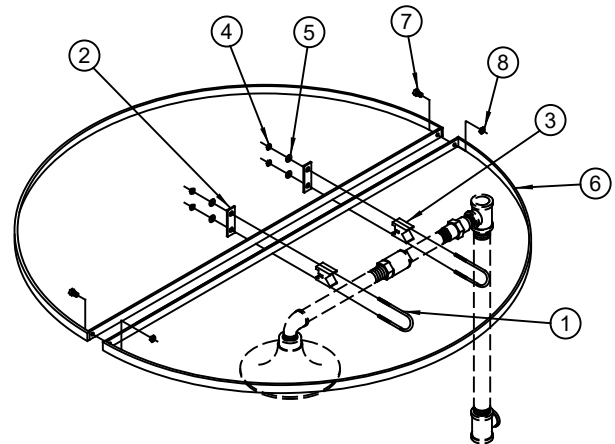
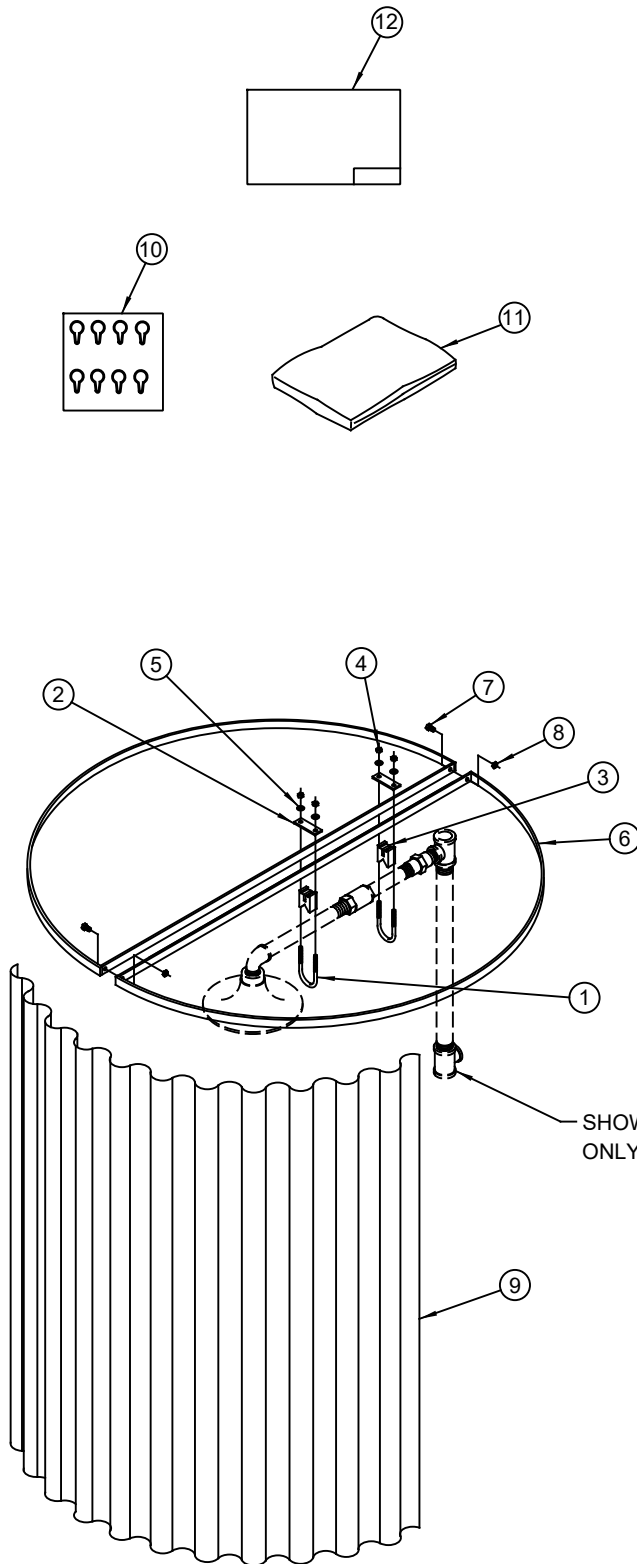

OPTIONAL INSTALLATION SET-UP
(SIDE MOUNTED)

SHOWERS SHOWN FOR REFERENCE
ONLY (NOT SUPPLIED).

PARTS BREAKDOWN

WHEN ORDERING PARTS PLEASE SPECIFY MODEL NUMBER.

		1455 KLEPPE LANE SPARKS, NEVADA 89431 (775) 359-4712 FAX (775) 359-7424 E-MAIL: HAWS@HAWS.CO.COM WEBSITE: WWW.HAWS.CO.COM	
		ECN NO. REVISED PER BY ECN: 5796 FV	MODEL(S) 9037
DRAWN C.H.	DATE 06/01/96	CHKD KM	REVISION 8
APPROVED FV	DATE 04/20/22	SCALE: N/A	DRAWING TYPE: PARTS BREAKDOWN
SIZE: A		SHEET 1 OF 1	