

MOUNTING FRAME INSTALLATION:

- HOLD ROUGH-IN DIMENSIONS ± 1/8" (3.2mm)
- WHEN INSTALLING THIS UNIT, LOCAL, STATE OR FEDERAL CODES SHOULD BE ADHERED TO. FOR DIFFERENT INSTALLATION HEIGHTS OTHER THAN SHOWN, DIMENSIONS MARKED (*) MUST BE ADJUSTED ACCORDINGLY.
- ALIGN HOLES IN CHILLER SUPPORT TRAY WITH HOLES IN FRAME AND FASTEN IN PLACE WITH #10 SHEET-METAL SCREWS SUPPLIED WITH UNIT.
- REFER TO MODEL 1107.8 INSTALLATION DRAWING FOR COMPLETED FOUNTAIN AND PLUMBING ROUGH-IN DIMENSIONS.
- INSERT 5/16"-18 PANEL NUT RETAINERS (SUPPLIED WITH FOUNTAIN) FROM OPPOSITE SIDE OF OPENINGS.
- FOUNTAIN REMOVAL: FIRST REMOVE SCREWS AND THEN SQUEEZE CLIPS ON NUT RETAINER (SUPPLIED WITH FOUNTAIN) TO POP OUT. INSTALL IS REVERSE OF REMOVAL.
- ROUGH-IN DIMENSIONS FOR FOUNTAIN HEIGHTS:

CHILD WHEELCHAIR HEIGHT:
 FRAME ROUGH-IN HEIGHT: 3-1/8" (79mm)
 ELECTRICAL ACCESS: 6-5/8" (168mm)

ADULT WHEELCHAIR HEIGHT:
 FRAME ROUGH-IN HEIGHT: 6-1/8" (156mm)
 ELECTRICAL ACCESS: 9-5/8" (245mm)

ADULT STANDING HEIGHT:
 FRAME ROUGH-IN HEIGHT: 11-5/8" (295mm)
 ELECTRICAL ACCESS: 15-1/8" (384mm)

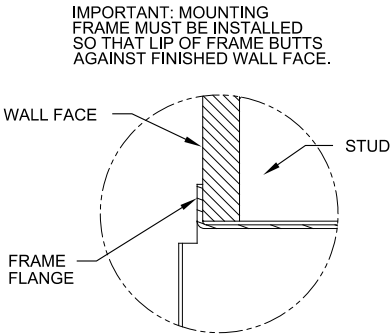

DETAIL A

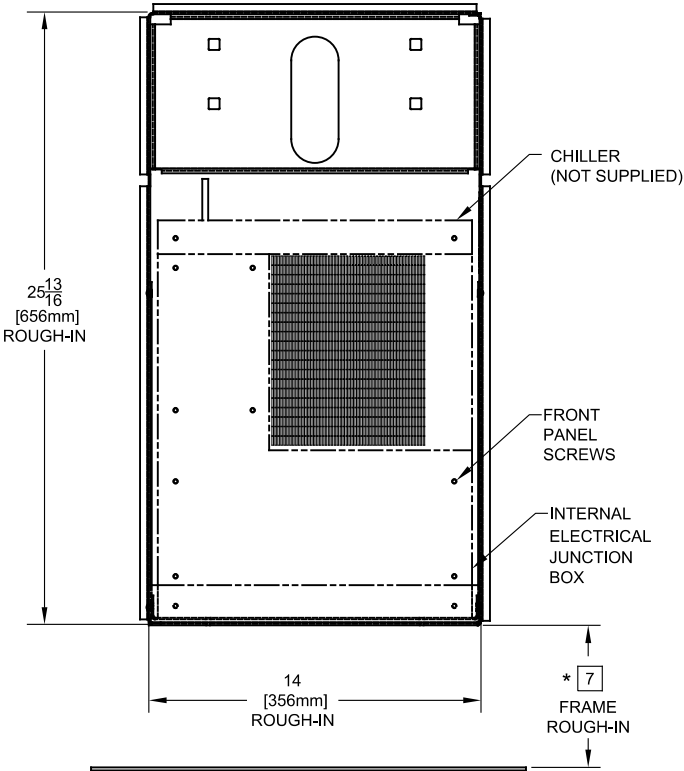

CHILLER ELECTRICAL INSTALLATION:

- ENSURE ELECTRICAL POWER IS OFF AND POWER MATCHES VOLTAGE, PHASE AND CYCLE LISTED ON CHILLER LABEL
- REMOVE FRONT PANEL TO GAIN ACCESS TO INTERNAL JUNCTION BOX.
- HARDWIRE CHILLER THROUGH ITS SIDE. WIRE IN ACCORDANCE WITH LOCAL, STATE OR FEDERAL ELECTRICAL CODES.
- REPLACE FRONT PANEL. DO NOT APPLY POWER UNTIL UNIT WATER SUPPLY IS CONNECTED AND ON.

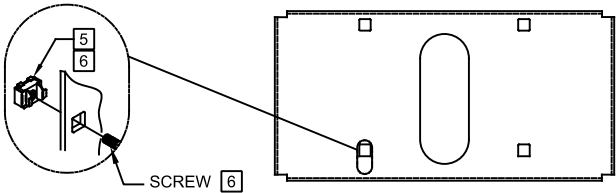
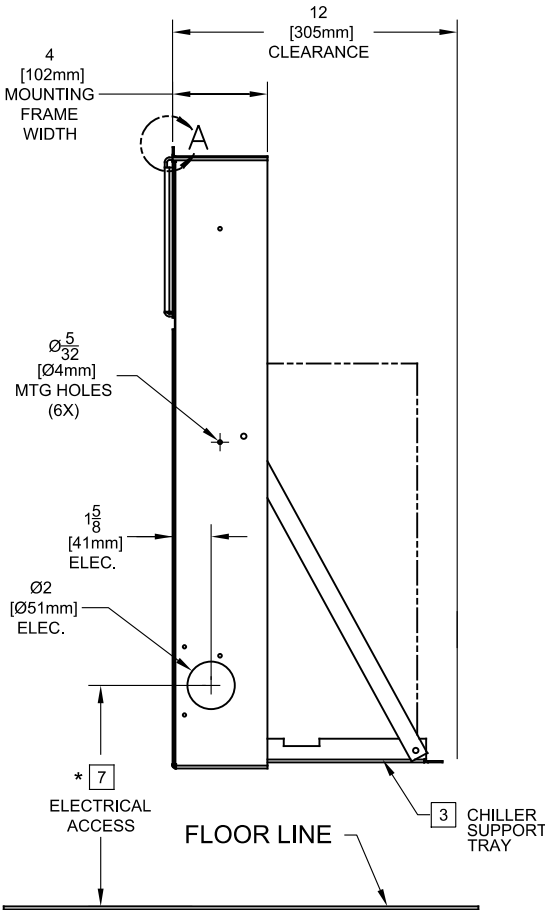

BOWL MOUNTING DETAIL



1455 KLEPPE LANE
 SPARKS, NEVADA 89431
 (775) 359-4712 FAX (775) 359-7424
 E-MAIL: HAWS@HAWS.CO.COM
 WEBSITE: WWW.HAWS.CO.COM

ECN NO.	REVISED PER	BY:	MODEL(S)	PART NUMBER
	ECN: 6148			0002080010
DRAWN:	DATE:	CHK'D:	MTGFR.7	REVISION
C.FENNER	12-13-06			4
APPROVED:	DATE:		SCALE: 1:1	DRAWING TYPE: INSTALLATION
FV	02/12/25		SIZE: A	SHEET 1 OF 1