

STEP 1

PLACE BACK PANEL ON TOP OF INSTALLED (EXISTING) DRINKING FOUNTAIN (IF APPLICABLE). MARK THE HOLE LOCATIONS ONTO THE WALL (SEE NOTE 1 BELOW).

BP15/BP15HPS/BP15W BACK PANEL (SINGLE) SHOWN FOR REFERENCE ONLY (NOT SUPPLIED).

BP15C/BP15WC ARE ONE-PIECE BACK PANELS (NOT SHOWN AND NOT SUPPLIED) USED FOR MOUNTING BOTH BOTTLE FILLER AND DRINKING FOUNTAIN ON SAME PANEL AND REQUIRE TWO 6700R MOUNTING PLATES.

MARK THESE HOLE LOCATIONS

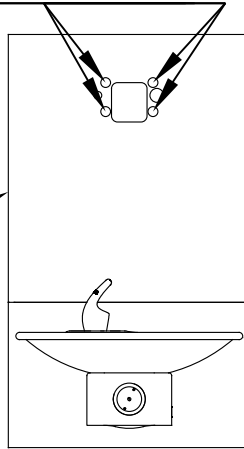

STEP 2

LINE UP THE 6700R MOUNTING PLATE(S) OVER THE MARKED HOLES. ATTACH THE PLATE(S) TO THE WALL USING APPROPRIATE ANCHORS.

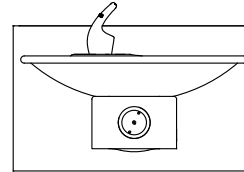
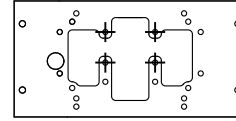

DRINKING FOUNTAIN & BACK PANEL SHOWN FOR REFERENCE ONLY (NOT SUPPLIED)

STEP 3

INSTALL THE BOLTS IN THE MOUNTING PLATE(S) BY SECURING WITH NUTS AND WASHERS. RECESS FOR THE REAR NUTS MAY BE REQUIRED.

INSTALLATION STEPS SHOWN ARE FOR SINGLE BOTTLE FILLER PANEL BUT CAN BE APPLIED TO ONE-PIECE PANEL (COMBINATION BOTTLE FILLER AND DRINKING FOUNTAIN) USED FOR CHILD HEIGHT APPLICATIONS.

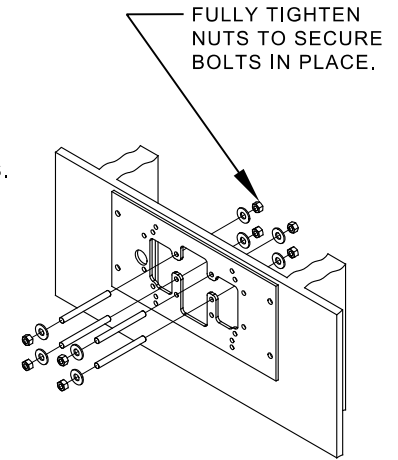

MODEL 6700R

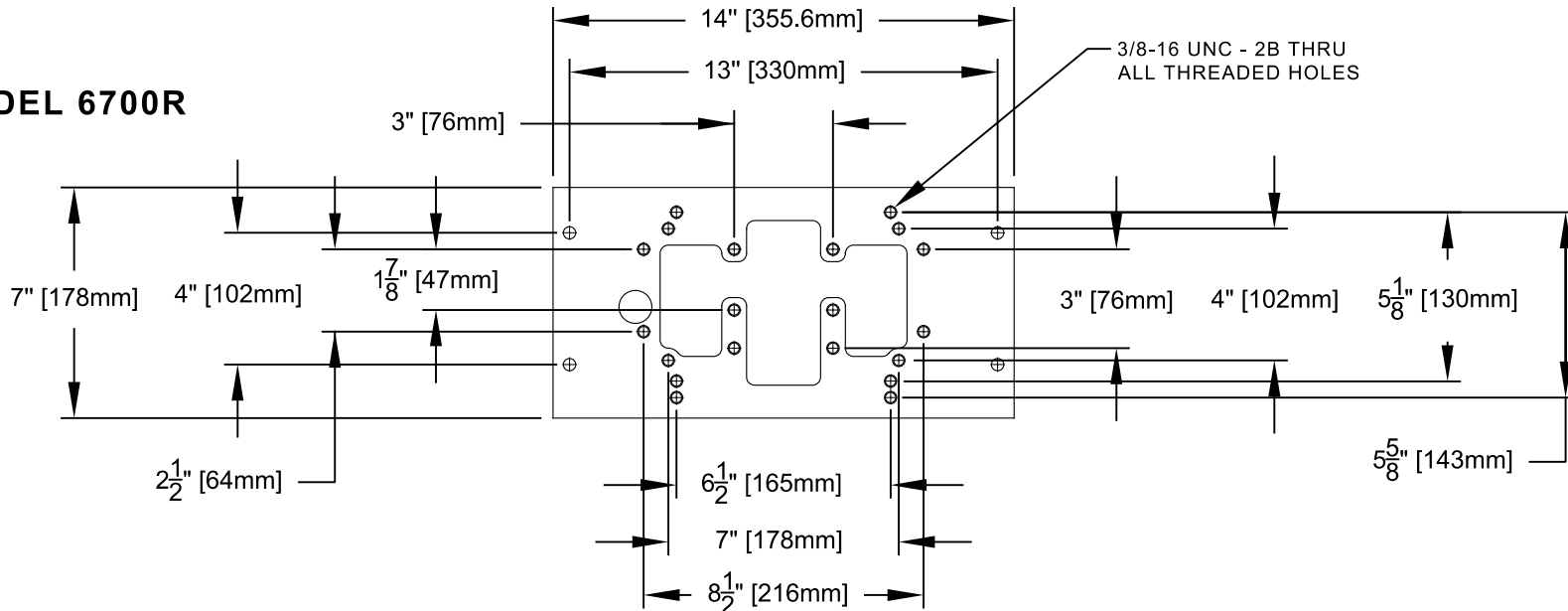

NOTES:

1. WHEN INSTALLING THIS UNIT, LOCAL, STATE OR FEDERAL CODES SHOULD BE ADHERED TO.
2. FOR CONCRETE/MASONRY WALLS, DO NOT INSTALL THE MOUNTING PLATE ON THE SAME SIDE OF WALL AS FOUNTAIN/BOTTLE FILLER. CALL TECHNICAL SUPPORT IF THERE ARE ANY QUESTIONS AS TO HOW TO OBTAIN A PROPER ANCHOR IN CONCRETE/MASONRY WALL. 1-800-766-5612



1455 KLEPPE LANE
SPARKS, NEVADA 89431
(775) 359-4712 FAX (775) 359-7424
E-MAIL: HAWS@HAWS.CO.COM
WEBSITE: WWW.HAWS.CO.COM

ECN NO. 5081	REVISED PER ECN: 6005	BY: FV	MODEL(S) 6700R	PART NUMBER 0510000492
DRAWN: MJ	DATE: 06/27/16	CHK'D: KM		REVISION 4
APPROVED: FV	DATE: 02/26/24	SCALE: 1:1	DRAWING TYPE: INSTALLATION	SIZE: A SHEET 1 OF 1